

This Package Contains

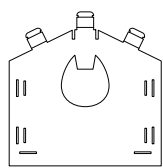

A

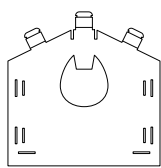

B

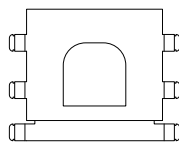

C

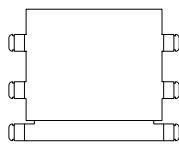

D

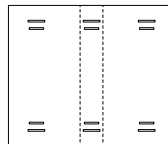

E

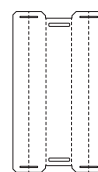

F

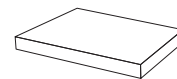

G

Completed Item

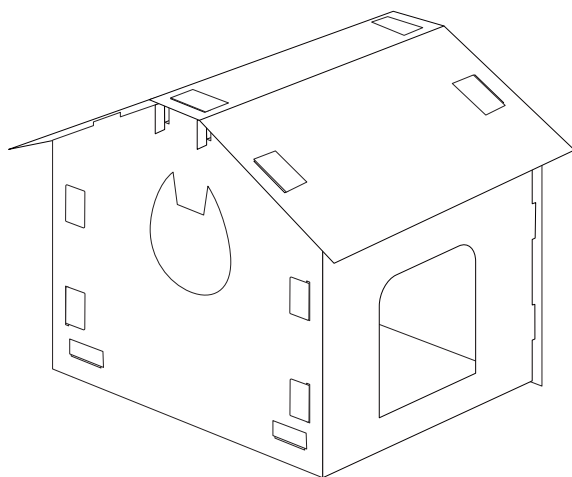

Step 1

Assemble **Panels (A), (B), (C), and (D)** as shown below. Insert the tabs of **Panels (D)** and **(C)** through the large outer slots in **Panels (A)** and **(B)**.

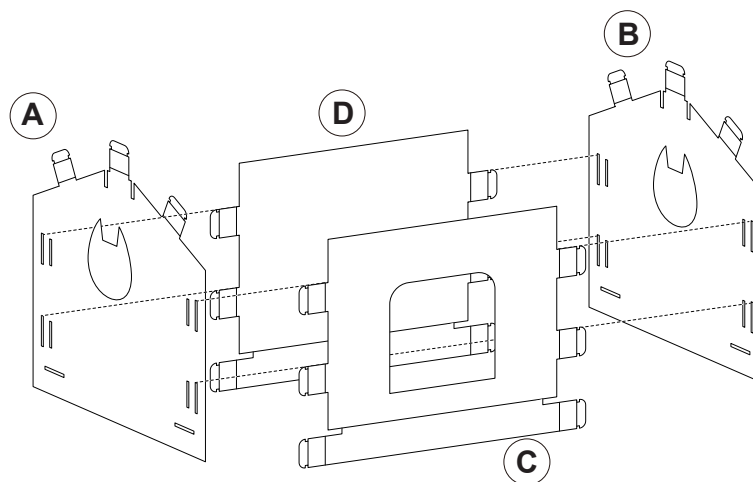

Step 2

Fully insert the tabs into **Panels (A)** and **(B)**, then wrap the tabs around and insert them into the small slots as shown below. Repeat on the back side.

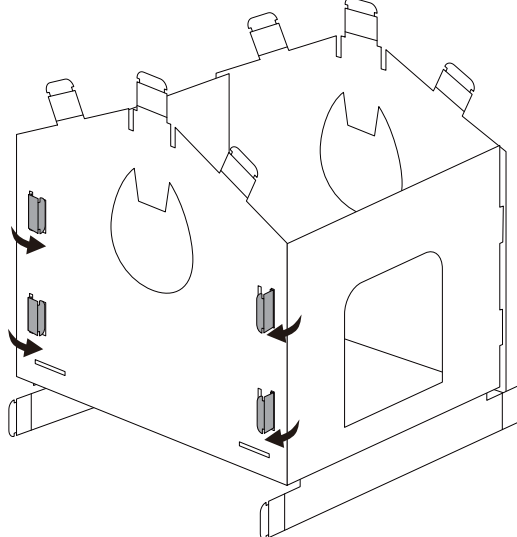
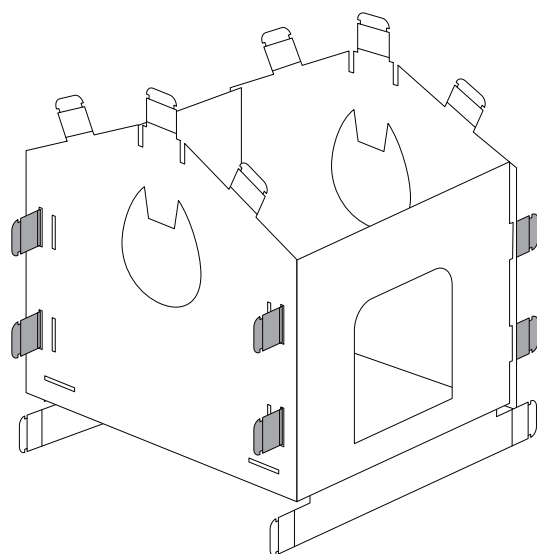

Line up tab with large outer slot.

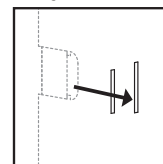

Push completely through.

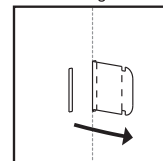

Fold front and insert tab into small slot.

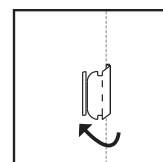

Step 3

Fold **Platform (F)**, and while pinching it together tightly, insert it into the slots on top of the assembled panels, as shown.

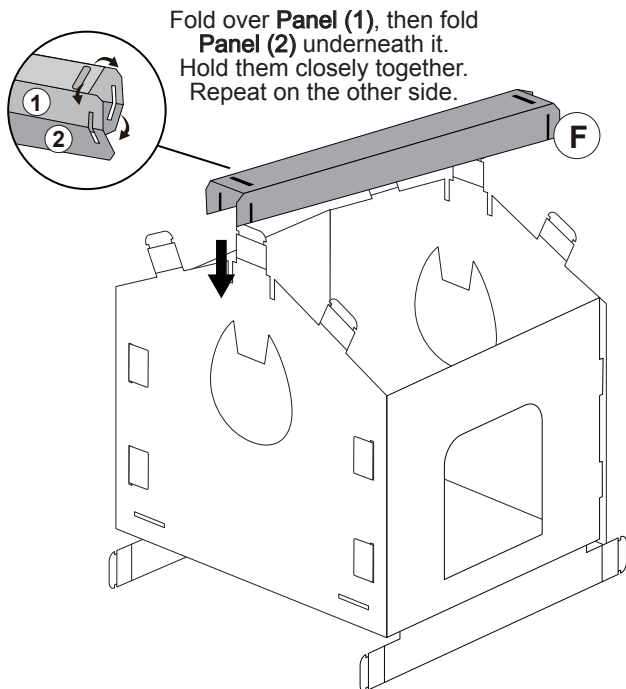

Step 4

Pre-bend the roof panel along guidelines. Attach **Roof (E)** to the completed panels.

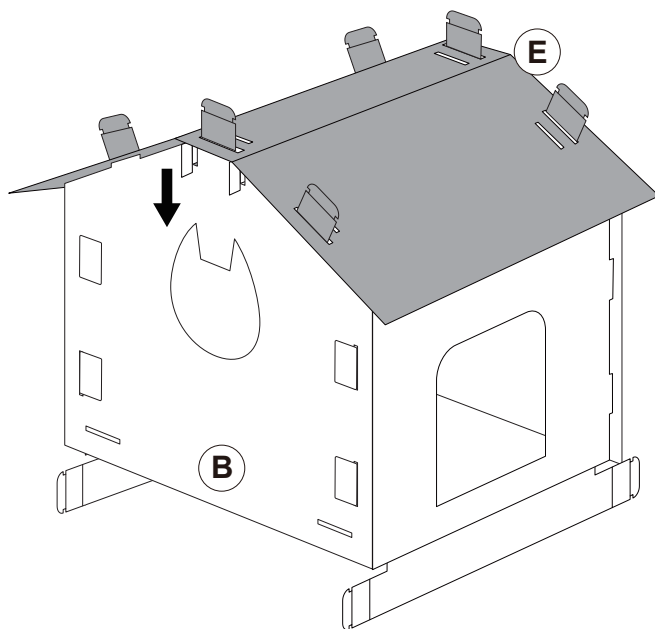

Step 5

Place the combined panels over **Scratcher (G)**.

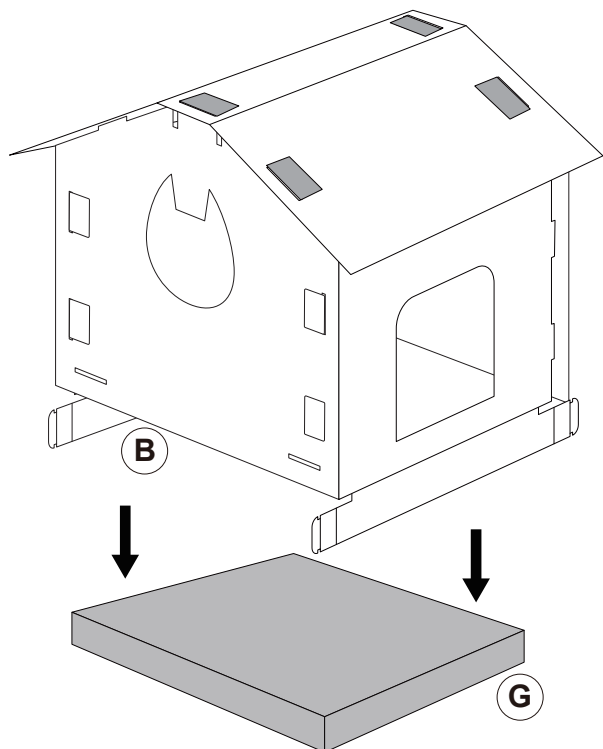

Step 6

Fold the bottom flaps of **Panels (C) and (D)** under **Scratcher (G)**. Fold the front and back tabs up, and insert them into the slots of the completed panels, as shown below.

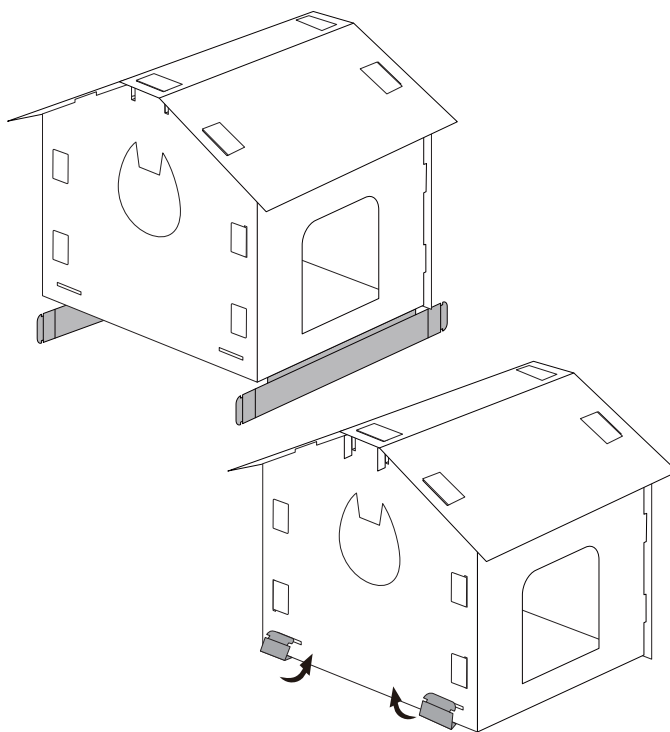

Because every cat is different, it is important to monitor your cat's behavior with this product. If at any time your cat damages this item, or any portion of this item becomes damaged, remove the damaged portion or discontinue use of the product.

QUESTIONS?

Call our friendly customer service team any time. We're here 24/7! 1-800-67-CHEWY (672-4399)