



Installation in:

Wooden Doors
Plastic Doors
Plasterboard Walls

Tools you will need:

Blu Tack
Crosshead Screwdriver
Drill
Jigsaw
Sharpened Pencil
Spirit Level
Ruler

DIY installation may involve the use of power tools or cut glass. Safety equipment (gloves, eye protection, etc.) should be used and if in doubt consult a professional to carry out the installation.

Suitable Door Types

Instructions are provided for installation in all door types, including wooden, plastic, glass and metal. Before installing in a door with unknown construction, please check for a metal plate in case a larger hole is required, as described in the metal door installation section.

If you can only be sure of the construction of the door by drilling a hole in it, make a trial hole anywhere covered by the proposed hole for the SureFlap Microchip Cat Door.

Note: a simple test for the presence of a steel plate in the door is with a magnet. If the magnet is attracted to the door then there is a steel plate within, and you must follow the instructions for mounting in a metal door. However, even if a magnet is not attracted to the door, still check for the presence of other metals, such as aluminium, which require the same mounting conditions.

Cat Door Positioning

The ideal height of the SureFlap Microchip Cat Door is such that the base of the tunnel is the same height above the ground as your cat's stomach. In practice however, mounting is normally dictated by features in the door into which the unit will be installed. In these circumstances, it is usual to mount the cat door as low as possible.

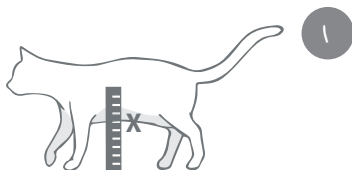

Measure the height of your pet's stomach from the floor when your pet is standing. This height is the level at which the bottom of the hole should be cut through the wall. Make a mark on the door at this height. Note: If there is a large drop on the outside of the house you will need to place a step outside for your pet to access the tunnel.



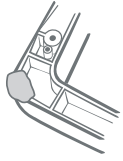

- 2 Place the external frame face down. Attach a ball of Blu Tack (or similar adhesive putty) in each of the four corners. This should allow you to stick the frame to most doors.

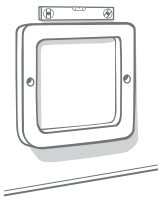

- 3 Choose the position on the door at which you want to mount the cat door and stick the frame to the door. To ensure that it is level, we recommend you use a spirit level.

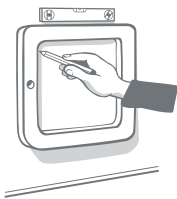

- 4 Use a sharpened pencil or pen to mark where the inside of the frame touches the door as well as the two screw holes. You need to make a legible line as this will be used for cutting against.

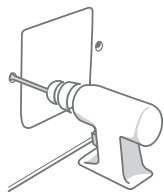

- 5 Remove the frame from the door and check you have a solid line and dots where the screw holes are. Using a drill with a 6mm (0.25") diameter bit, drill the two holes for the screws. It is vital these holes are drilled straight to ensure the two halves of the cat door connect properly.

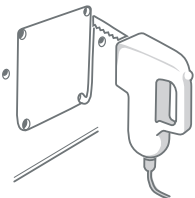

- 6 Before you cut out the hole for the tunnel, drill holes in all the corners large enough to allow your jigsaw blade through. Cut out the tunnel hole with an electric jigsaw. Ensure you cut 3mm (0.125") outside the line you have marked for the hole to allow enough clearance for the tunnel. Make sure that your jigsaw is sitting flat on the door at all times while cutting.



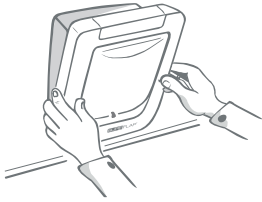

7

Clean off any loose debris, dust and dirt from the door before you install the SureFlap Microchip Cat Door.

8

Mount the cat door in the hole with the main assembly (battery cover) inside the house.

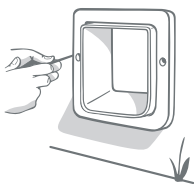

9

Mount the external frame on the **outside of the house**. Depending on the thickness of the door, the tunnel will protrude through the frame by differing amounts. **Under no circumstances should you cut or drill through the tunnel as this contains the microchip reader and will prevent the unit from working.** Three different lengths of screw have been provided for your use. Choose the correct screw length to suit the thickness of your door. If you are not sure, use the smallest first. If this is too short use the next size up. Take care not to use a longer screw than needed, as this may damage the main assembly front face. Screw the external frame to the main assembly.

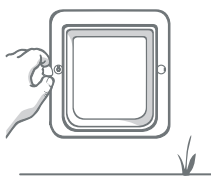
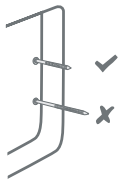

10

When the cat door has been mounted correctly, place the screw caps over the screw holes on the external frame. Align the screw caps with the slot pointing inwards and push firmly into place. To remove the screw caps, slide a flat blade screwdriver into the side slot and lever the cap out of the hole.

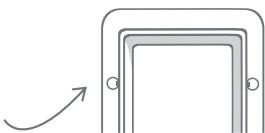

Installation in Metal Doors

The presence of a metal plate in a door can influence the performance of the SureFlap Microchip Cat Door, reducing the range of the microchip reader. This includes the following:

- Metal skin doors
- Security doors
- Metal garage doors
- UPVC coated metal doors

For most situations you will not notice anything, as the read range will still be sufficient for the majority of microchips. However, if you experience intermittent operation or failure to open for your cat, first check for the presence of a metal plate in the door.

Note: UPVC coated metal doors often look the same as standard UPVC doors and you may need to look carefully where the panel has been cut. If a metal plate is confirmed, follow the instructions below for improved read range. Improved installation in metal doors requires the mounting adaptor. For details of where to purchase this adaptor see our website www.sureflap.com.

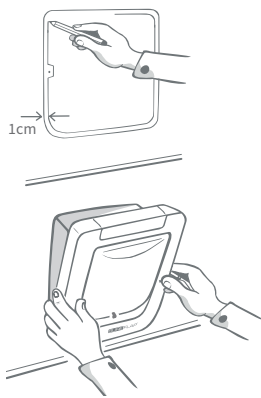

If there is metal present you will need to cut a larger hole in your door, leaving a gap of 2-3cm (1-1.2") between the tunnel of the cat door and the metal in your door. To begin with, trace around the outer edge of the back frame as a size guide. Now mark your cutting line 1cm (0.3") inside the line you have traced around the back frame, leaving the screw holes in place. Cut this hole and reinstall the cat door.

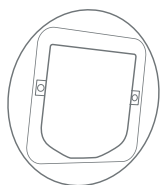

If you still experience intermittent operation you will need to increase the size of the hole again, in this case you will require the cat door mounting adaptor. For details of where to purchase this adaptor see our website www.sureflap.com.

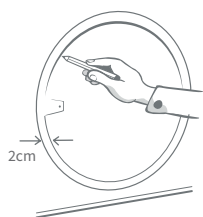

First trace around the circumference of the mounting adaptor as a guide. Now mark a circle approximately 2cm (0.8") inside the line from the mounting adaptor, again leaving the indentations for the screw holes. Cut this hole and then reinstall the cat door again. This will extend the read range further and should resolve any issues with mounting in a metal door.





Installation in:

Glass Doors
Windows

Tools you will need:

All Weather Sealant
Crosshead Screwdriver
Spirit Level

DIY installation may involve the use of power tools or cut glass. Safety equipment (gloves, eye protection, etc.) should be used and if in doubt consult a professional to carry out the installation.

The SureFlap Microchip Cat Door is ideal for mounting in single or double glazed windows. If you need to have a hole cut in a window, please ask a qualified glazier to do it, as cutting glass is a skilled job. If you need to get a hole cut in your window, a circular hole with a diameter of 212mm (8.5") is the ideal size. A mounting adaptor is available to complete an installation in glass, and is suitable for covering holes from 210mm (8.5") to 260mm (10.25") in diameter.

For details of where to purchase this adaptor see our website at www.sureflap.com.

If you have a double glazed window, you will need to get a replacement unit manufactured with the hole cut in it. Once your glass has been cut and installed in the door or window you are ready to complete the installation.

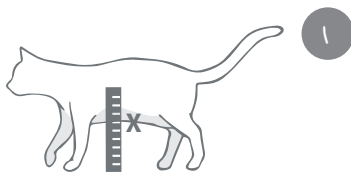

Measure the height of your pet's stomach from the floor when your pet is standing. This height is the level at which the bottom of the hole should be cut through the glass. Make a mark on the glass at this height. Note: If there is a large drop on the outside of the house you will need to place a step outside for your pet to access the tunnel.

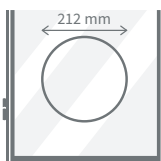

A circular hole 212mm (8.5") in diameter is required to accommodate the tunnel.



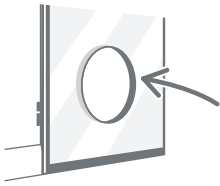

3 If installing the SureFlap Microchip Cat Door in a double glazed panel your glazier will seal between the panels around the circular hole to avoid moisture collecting inside. Do not use metal in any such seal.

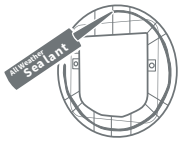

4 We recommend running a bead of 'All Weather Sealant' around the edge of the hole on both sides of the glass. The sealant will help secure the cat door in place after installation, particularly with larger hole sizes, and also help prevent moisture getting in from outside. This type of sealant can be purchased from a glazing company and most DIY stores.

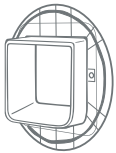

5 Slide one of the mounting adaptor rings over the main assembly.

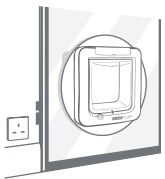

6 From the inside of the house, slide the tunnel of the main assembly through the hole in the glass.

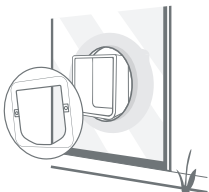

7 From the outside, mount the second part of the mounting adaptor and then the external frame. When working with cut glass always wear protective gloves as the edges may be sharp.

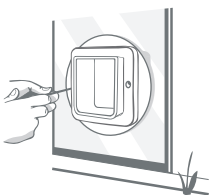

8 Screw the two halves together. If mounting in a single pane, use the shortest of the three pairs of screws. A double glazed panel may require the mid-sized screw, depending on its thickness. Check the assembly is centred with the circular hole before fully tightening the screws.

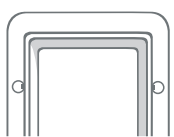

9 Align the white screw caps with the slot pointing inwards and then push firmly into place.

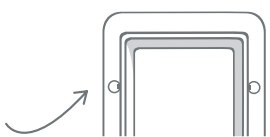

10 From the inside of the house you will now see your cat's stylish new entrance.





Installation in:

Walls

Tools you will need:

All Weather Tape

All Weather Sealant

Blu Tack

Masonry Drill

Masking Tape

Sharpened Pencil

Spirit Level

Ruler

DIY installation may involve the use of power tools or cut glass. Safety equipment (gloves, eye protection, etc.) should be used and if in doubt consult a professional to carry out the installation.

When you are making holes through the wall of your property please consult a qualified builder.

Note: When planning the installation of a SureFlap Microchip Cat Door in a wall, remember that you may need to remove the cat door in the future if you move house or upgrade to a newer model. With this in mind do not glue the main assembly of the unit to the wall, as removing it will be difficult and could damage the surface of your wall.

For installation of the SureFlap Microchip Cat Door in a wall we recommend using the following accessories:

SureFlap Cat Door Mounting Adaptor

SureFlap Cat Door Tunnel Extender

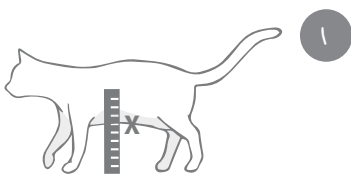

Measure the height of your pet's stomach from the floor when your pet is standing. This height is the level at which the bottom of the hole should be cut through the wall. Make a mark on the wall at this height. Note: If there is a large drop on the outside of the house you will need to place a step outside for your pet to access the tunnel.



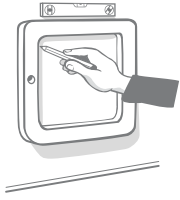

2 Choose your mounting position on the wall so that your cat has easy access through the door and into the tunnel from outside.

3 Mark a 170mm x 170mm (6.7" x 6.7") square on the wall at the position of the tunnel.

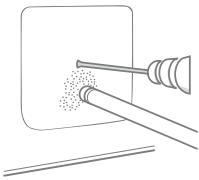

4 Make a hole through the wall using appropriate tools and ensure that the tunnel is horizontal. A slight slope downwards from the inside of the house to the outside will ensure any rain runs out of the tunnel.



5 Apply superglue to the four tabs of the tunnel extender and fit the tunnel extenders together. When the glue has dried, apply weatherproof tape to the outside of the tunnel.

6 Follow step 5 to bond all of the tunnel extenders together – *Remember, do not glue the tunnel extender to the tunnel of the cat door. Just use tape for this joint when you come to it.*

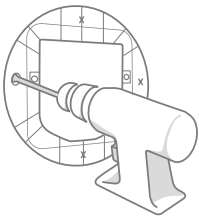

7 Take one of the mounting adaptors and drill four holes in it using a 4mm (0.15") drill bit. These four holes are for the screws that will hold the cat door to the inside wall of your house. You can put the four screws where you like around the perimeter of the mounting adaptor.

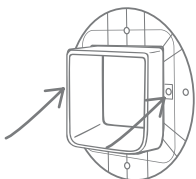

8 Now take the two shortest screws from the box and using a washer, screw the mounting adaptor to the cat door.



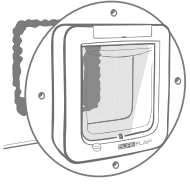

9 Place the cat door (with the mounting adaptor) in the hole in your wall on the inside of your house.

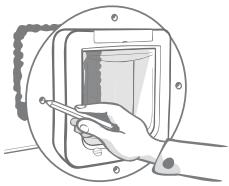

10 Mark the positions for the four screws through the holes you have made in the mounting adaptor. You will also need to remove some material from the wall to allow for the screw and washer which hold the mounting adaptor to the main assembly. This will ensure that the mounting adaptor fits flush with the wall.

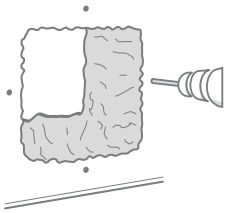

11 Drill the four holes in your wall using an appropriate drill bit to suit the construction of your wall and your chosen screws.

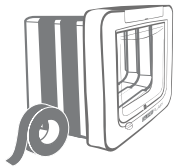

12 Tape the tunnel extender to the end of the cat door's tunnel.

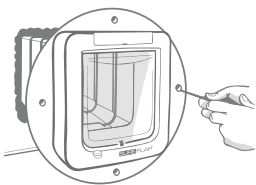

13 Place the cat door and the tunnel through the hole in your wall and screw it in place using the four screws through the mounting adaptor.



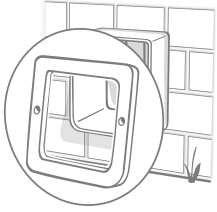

- 14 On the outside of your house, you will now have the tunnel sticking out of the wall. Take the external frame and other mounting adaptor and place these over the end of the tunnel.

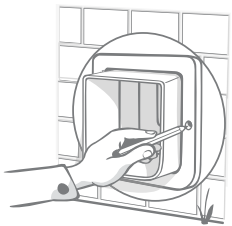

- 15 Mark the position of the two screw holes required to mount the external frame and then drill appropriate holes in the wall.

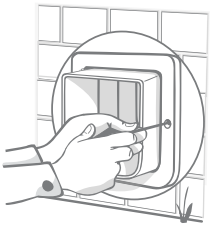

- 16 Screw the external frame and mounting adaptor to your external wall.



- 17 To hold the end tunnel extender in position, we recommend using small screws to secure the tunnel extender to the external frame.



- 18 We recommend putting some waterproof sealant between the tunnel and the external frame to prevent water getting into the wall cavity.

