

Thank you for choosing Tiger Tough™ for your pet! Our products are manufactured of high quality materials and feature natural sisal fibers. Sisal textiles are durable, economical and biodegradable. They are also an excellent surface for scratching!

Assembly Instructions

- A. Product must be assembled **vertically beginning with the base and building up**. Do not assemble lying down as damage may occur to unit when righting and hardware may not be secure for use.
- B. Assemble product on a flat, stable surface using the tools provided. Before beginning, please verify all parts against the parts lists. Tighten all connections as you build until they are firm. Do not overtighten.
1. Beginning with Base 1, attach Posts 8, 9, 11 & 12 to the base using Screw A & Washer C. Attach Platform 2 to Post 8 with Screw A. Then attach Post 10 and Platform 2 to Post 9 using Dowel Screw B. Place Dowel Screw Bs in tops of Posts 10, 11 and 12. **CAUTION: Do no overtighten the Dowel Screw B in Post 11. This screw will thread through two platforms during assembly.**
2. Align holes in Platform 3 with dowel ends in Posts 10, 11 and 12. Using exposed dowel screw ends, attach Post 13 to Post 12. Attach Post 15 to Post 10.
3. Assemble House using Posts 14, Bottom Board 4 (with plush side facing up) and Top Board 4 (no plush). Place a Dowel screw in the top of the back corner Post 14. Cover frame with House Cover 21 carefully aligning back corner Post 14 dowel screw with small screw opening in cover.
4. Attach assembled house to playground by aligning back corner Post 14 to the exposed dowel screw end in Post 11. Reach inside the house and turn back corner Post 14 to tighten. Then use Short Screw D to attach the base of the House (Platform 4) to the top of Platform 3.
- Attach Post 20 to back corner Post 14 dowel screw end. Insert an additional dowel screw to the top of Post 20. Align Platform 5 with Posts 13, 15 and 20. Secure Post 13 with Screw A. Attach Post 16 to Post 15. Attach Post 17 to Post 20. Attach Spring-y Ball Wand Toy 19 to Platform 5 in the provided small lag bolt end.
5. Secure Platform 6 to Post 16 with Screw A. Attach Post 18 and Platform 6 to Post 17 using Dowel Screw B.
6. Screw Top Platform 7 onto Post 18.

Care Instructions

- Periodically inspect unit and tighten as needed.
- Spot clean as needed with gentle detergent diluted with water. Towel & air dry.

Hints & Tips

- Because it is a natural fiber, it is normal for sisal to discolor over time.
- Exposure to direct sunlight or moist conditions may damage the unit.
- For greater stability, place the playground in an area where it will not be bumped.
- Never let children or larger animals play on or climb the playground unit. This is extremely unsafe and may lead to damage or harm.
- Not recommended for outdoor use.
- Keep tools and instructions for future use and reference.

Problems or Questions?

Please contact FurHaven Customer Service at 1.888.459.2337 or via email at service@furtherhaven.com. Monday through Friday ~ 7:30 am to 4:00 pm

97600 Series
2018

Tiger Tough™
FOR CATS AT PLAY™

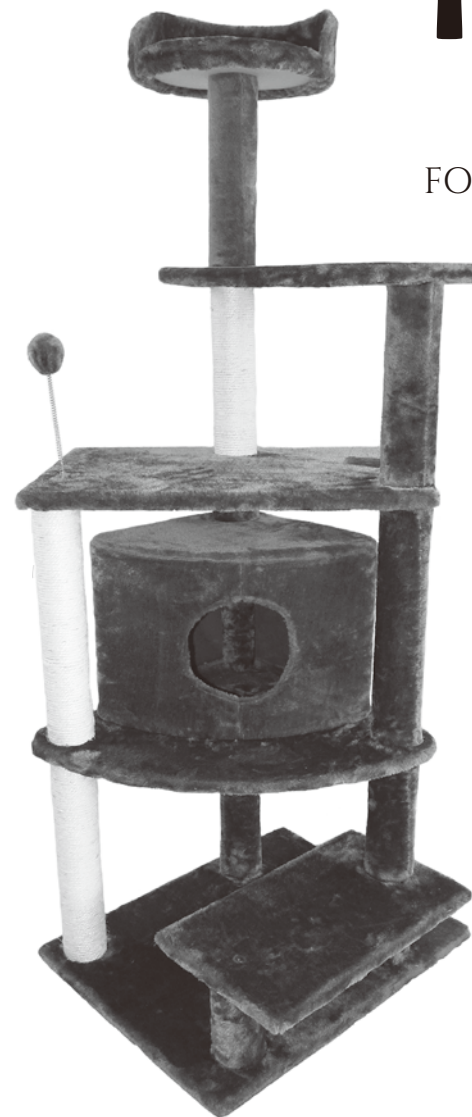

Platform House Playground

59.8" x 23.6" x 19.3"
(152 x 60 x 49 cm)

FurHaven Pet™ Products
Bellingham, Washington USA

Thank you for choosing Tiger Tough™ for your pet!
For questions and inquiries, please contact FurHaven Customer Service at
1.888.459.2337 or via email at service@furtherhaven.com

ASSEMBLY INSTRUCTIONS

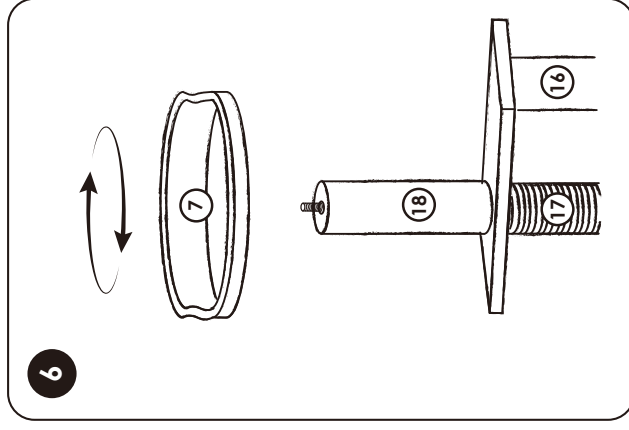
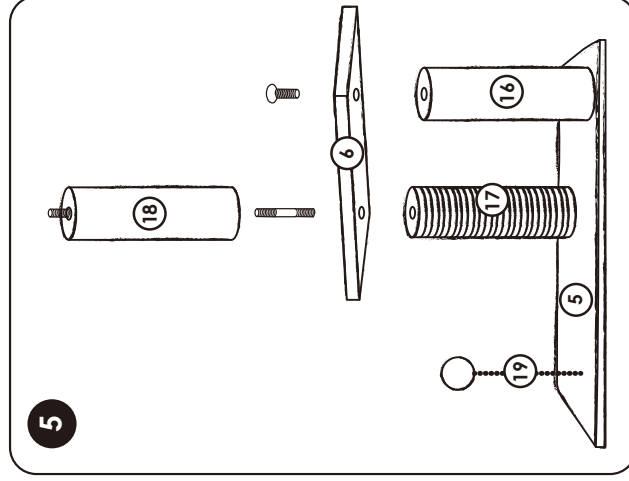
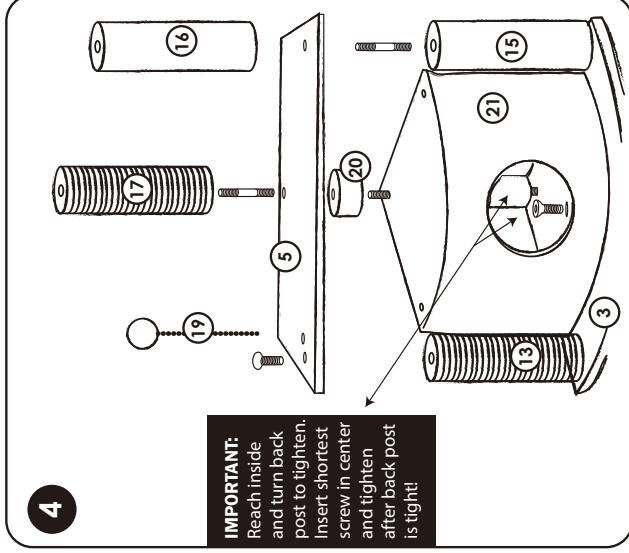
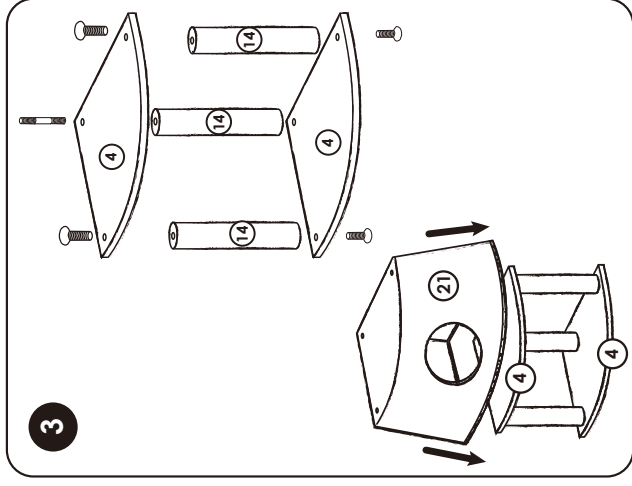
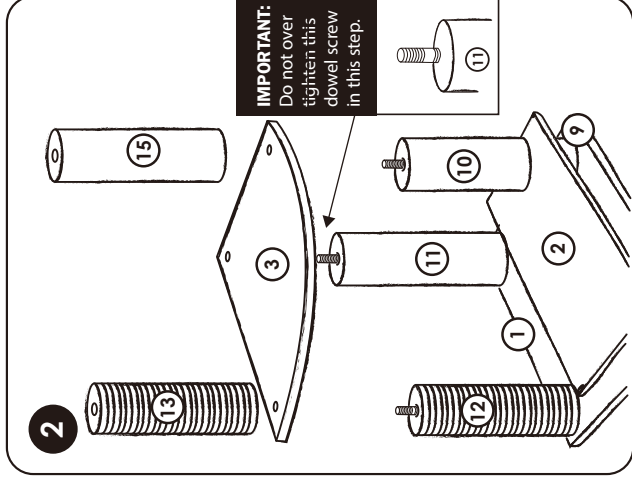
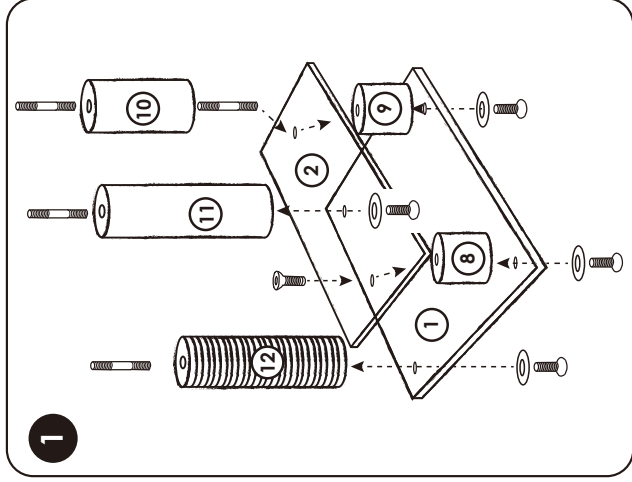

PARTS HARDWARE:

