

To use the pull handle, release the locks near the carrying handles and swing the pull handle up and over to the front of the carrier.



DISASSEMBLING THE CARRIER:

Release the Assembly Buckles by pushing the yellow buttons to allow Buckles to disengage. As you lift up on the Carrier Top, remove the Door and completely remove the Carrier Top. The Door and Carrier Top can be nested inside the Carrier Bottom for storage.



LIMITED MANUFACTURERS WARRANTY

- For one (1) year from the date of original purchase, MIDWEST Homes For Pets ("MIDWEST") warrants to the purchaser of this Skudo Travel Carrier that, should it prove defective by reason of improper workmanship and/or material, MIDWEST will repair or replace, at its option, any defective part of the Skudo Travel Carrier, without charge for the part or for shipping. Replacement parts are warranted for the remainder of the original period.
- THIS WARRANTY DOES NOT COVER** defects in the furniture caused by any animal, any physical abuse to or misuse of the pet cage, any damage caused by the original purchaser or any third party, or any defects arising or discovered more than one (1) year from the original retail purchase date.
- STEPS TO OBTAIN WARRANTY SERVICE:**
 - The purchaser must call MIDWEST's HELPLINE, 800-428-8560, to report the alleged defect to a customer service representative or obtain missing parts.
 - The customer service representative will determine if the defect is covered by this warranty, and if it is, will authorize and instruct the purchaser in how to obtain corrective action.
 - MIDWEST may require the purchaser to present the sales receipt or other proof of purchase prior to authorizing any return or replacement. No returns or replacements will be permitted without proper authorization. If a return or replacement is authorized, you may be requested to return the item to MIDWEST or to make the item available for pick-up by MIDWEST.
- ANY EXPRESS WARRANTY NOT PROVIDED IN THIS WARRANTY DOCUMENT, AND ANY REMEDY FOR BREACH OF CONTRACT THAT, BUT FOR THIS PROVISION, MIGHT ARISE BY IMPLICATION OR OPERATION OF LAW, IS HEREBY EXCLUDED AND DISCLAIMED. THE IMPLIED WARRANTIES OF MERCHANTABILITY AND OF FITNESS FOR ANY PARTICULAR PURPOSE ARE EXPRESSLY LIMITED TO A TERM OF ONE (1) YEAR. SOME STATES DO NOT ALLOW LIMITATIONS ON HOW LONG AN IMPLIED WARRANTY LASTS, SO THE ABOVE LIMITATIONS MAY NOT APPLY TO YOU.**
- UNDER NO CIRCUMSTANCES SHALL MIDWEST BE LIABLE TO PURCHASER OR ANY OTHER PERSON OR ANY SPECIAL, INCIDENTAL OR CONSEQUENTIAL DAMAGES, WHETHER ARISING OUT OF BREACH OF WARRANTY, BREACH OF CONTRACT OR OTHERWISE, SOME STATES DO NOT ALLOW THE EXCLUSION OR LIMITATIONS OF INCIDENTAL OR CONSEQUENTIAL DAMAGES, SO THE ABOVE LIMITATIONS OR EXCLUSION MAY NOT APPLY TO YOU.**
- This warranty gives you specific legal rights, and you may also have other rights which vary from state to state.

For a Complete Listing of Products

Crates • Pet Beds
Crate Casters • Ex Pens • Kennels ...

— Come Visit Our Website



Skudo Travel Carrier Large INST (146)

Skudo

800-428-8560
midwesthomes4pets.com
P.O. Box 1031
Muncie, Indiana 47308



Assembly Instructions for Models 1427TSG, 1432TSG, 1436TSG

IMPORTANT INFORMATION

This carrier is intended for well-trained pets. Supervision required. Remove collar, tags and leads from pet before placing it in the carrier to prevent possible entanglement. Contains small parts. Keep out of reach of children.

Approved for use on most major airlines. It is recommended that you check with the airline for specifications prior to booking.

Unwrap and remove all parts from packaging. Keep all packaging material until the product is assembled. In case of return or exchange, failure to return product in similar condition as received could result in limited reimbursement. Please save sales receipt as proof of purchase for warranty purposes. Check to ensure you have all the parts below. If you discover any parts are missing, immediately call our toll-free service helpline at 1-800-428-8560 (Monday - Friday 9 a.m. to 4 p.m. EST) or at info@midwesthomes4pets.com. **To protect the finish of your travel carrier use only mild, non-abrasive cleaners and water. Any course scrubbing or abrasive materials could damage the plastic.**

PARTS IDENTIFICATION

- Carrier Bottom (1)
- Carrier Top (1)
- Door with Spring Loaded Latch (1)
- Assembly Buckles with Yellow Buckle Hinges (Pre-assembled): 5 with the 27" and 32" carriers; 9 with the 36" carrier.
- Storage Compartment Lid(s): 2 come pre-attached on the 32" and 36" carriers; 1 comes unattached on the 27" carrier
- Locking Door Hinges (2 Left, 2 Right)

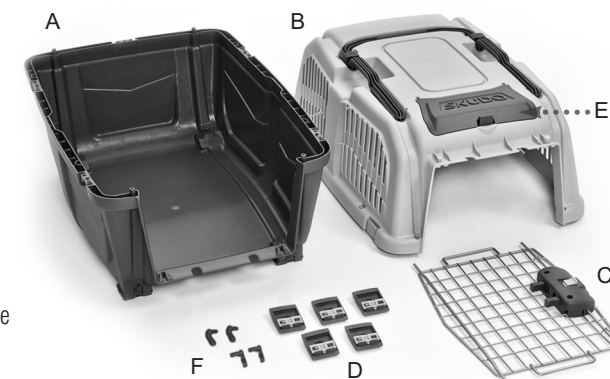

NOTE: Optional rolling casters sold separately. Visit the Skudo page on midwesthomes4pets.com for information on where to buy.



Watch the Skudo Travel Carrier Assembly Video!
Scan the QR code or visit
midwesthomes4pets.com/services/skudo-travel-carrier-large

ASSEMBLY INSTRUCTIONS

1. Attach the Locking Door Hinges to the Carrier Bottom and Carrier Top **exactly as shown**. Be sure to attach the hinges correctly, as removal is difficult once they are installed.

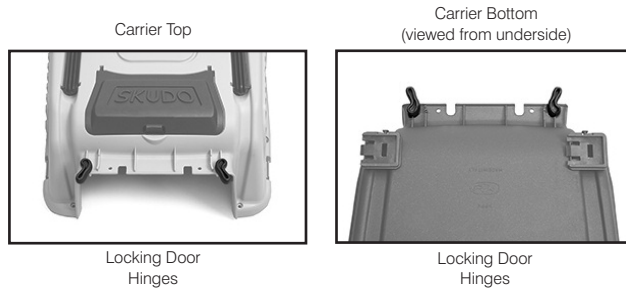

2. Attach the Storage Compartment Lid on the 27" carrier. (These are pre-attached on the 32" and 36" carriers.)

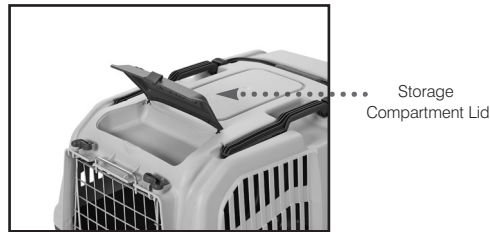

3. Set the Carrier Bottom on a flat surface and attach the Assembly Buckles. The Yellow Buckle Hinges will snap into place on the spaces provided on the Carrier Bottom; keep the Assembly Buckle and Yellow Buckle Hinge in a "V" formation while attaching for easiest application.

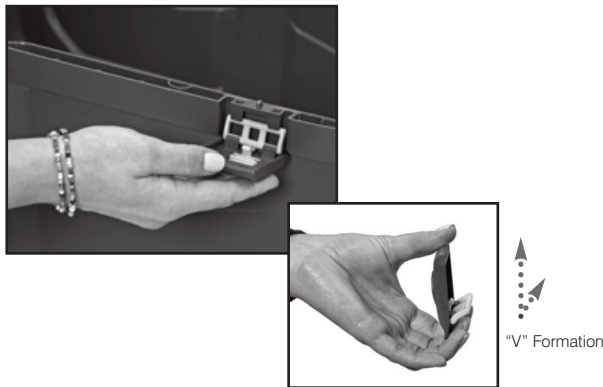

4. Place the Carrier Top on the Carrier Bottom. Before locking the Buckles, attach the Door by placing the bottom door prong into the hole on the left side of the Carrier Bottom. Lift up on the Carrier Top to insert the top door prong into the Carrier Top. Lower the Carrier Top so it rests on the Carrier Bottom, then secure them together by locking the Assembly Buckles.



Traditional Right-to-Left door installation. See CARRIER OPTIONS on Page 3 for alternatives.

NOTE: The assembled carrier has multiple tie-down locations in the corners for use with plastic ties. This is recommended for air travel.

5. To Operate the Door, squeeze the tabs to disengage the spring-loaded prongs, then swing the door open. Push the orange tab to lock.



CARRIER OPTIONS:

You have the option to remove the door, creating an open, den-like environment for your dog to enter and exit the carrier as he pleases. To do so, simply twist the Locking Door Hinges forward to release the door and remove it.



You also have the option to attach the door with the locking mechanism on the left, allowing the door to open left-to-right rather than right-to-left. While facing the front of the assembled carrier, twist the Locking Door Hinges toward you and re-install the door with the locking mechanism on the left. To secure the door in the carrier frame, twist the Locking Door Hinges inward toward the center of the carrier and into the locked position.



TO ATTACH OPTIONAL CASTERS:

****Sold Separately.** Visit the Skudo page on midwesthomes4pets.com for information on where to buy.

Turn the carrier upside down and push the tabs on the carrier feet. This will release the caster mounts. Slide the casters into the caster mounts, then re-attach the caster mounts to the Carrier Bottom.

