

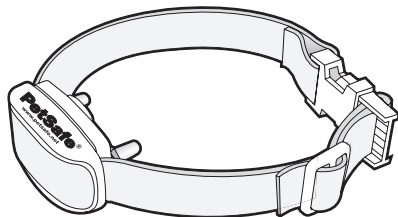

protect. **teach. love.**

pawz away[®]
threshold
pet barrier
operating and training guide



Model Number
PWF00-14406

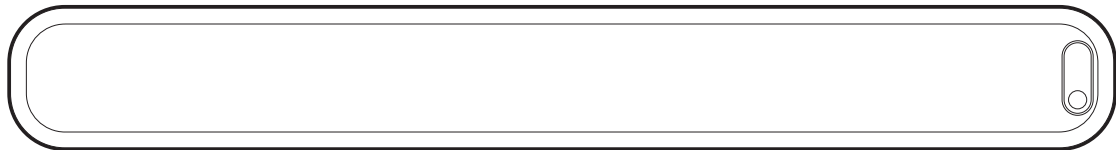

PLEASE READ THIS ENTIRE GUIDE BEFORE BEGINNING

Important Safety Information

Explanation of Attention Words and Symbols used in this guide



This is the safety alert symbol. It is used to alert you to potential personal injury hazards. Obey all safety messages that follow this symbol to avoid possible injury or death.

⚠ WARNING

WARNING indicates a hazardous situation which, if not avoided, could result in death or serious injury.

⚠ CAUTION

CAUTION, used with the safety alert symbol, indicates a hazardous situation which, if not avoided, could result in minor or moderate injury.

CAUTION

CAUTION, used without the safety alert symbol, indicates a hazardous situation which, if not avoided, could result in harm to your pet.

NOTICE

NOTICE is used to address safe use practices not related to personal injury.

⚠ WARNING

Not for use with aggressive dogs. Do not use this product if your dog is prone to aggressive behavior. Aggressive dogs can cause severe injury or death to their owners and others. If you are not sure that this product is right for your dog, please talk to your veterinarian or a certified trainer.

⚠ CAUTION

- Use caution when placing Threshold Transmitter in doorway- can be trip hazard.
- Do not place Threshold Transmitter on stair step due to tripping hazard.

CAUTION

This System is NOT a solid barrier. The system is designed to act as a deterrent, using Static Correction to condition pets to remain outside of the established barrier area. It is important that you reinforce training with your pet on a regular basis. Since the tolerance level to Static Correction varies from pet to pet, Radio Systems® Corporation CANNOT guarantee that the system will in all cases keep a pet outside of the established barrier area. Not all pets can be trained to avoid entering the barrier area. Therefore, if you have reason to believe that your pet may harm himself or pose a danger to others if he is not kept from entering the barrier area, you should NOT rely solely upon this system to restrict your pet. Radio Systems® Corporation shall NOT be liable for any personal injuries, property damage, injury to or death of your pet, economic loss or any consequential damages sustained as a result of any animal entering the barrier area.

CAUTION

Proper fit of the collar is important. A collar worn for too long or made too tight on the pet's neck may cause skin damage. Ranging from redness to pressure ulcers; this condition is commonly known as bed sores.

- Avoid leaving the collar on the pet for more than 12 hours per day.
- When possible reposition the collar on the pet's neck every 1 to 2 hours.
- Check the fit to prevent excessive pressure; follow the instructions in this manual.
- Never connect a lead to the electronic collar; it will cause excessive pressure on the contacts.
- When using a separate collar for a lead, don't put pressure on the electronic collar.
- Wash the pet's neck area and the contacts of the collar weekly with a damp cloth.
- Examine the contact area daily for signs of a rash or a sore.
- If a rash or sore is found, discontinue use of the collar until the skin has healed.
- If the condition persists beyond 48 hours, see your veterinarian.
- For additional information on bed sores and pressure necrosis, please visit our website.

These steps will help keep your pet secure and comfortable. Millions of pets are comfortable while they wear stainless steel contacts. Some pets are sensitive to contact pressure. You may find after some time that your pet is very tolerant of the collar. If so, you may relax some of these precautions. It is important to continue daily checks of the contact area. If redness or sores are found, discontinue use until the skin has fully healed.

You may need to trim the hair in the area of the Contact Points. Never shave the pet's neck; this may lead to a rash or infection.

- To prevent an unintended correction, do not perform set up procedures while the Receiver Collar is on your pet.
- If you are using a collar and leash for training, be sure the extra collar does not put pressure on the Contact Points of the Receiver Collar.
- For proper operation, the Receiver Collar maximum operating height is 36 inches from the Threshold Transmitter.

NOTICE

- To avoid damage to the Threshold Transmitter, do not use on wet surfaces, in damp or wet locations or around swimming pools. This product is designed for indoor use only. Do not expose to rain or snow.
- To avoid potential damage to your Threshold Transmitter, do not stand or step on Threshold Transmitter.

Thank you for choosing PetSafe® brand. You and your pet deserve a companionship that includes memorable moments and a shared understanding together. Our products provide you with the tools and technologies to successfully train your pet. If you have any questions about our products or training your pet, please visit our website at www.petsafe.net or contact our Customer Care Center at 1-800-732-2677.

To get the most protection out of your warranty, please register your product within 30 days at www.petsafe.net. By registering and keeping your receipt, you will enjoy the product's full warranty and should you ever need to call the Customer Care Center, we will be able to help you faster. Most importantly, we will never give or sell your valuable information to anyone. Complete warranty information is available online at www.petsafe.net.

Table of Contents

Components.....	7	Training Guide	18
Other Items You May Need	7	Begin Your Pet's First Session	18
Operating Guide	9	Further Training	19
Placement of the Threshold Transmitter	9	Troubleshooting	21
Set Up the Threshold Transmitter	10	Terms of Use and Limitation of Liability	22
Test the Barrier Area.....	11	Compliance	23
Fit the Receiver Collar on Your Pet	13	Customer Care International	24
To Re-Thread the Collar	15	Perchlorate Battery.....	24
Receiver Collar Batteries.....	16	Warranty	25
Additional Features	17		

Components

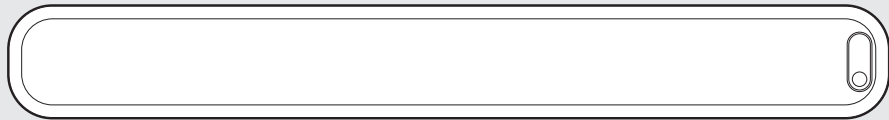

Threshold Transmitter
(4 AAA Batteries not included)

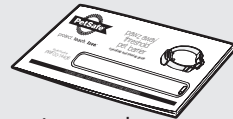

Operating and
Training Guide

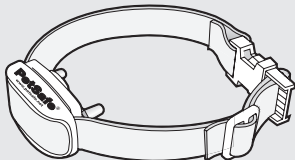

Receiver Collar



Mounting
Screws



Mounting
Anchors



Mounting
Strips



(2) 3-V Lithium
Batteries for
Receiver Collar



Mounting Template



Test Light Tool

Other Items You May Need

- Drill
- Screw Driver
- Non-metallic collar and leash
- Scissors
- Lighter

How the System Works

The PetSafe® Pawz Away® Threshold Pet Barrier keeps your pet from entering or leaving a certain room, from going up or down stairs, off of furniture, etc. Just place the Threshold Transmitter near the area your pet should avoid. The Threshold Pet Barrier transmits an adjustable elliptical radio signal. Your pet wears a Receiver Collar with Contact Points that touch his neck. When your pet enters the Barrier Area, he'll hear a series of audible tones from the Receiver Collar and he will feel a safe Progressive Static Correction, delivered through the Contact Points on his neck. The Progressive Static Correction will get his attention, but will not cause harm. The correction continues until your pet leaves the Barrier Area. If your pet doesn't leave, the collar will continue to correct at the maximum level from 2-3 seconds until the 13-15 second time-out. The PetSafe® Pawz Away® Threshold Pet Barrier has been proven safe, comfortable, and effective for pets at least 6 months old and 5 pounds or more.

Key Definitions

Threshold Transmitter: Transmits an adjustable range wireless radio signal.

Barrier Area: Area that you want to prevent your pet from gaining access.

Mode Button: Turns Threshold Transmitter ON/OFF and adjusts the range level setting.
Mode Switch, Standard Mode: Uses normal transmission rate for extended battery life.

Mode Switch, Training Mode: Uses higher transmission rate for faster response.

Receiver Collar: Receives the radio signal when located within the range setting of the Threshold Transmitter.

Contact Points: Deliver the safe Progressive Static Correction when your pet enters the Barrier Area.

Progressive Static Correction: Static Correction begins at the lowest level and automatically increases to maximum within 3 seconds of first detection in the Barrier Area in the Standard Mode or within 2 seconds in the Training Mode.

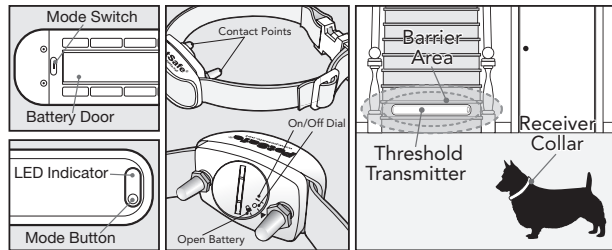

Operating Guide

Step 1 Placement of the Threshold Transmitter

The Threshold Transmitter emits a radio signal from all sides in an elliptical pattern. The signal may transmit through a wall or the ceiling/floor. The Threshold Transmitter can be placed laying flat on a surface or mounted on a stair riser or wall. If you choose to mount the Threshold Transmitter, note that the signal becomes very directional—the signal will be strongest directly above the unit. The signal is weakest to the side of the unit (1A).

⚠ CAUTION

- Use caution when placing Threshold Transmitter in doorway – can be trip hazard.
- Do not place Threshold Transmitter on stair step due to tripping hazard.

NOTICE

- To avoid damage to the Threshold Transmitter, do not use on wet surfaces, in damp or wet locations or around swimming pools. This product is designed for indoor use only. Do not expose to rain or snow.
- To avoid potential damage to your Threshold Transmitter, do not stand or step on Threshold Transmitter.

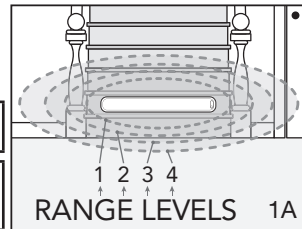

Do not:

- Mount unit on a metal wall
- Place Threshold Transmitter near large metal objects such as refrigerators, washers, etc.
- Place Threshold Transmitter on metal surfaces
- Place Threshold Transmitter near audio speakers
- Place within 8 feet of other Pawz Away Pet Barriers

Note: We do not recommend positioning the Threshold Transmitter vertically in the doorway or hallway. The performance will not be optimal. For collar activation, the collar might have to be closer to the Threshold Transmitter.

Step 2 Set Up the Threshold Transmitter

CAUTION To prevent an unintended correction, never perform set-up procedures while your pet is wearing the Receiver Collar.

1. Turn over the Threshold Transmitter and remove the battery door. Install four AAA alkaline batteries (2A) and replace the battery door.
2. Slide switch on back of Threshold Transmitter to Training Mode until your dog has learned his boundary.

Turning the Threshold Transmitter ON

Turn the Threshold Transmitter right side up. Press and hold the Mode Button until the Green LED indicator is ON. Release the button and the Green LED indicator turns OFF. The Red LED will then flash the Transmitter level setting between 1 and 4 times.

Turning the Threshold Transmitter OFF

Press and hold the Mode Button until the Green LED turns OFF.

Setting the Transmitter Levels

Momentarily press and release the Mode Button. The Green LED will flash when pressed. The current setting will flash Red. Press the Mode Button again within 5 seconds. The level will increase by 1 level. If the current level is 4 it will revert to level 1.

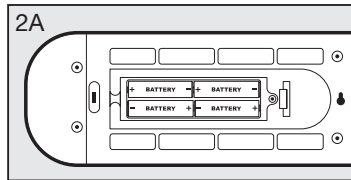

Test the Barrier Area

CAUTION For proper operation, the Receiver Collar maximum operating height is 36 inches from the Threshold Transmitter.

If you have more than 1 pet, set up the Threshold Pet Barrier for your tallest pet.

Place the Threshold Transmitter in the desired location. If planning to mount on a stair, lean it up against the back of the stair and test for proper operation before mounting. If using on stairs, set the system so that the Receiver Collar starts activating while your pet is still on the floor and not on the stairs.

1. Keeping your hands away from the Contact Points, use the edge of the Test Light Tool to turn the receiver battery door to the ON position.
2. Hold the Receiver Collar with the Contact Points facing up. Place the Test Light Tool on the Contact Points so that the wire in the Test Light Tool touches the Contact Points (3A). The PetSafe® logo on the Receiver Collar should face the Transmitter.
3. Hold the Receiver Collar at the approximate height of your pet's neck (3B). Start outside of the range and walk slowly toward the Threshold Transmitter. As you reach the Barrier Area, the Receiver Collar emits a series of high-pitched tones. For each tone you hear, you should notice the Test Light flashing which indicates that a Progressive Static Correction is being delivered. The Receiver Collar's tone is easily heard by pets but may be at a volume level difficult for some humans to hear.
4. Check the range of the Barrier Area from multiple angles to ensure you are getting the desired coverage. If the setting is too low, increase by 1 level and test. If the coverage area is too great and the collar is activating in areas you don't want, decrease the level so it activates reliably at the height of your dog's neck. Refer to the Transmitter Range Chart as a guide.

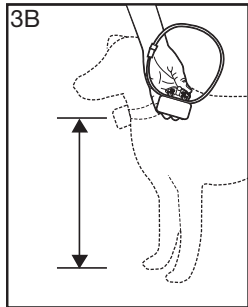
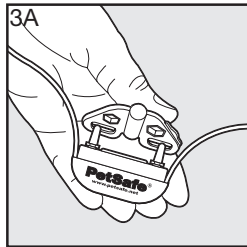

5. Use your pet's height as a starting point in choosing the appropriate level to set the Threshold Transmitter (3C).

Note: Should you find that you are not getting the desired range, adjust the setting, or relocate the threshold transmitter slightly. Metal objects can alter the magnetic field and change the transmitting signal range. The effect on the range depends on the size and shape of the objects. Signal range can be reduced if the Threshold Transmitter is placed on a concrete floor, due to steel reinforcement in the concrete. For best range results, place the Threshold Transmitter on a nonconductive surface, i.e., wood floor (3D). Placing the Threshold Transmitter beneath sofas and beds can reduce the range due to the metal springs altering the magnetic field. Test for proper operation before mounting or drilling. Use the removable mounting strips, or the supplied mounting hardware with the template to install your Threshold Transmitter. If mounting, drill 3/16" diameter holes.

Transmitter Range Chart		
Range Level	Red Flashes	Range Above Threshold*
1	1	Up to 16"
2	2	Up to 22"
3	3	Up to 28"
4	4	Up to 36"

Low Battery Indicator -
3 red flashes every 5 seconds

* Distance from edge of Transmitter.

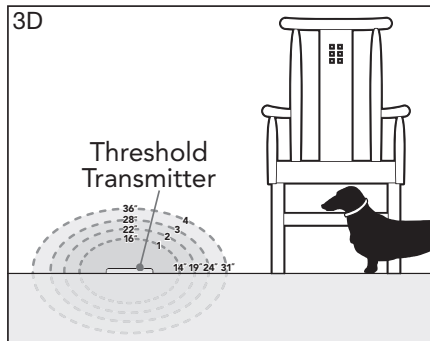
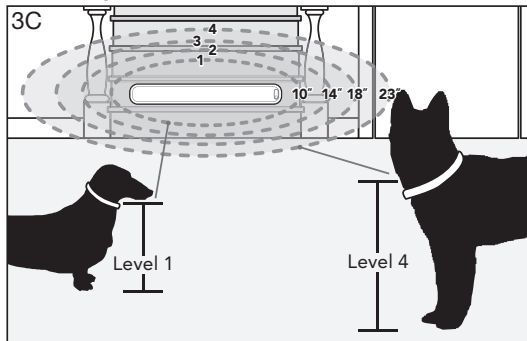

Step 4 Fit the Receiver Collar on Your Pet

Important: Proper fit and placement of your Receiver Collar is necessary for effective operation. The Contact Points must have direct contact with your pet's skin on the underside of his neck.

CAUTION Proper fit of the collar is important. A collar worn for too long or made too tight on the pet's neck may cause skin damage. Ranging from redness to pressure ulcers; this condition is commonly known as bed sores.

- Avoid leaving the collar on the pet for more than 12 hours per day.
- When possible reposition the collar on the pet's neck every 1 to 2 hours.
- Check the fit to prevent excessive pressure; follow the instructions in this manual.
- Never connect a lead to the electronic collar; it will cause excessive pressure on the contacts.
- When using a separate collar for a lead, don't put pressure on the electronic collar.
- Wash the pet's neck area and the contacts of the collar weekly with a damp cloth.
- Examine the contact area daily for signs of a rash or a sore.
- If a rash or sore is found, discontinue use of the collar until the skin has healed.
- If the condition persists beyond 48 hours, see your veterinarian.
- For additional information on bed sores and pressure necrosis, please visit our website.

These steps will help keep your pet secure and comfortable. Millions of pets are comfortable while they wear stainless steel contacts. Some pets are sensitive to contact pressure. You may find after some time that your pet is very tolerant of the collar. If so, you may relax some of these precautions. It is important to continue daily checks of the contact area. If redness or sores are found, discontinue use until the skin has fully healed.

You may need to trim the hair in the area of the Contact Points. Never shave the dog's neck; this may lead to a rash or infection.

To assure a proper fit, please follow these steps:

1. Using the edge of the Test Light Tool, turn the battery door to the OFF(●) position.
2. Start with your pet standing comfortably (4A).
3. Place the Receiver collar on your pet so that the PetSafe® logo is facing your pet's chin. Center the Contact Points underneath your pet's neck, touching the skin. If your pet has a long or thick coat then it may be necessary to trim the hair around the Contact Points to make sure that contact is consistent.

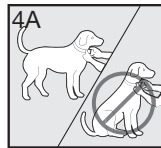

Note: The Receiver Collar comes with Short Contact Points. Long Contact Points are available and can be purchased through the Customer Care Center.

Please see the Accessories section of this Operating and Training Guide for more information.

4. Adjust the tightness of the Receiver Collar to fit your pet's neck. Check the tightness of the Receiver Collar by inserting one finger between the end of a Contact Point and your pet's neck. The fit should be snug but not constricting (4B).
5. Allow your pet to wear the Receiver Collar for several minutes then recheck the fit. Check the fit again as your pet becomes more comfortable with the Receiver Collar.
6. Once you are satisfied with the fit of the Receiver Collar then you may trim any excess collar strap as follows (4C):
 - a. Mark the desired length of the Receiver Collar with a pen. Allow for growth if your pet is young or grows a thick winter coat.
 - b. Remove the Receiver Collar from your pet and cut off the excess.
 - c. Before placing the Receiver Collar back onto your pet, seal the edge of the cut collar by applying a flame along the frayed edge.

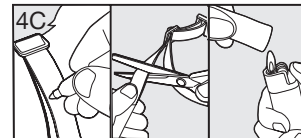
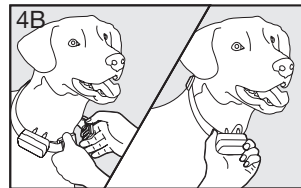

To Re-Thread the Collar

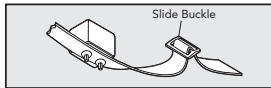

The slide buckle prevents the collar from becoming loose around your pet's neck.

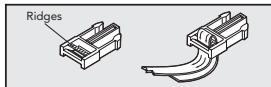

The ridges must be facing up; the collar will slip if it is not properly threaded.

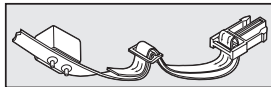

Receiver Collar Batteries

The PetSafe® Pawz Away® Receiver Collar uses two 3-volt Lithium coin cell batteries, size CR2032, PetSafe® RFA-35-11. Replacement batteries can be found at many retailers or through the Customer Care Center. Contact the Customer Care Center at 1-800-732-2677 or visit our website at www.petsafe.net to locate a retailer near you.

Battery life will vary depending on how often your pet tests the system and receives a Static Correction. Check the Receiver Collar and Threshold Transmitter every month to ensure the system is working properly. To prolong battery life, it is recommended that you turn the Receiver Collar and Threshold Transmitter OFF when not in use.

To replace the batteries:

1. Using the edge of the Test Light Tool, turn the battery door to the OPEN (🔒) position.
2. Lift the battery door out and turn the door over. The two 3-volt Lithium coin cell batteries are stored inside the door.
3. Remove the old batteries and insert new batteries with the positive (+) side facing the battery door lid.
4. Insert battery door back into the Receiver Collar and turn to either the OFF (⏻) or ON (⏻) position to lock the door in place.

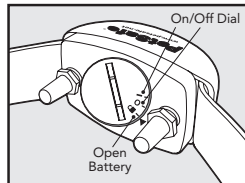

Additional Features

Time Out Feature

As a safety feature, the Receiver Collar has a built in Time Out feature. If your pet stays in the Barrier Area for longer than 13 to 15 seconds the Receiver Collar will stop delivering the Progressive Static Correction. The Receiver Collar will then administer a random single Static Correction every 4 to 10 seconds at the maximum level until the pet leaves the Barrier Area. Once your pet leaves the Barrier Area, the Receiver Collar resets itself and will deliver a Progressive Static Correction the next time your pet enters the Barrier Area.

Multiple Pets and Barriers

For multiple pet households, additional PetSafe® Pawz Away® Receiver Collars can be purchased to work with PetSafe® Pawz Away® Threshold Transmitters. You can set up an unlimited number of Threshold Transmitters in your home for use with an unlimited number of Receiver Collars.

All Pawz Away® Pet Barriers and Receiver Collars are preset to mode A. If you have other Pawz Away® Barrier products, note that the Pawz Away® Threshold Pet Barrier is set for AB mode.

Training Guide

The PetSafe® Pawz Away® Threshold Pet Barrier operates on the principle of positive and negative reinforcement. Your pet will learn to avoid the Barrier Areas you have set after receiving a Progressive Static Correction (negative reinforcement) and your pet will learn that he is more comfortable when he avoids the Barrier Areas (positive reinforcement).

In some cases, it may not be necessary to train your pet. You can let your pet wander freely to determine the new boundaries. **Monitor your pet during his first session.** Pets learn at different rates and it may take several times for your pet to successfully understand and honor the Barrier Areas.

Begin Your Pet's First Session

1. Move your pet away from the Barrier Area.
2. Activate the Receiver Collar by turning the battery door to the ON position. Place the Receiver Collar around your pet's neck. Be sure that the Receiver is directly under your pet's neck.
3. Allow your pet to wander freely to learn the new boundaries.

Further Training

If your pet is confused or unsure how to avoid the Barrier Areas then you may need to teach your pet how to do so by following these easy training steps:

1. Place a second non metallic collar on your pet ABOVE the Receiver Collar and attach a long leash.

CAUTION Be sure the extra collar does not put pressure on the Contact Points of the Receiver Collar.

2. Walk your pet toward the Barrier Area. As soon as you hear the tone or you see that your pet is receiving a Static Correction, gently pull him away from the Barrier Area and back into the safe zone.
3. Reward your pet with praise each time he leaves the Barrier Area.
4. Practice this technique a few times until you feel that your pet is mastering avoidance of the Barrier Areas.

Be sure to never force or entice your pet to enter the Barrier Areas.

Additional Information

- The system should only be used with healthy pets. Contact your veterinarian if you have concerns about the medical condition of your pet (medication, pregnant, heart conditions, etc).
- This system is not for vicious or aggressive pets. If your pet may pose a threat to others, **DO NOT USE THIS SYSTEM**. If you are unsure if your dog is aggressive, please consult your veterinarian or a certified trainer.

Accessories

To purchase additional accessories for your PetSafe® Pawz Away® Threshold Pet Barrier, contact the Customer Care Center at 1-800-732-2677 or visit our website at www.petsafe.net to locate a retailer near you.

Component	Part Number
Battery – 3 Volt Lithium (two pack - size CR2032)	RFA-35-11
Replacement Strap	RFA-308
Extra Receiver Collar	PWF00-13664
Extra Threshold Transmitter	RFA-514
Replacement Short and Long Contact Points	RK-17
Receiver Collar Battery Door	RFA-537
YardMax® Receiver Collar	PIG00-11116

The PetSafe® Pawz Away® Threshold Transmitter is compatible with PetSafe® Pawz Away® Receiver Collars and PetSafe® YardMax® Receiver Collars.

Troubleshooting

Threshold Transmitter does not appear to work.	<ul style="list-style-type: none"> • Press Mode button and verify Green light turns ON when button is pressed. Check that the Low Battery Indicator is not flashing Red. • Check/replace batteries in Threshold Transmitter and Receiver Collar. • Move the Receiver Collar closer to the Transmitter to test operation. • If you hold the Mode Button longer than 5 seconds, the Transmitter will turn off.
Barrier Area range is too low.	<ul style="list-style-type: none"> • Check/replace batteries in Receiver Collar and Transmitter. • Adjust Threshold Transmitter level to increase Barrier Area size.
Barrier Area range is too high.	<ul style="list-style-type: none"> • Adjust Threshold Transmitter level to decrease Barrier Area size.
Pet seems to receive no stimulation.	<ul style="list-style-type: none"> • Check/replace batteries in Receiver Collar. • Use Test Light Tool to check for static correction. • Check Receiver Collar fit to ensure Contact Points have direct skin contact. • Check the setting on the Threshold Transmitter.
Unable to hear Receiver Collar tone.	<ul style="list-style-type: none"> • Check/Replace batteries in Receiver Collar. • Pets easily hear tone but it may be a volume level that is difficult for you to hear. • Use the Test Light Tool to check Receiver Collar for Static Correction.
No LED light on Threshold Transmitter.	<ul style="list-style-type: none"> • Press and hold the Mode Button until the Green LED light is ON. • Check/replace batteries in Threshold Transmitter.

Terms of Use and Limitation of Liability

1. Terms of Use

This Product is offered to you conditioned upon your acceptance without modification of the terms, conditions and notices contained herein. Usage of this Product implies acceptance of all such terms, conditions, and notices.

2. Proper Use

This Product is designed for use with pets where training is desired. The specific temperament of your pet may not work with this Product. We recommend that you not use this Product if your pet is less than 5 pounds or if your pet is aggressive. If you are unsure whether this is appropriate for your pet, please consult your veterinarian or certified trainer.

Proper use includes reviewing the entire Guide provided with your Product and any specific Caution statements.

3. No Unlawful or Prohibited Use

This Product is designed for use with pets only. This pet training device is not intended to harm, injure or provoke. Using this Product in a way that is not intended could result in violation of Federal, State or local laws.

4. Limitation of Liability

In no event shall Radio Systems Corporation be liable for any direct, indirect, punitive, incidental, special or consequential damages, or any damages whatsoever arising out of or connected with the use or misuse of this Product. Buyer assumes all risks and liability from the use of this Product.

5. Modification of Terms and Conditions

Radio Systems Corporation reserves the right to change the terms, conditions and notices under which this Product is offered.

Compliance

FCC/Canada

This Class B digital apparatus complies with Canadian ICES-003. This equipment has been tested and found to comply with the limits for a Class B digital device, pursuant to Part 15 of the FCC Rules. These limits are designed to provide reasonable protection against harmful interference when the equipment is operated in a residential environment. This equipment generates, uses, and can radiate radio frequency energy and, if not installed and used in accordance with the instruction guide, may cause harmful interference to radio communications. However, there is no guarantee that interference will not occur in a practical installation. If this equipment causes harmful interference to radio or television reception, which can be determined by turning the equipment off and on, the user is encouraged to try to correct the interference by one or more of the following measures:

- Relocate the interfered receiving antenna.
- Increase the separation between the equipment and receiver.
- Connect the equipment into an outlet on a circuit different to that to which the receiver is connected.
- Contact the Customer Care Center at 1-800-732-2677.

This device complies with Industry Canada Rules. This device complies with part 15 of the FCC Rules. Operation is subject to the following two conditions: (1) This device may not cause harmful interference, and (2) this device must accept any interference received, including interference that may cause undesired operation.

Unauthorized changes or modifications to the equipment, not approved by Radio Systems® Corporation, could result in not meeting compliance with FCC regulations and could void the user's authority to operate the equipment.

Customer Care International

USA & Canada - Tel: 800-732-2677

Monday - Friday 8 AM - 8 PM / Saturday 9 AM – 5 PM

Australia - Tel: 1800 786 608

Monday - Friday 7:30 AM - 5 PM

New Zealand - Tel: 0800 543 054

Monday - Friday 10:30 AM - 7 PM

Perchlorate Battery

Perchlorate Material – special handling may apply.

See www.dtsc.ca.gov/hazardouswaste/perchlorate.

Warranty

One Year Non-Transferrable Limited Warranty

This Product has the benefit of a limited manufacturer's warranty. Complete details of the warranty applicable to this Product and its terms can be found at www.petsafe.net.

Radio Systems® Corporation

10427 PetSafe Way

Knoxville, TN 37932

1-800-732-2677

www.petsafe.net

Protected by US Patents 7,046,152; 7,068,174;
7,117,822; 7,204,204; 7,278,376; 7,495,570, 8,342,135, and other patents pending.
400-1731/3

©2014 Radio Systems Corporation