

REPLACEMENT PUMP INSTRUCTION MANUAL

ASSEMBLY INSTRUCTIONS

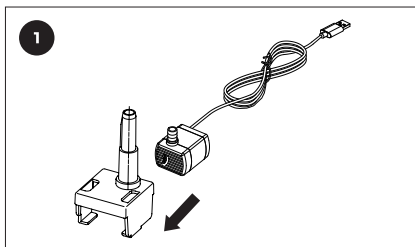

STEP 1

Attach the **housing** to the pump.

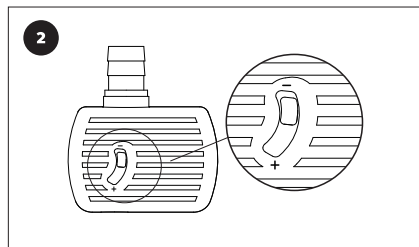

STEP 2

Move the pump's **slider** up/down to adjust the water flow.

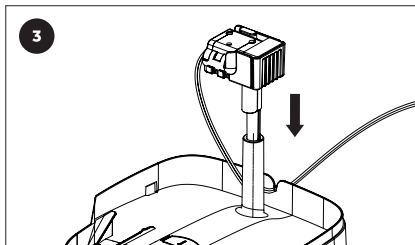

STEP 3

Attach the pump to the **lid**. Push the pump's cord into the **groove** of the lid.

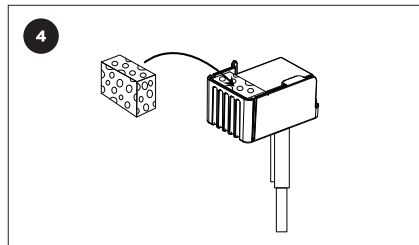

STEP 4

Place the **foam** in the space between the **housing** and **pump**.

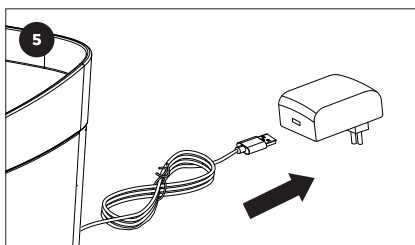

STEP 5

Connect to the **power supply**.

QUESTIONS?

CALL OUR FRIENDLY CUSTOMER SERVICE
TEAM ANYTIME. WE'RE HERE 24/7!
1-800-67-CHEWY (672-4399)