



HYGENA SCOOP®

Hygena Claw Scooper with Bag Holders

f HygenaScoop

ASSEMBLY INSTRUCTIONS

Buy more **waste bags** on our **Hygena Scoop®** e-store

How to unfold and lock scooper:



STEP 1
Hold the Scooper

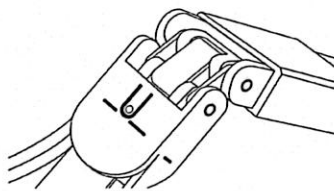

STEP 2
Unfold & Straighten the Scooper

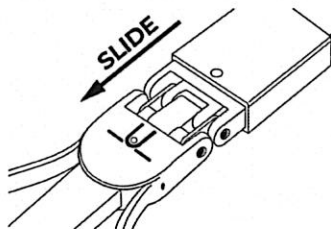

STEP 3
Slide the Lock into Position

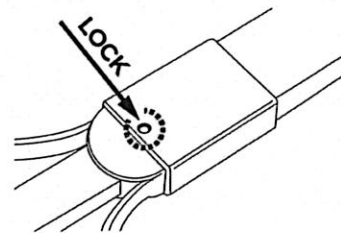

STEP 4
Finished Installation

How to install waste bags:

1.)



Step 1.
Place hand inside waste bag

2.)

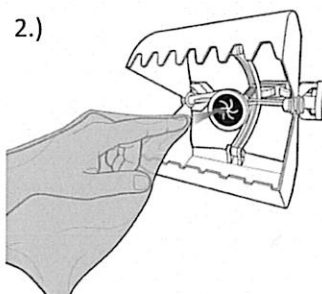

Step 2.
Open claw and insert bag into
center bag lock

3.)

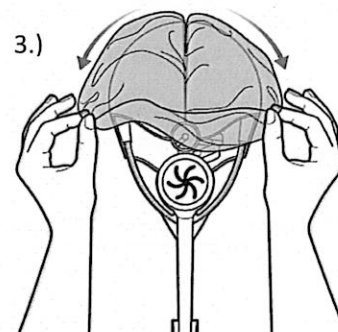

Step 3.
Close claw and pull bag
down towards side bag locks

4.)

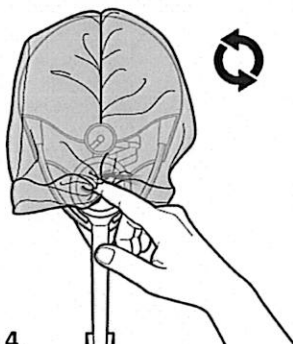

Step 4.
Insert excess bag into both side bag locks

5.)

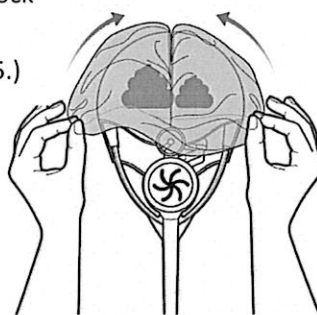

Step 5. (Waste disposal)
Pull bag out of side bag locks then
open claw and remove bag for disposal

Warnings:

Pet use only. Not a toy; to avoid danger of suffocation, keep the plastic bags away from babies and children. Never leave scooper or bags unattended with children. The scooper and bags are not a toy. Do not use the bags in cribs, beds, carriage, playpens, or anywhere other than for pet waste disposal.

How are we doing? ★★★★★

To Submit a Product Review: Go to the product detail page for **Hygena Scoop**. Click **Write** a customer review in the customer **reviews** section. Click **Submit**.

Need more **waste bags**? Order them on our **Hygena Scoop®** e-store

JPM Designs LLC. Questions? Comments? Find us @ www.facebook.com/hygenascoop