

PATHFINDER

AVAILABLE IN GPS-ONLY SYSTEM: PATHFINDER TRX

Owner's Manual

Please read this manual thoroughly
before operating the Dogtra PATHFINDER.

IMPORTANT SAFETY AND PRODUCT INFORMATION

WARNING

Please read all safety and product information below before using your Dogtra product. Failure to follow these safety instructions could result in injury to you, your dog and others, or it could result in damage to your Dogtra product or other property.

DOG SAFETY

Proper Use

Dogtra products should be used to train, educate, monitor, or track dogs. Each dog may have a different tolerance for and reaction to Dogtra products. Closely observe your dog when determining the right level of stimulation, collar fit, and other settings of your Dogtra product.

Training Methods

Dogtra products may be used with a variety of training methods that provide clear and consistent messages to your dog.

Fit and Wear

Proper fit and wear of your Dogtra product is important for the comfort of your dog as well as the functioning of your product. Dogtra collars should fit comfortably and not too tightly, so that the collar stays in place and does not move around your dog's neck. Do not leave a collar on your dog for an extended time. Although each dog is different, Dogtra recommends that its collars be used a maximum of 4 to 6 hours at any one time on your dog. A collar that is used for overly long periods or that fits improperly may cause skin irritation or sores on your dog's neck. Regularly check the collar's contact area on your dog's skin. If your dog exhibits skin irritation or sores, stop using the Dogtra product and consult with a veterinarian.

UNAUTHORIZED USE

Dogtra products should be used only in a safe and responsible manner to train, educate, monitor, or track dogs. Dogtra products are not intended for use in any other manner; they are not intended for use with other animals or with humans; and they are not intended for use in unsafe situations or environments that could lead to death, injury, loss or damage.

BATTERY

Your Dogtra product contains batteries. Do not attempt to replace the battery yourself. Contact Dogtra or your Dogtra retailer to replace your battery. Dispose of batteries as provided by your local regulations. Do not disassemble, crush, heat, or otherwise alter the battery as it may cause fire, explosion, injury and/or property damage.

OWNER SAFETY

Handling and Repair

Dogtra products can be damaged or malfunction if dropped, especially on hard surfaces, or otherwise improperly handled. Do not use a damaged or malfunctioning product as it may cause injury or property damage. If your product is damaged or malfunctions, contact Dogtra to obtain service before using the product.

Electrical Product

Your Dogtra product contains electrical components and batteries. Do not use or keep your product near heat or flammable sources. Such use or storage may damage your product and/or cause fire, explosion, injury, or property damage.

Charging

Only charge your Dogtra product with its accompanying Dogtra charger. Do not attempt to charge your product in any other manner or in temperatures less than 32°F (0°C) or over 113°F (45°C) as it may cause fire, explosion, injury, and/or property damage. If you notice damage to your product, its charger, or battery, obtain service from Dogtra before charging the product. Do not use more than one splitter cable with a single battery charger.

Medical Device Interference

Dogtra products contain electrical and magnetic components that emit low level electromagnetic waves and radio frequencies. These electromagnetic waves or radio frequencies may interfere with pacemakers, defibrillators, or other medical devices. Consult your physician or medical device maker before using your medical device with a Dogtra product. If you think that your Dogtra product is interfering with your pacemaker, defibrillator, or other medical device, stop using the Dogtra product.

Aggressive Dogs

Do not use Dogtra products with aggressive dogs as such dogs may react adversely and cause injury to people or other dogs. Seek the assistance of a dog-training specialist or veterinarian when dealing with aggressive dogs.

Children

Dogtra products are not toys. Adult supervision and close attention are necessary when Dogtra products are used by or near children.

CONTENTS

PACKAGE CONTENTS	6
MAIN FEATURES	7
OVERVIEW	8
UNDERSTANDING YOUR TRAINING SYSTEM	
1. TURNING THE PATHFINDER ON/OFF	11
2. BUTTON FUNCTION	12
3. CHARGING THE PATHFINDER	13
4. LED INDICATOR	14
5. INSTALLING THE PATHFINDER APP	15
6. PAIRING	16
7. ACQUIRING GPS SIGNAL	17
CHANGING THE CONTACT POINT LENGTH	17
COLLAR FITTING	18
REPLACING THE ANTENNA	19
MAXIMIZING THE DISTANCE	20
ATTACHING THE BELT CLIP	20
USING THE TEST LIGHT	21
TRX COLLAR	21
MAP TAB	
1. POSITION DISPLAY	22
2. DOG ICONS	23
3. DOG ALERTS	24
4. MAP FEATURES	24
5. MARKER	25
6. HISTORY RECORD BUTTON	27
COMPASS TAB	28
E-COLLAR TAB	
1. TRAINING FUNCTIONS	29
2. E-COLLAR BUTTONS	30

DEVICE LIST	
1. LIST OF CONNECTED DEVICES	31
2. DEVICE LIST OPTIONS	32
3. DEVICE SHARING AND RECEIVING A DEVICE	33
4. DEVICE DETAILS	35
HISTORY	
1. HISTORY FILES	37
2. HISTORY DETAIL	38
MAP MANAGEMENT	
1. MAP SELECT	39
2. OFFLINE MAP	40
3. CREATING CUSTOM MAP	42
4. UPLOADING MAPS TO YOUR SMARTPHONE	53
5. UPLOADING FILES	58
GEO-FENCE	67
APP SETTINGS	68
BASIC MAINTENANCE	71
TROUBLESHOOTING GUIDE	72
FCC WARNING	73
WARRANTY AND REPAIR INFORMATION	74

PACKAGE CONTENTS



GPS Connector



PATHFINDER: GPS E-Collar
PATHFINDER TRX: GPS Collar



Battery Charger



Splitter Cable



Owner's Manual



Belt Clip

Not included with TRX



Test Light



Contact Point
Extension Washer/
Adjustment Tool



Non-Stimulation
Contacts

MAIN FEATURES



2-Second GPS
Update Rate



Offline Maps



Tracking Only Mode



Precise and
Up-to-Date Maps



9-Mile Range



Geo-Fence Option



Fully Waterproof



Expandable to
21 Dogs



3.5-Hour Rapid
Charge Batteries



Belt Clip

Not included with TRX



Enhanced
Contact Points



Audible Tone



Nick/Constant
Stimulation



Low-High Output in
1-100 Stimulation Levels

For TRX Only

UKC & AKC Events Approved

OVERVIEW



**PATHFINDER
GPS Connector**



PATHFINDER
GPS E-Collar



**PATHFINDER TRX
GPS Collar**

UNDERSTANDING YOUR TRAINING SYSTEM

1. TURNING THE PATHFINDER ON/OFF



GPS Connector

- To turn on the GPS Connector, press the blue Select button until the LED turns on.
- To turn off the GPS Connector, press the blue Select button until the red LED shows.



GPS Collar

- To turn on the GPS Collar, press the Power button until the LED turns on.
- To turn off the GPS Collar, press the Power button until the LED turns red.
- A tone will be played to indicate that the GPS Collar is turning on or shutting down.

2. BUTTON FUNCTION



GPS Connector

The SELECT button is used to turn the Connector on/off and select a device to pair. While turned on, press the Select button once to set pairing to the GPS Collar, press the Select button a second time to set pairing to the smartphone app.



The CONNECT button is used to connect the GPS Connector to a smartphone and GPS Collar.

Pairing: Use the Select button to set the GPS Connector to Collar to pair the Connector with the Collar. Set the GPS Connector to Phone to pair the Connector to a smartphone.

Press and hold down the Connect button until the LED blinks rapidly. The GPS Connector will now be ready for pairing.



GPS Collar

Power On: To turn the GPS Collar on, press the Power button until the green LED turns on.

Power Off: To turn the GPS Collar off, press the Power button until the LED turns off.

Pairing: To place the GPS Collar into pairing mode, begin with the device turned off and hold down the Power button until the LED blinks rapidly. A melody will be played when the GPS Collar is in pairing mode.

*** The GPS Collar pairing mode is used to pair the GPS Collar and the GPS Connector. The PATHFINDER set comes with both parts paired to each other.**

3. CHARGING THE PATHFINDER

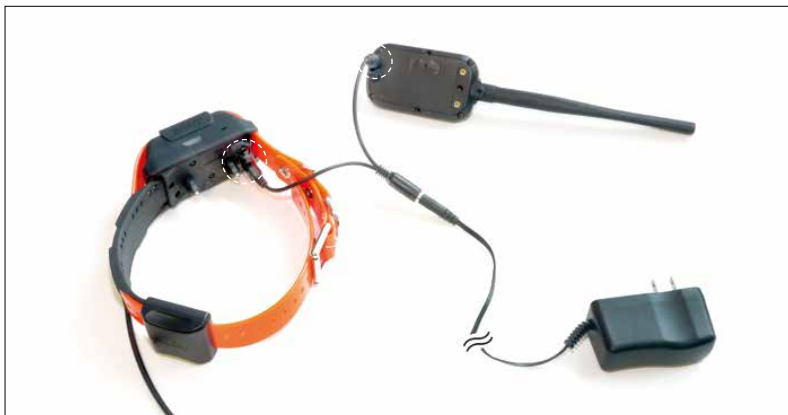

Fully charge the PATHFINDER GPS Connector and GPS Collar before the first use. The PATHFINDER uses lithium polymer batteries.

- Only use official Dogtra chargers with the PATHFINDER.
- Do not charge the PATHFINDER near flammable substances.
- Fully charge the PATHFINDER if storing for 1 month or longer.

When to Charge

- When the LED is red on the GPS Connector or GPS Collar.
- When the PATHFINDER app displays a low battery percentage for the GPS Connector or GPS Collar.
- When the LED on the transmitter or receiver will not come on.
- When the indicator light turns on momentarily, but will not stay on when the Constant button is pushed.

How to Charge

1. Connect the charger to the GPS Connector and GPS Collar using the splitter cable.
2. Plug the charger into a 120-volt outlet.
3. When fully charged, detach the cables and plug the rubber caps over the charging ports on the GPS Connector and GPS Collar.
4. The GPS Collar turns off and cannot be used while charging. The GPS Connector functions while being charged. The LED will display red while charging and green when the unit is fully charged. The GPS Connector LED will be green when turned on while charging. A depleted battery requires 3.5 hours to fully charge.

Splitter Cable

Do not use more than one splitter cable with a single battery charger.

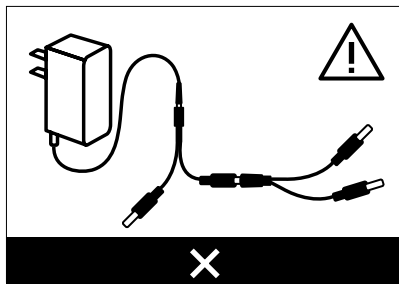
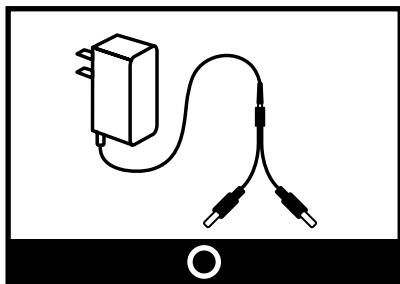

4. LED INDICATOR



GPS Connector

Power: The Power LED blinks every 2 seconds while turned on. The LED colors represents the battery life: Green when 50-100% battery, Orange when 10-50% battery, Red when 0-10% battery.
Phone: When turned on, press the Select button to set the GPS Connector to Phone. When set to Phone, a green LED will stay on. Hold down the Connect button until the LED blinks rapidly to place the GPS Connector into pairing mode.

Collar: When turned on, press the Select button the set the GPS Connector to Collar. When set to Collar, a green LED will stay on. Hold down the Connect button until the LED blinks rapidly to place the GPS Connector into pairing mode.



GPS Collar

The LED on the GPS Collar blinks while turned on, and the LED colors represents the battery life: Green when 50-100% battery, Orange when 10-50% battery, Red when 0-10% battery.

5. INSTALLING THE PATHFINDER APP

Compatible Phones

1) iOS: iOS 8.1 and above

iPhone 5, 5C, 5S, 6, 6+, SE, 6S, 6S+, 7, 7+, 8, 8+, X,
iPad Generation 3 and above

2) Android: Android 4.3 and above

Samsung Galaxy S4 and above, Note 2 and above, and LG G3

Downloading the App

Search for Dogtra PATHFINDER in the App Store or in Google Play.

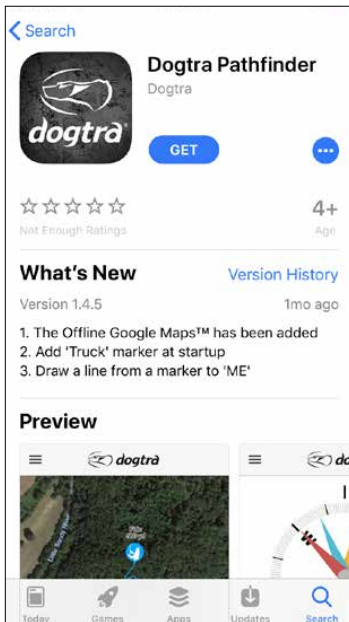

iOS App Store



Android Google Play Store

6. PAIRING

PATHFINDER GPS Connector connects between your smartphone and PATHFINDER GPS Collar. These devices need to be paired for the PATHFINDER system to work properly.

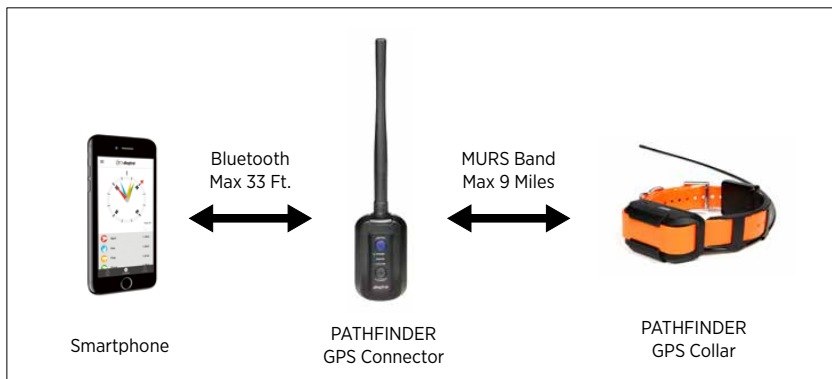

Pairing a Smartphone to the GPS Connector

- 1) Launch the PATHFINDER app
 - 2) Turn on the GPS Connector
 - 3) In the PATHFINDER app, navigate to Menu → Settings → Bluetooth Pairing
 - 4) Set the GPS Connector to pairing mode and click search in the app.
- Once paired, launching the app when the GPS Connector is on will automatically connect the phone and Connector together.
 - The GPS Connector should be within Bluetooth range (33 feet) of your phone to operate.
 - The GPS Connector will reconnect with the phone when it is within range.
 - Reinstalling the app will require pairing with the GPS Connector.
 - The PATHFINDER app may need to be restarted for compatibility issues.

Pairing Additional GPS Collars

Pair the GPS Connector and GPS Collar in close proximity to each other.

You can use the PATHFINDER app to check if the GPS Collar is properly paired.

- 1) Turn the GPS Connector on.
- 2) Check that the GPS Collar is turned off.
- 3) Use the Select button on the GPS Connector to set the LED to Collar.
- 4) Hold down the Connect button for 5 seconds until the LED blinks rapidly.
Release the button.
- 5) Hold down the Power button on the GPS Collar until the LED blinks rapidly and emits three beeps to show it has coded.
- 6) The GPS Connector and Collar will return to blinking in normal intervals when pairing is complete.

7. ACQUIRING GPS SIGNAL

The PATHFINDER is meant for use in open outdoor areas. After pairing, take the GPS Collar outdoors to acquire a GPS signal. Once the signal is acquired, the GPS Collar icon will appear on the Map tab of the PATHFINDER app. Operating the PATHFINDER near tall buildings and other steel structures will reduce the range of the GPS signal. Not acquiring a GPS signal for prolonged periods of time while outside may indicate issues with the unit.

8. ONLINE WEB MANUAL FOR ALL APP FEATURES & Q&A @ www.DogtraPATHFINDER.com

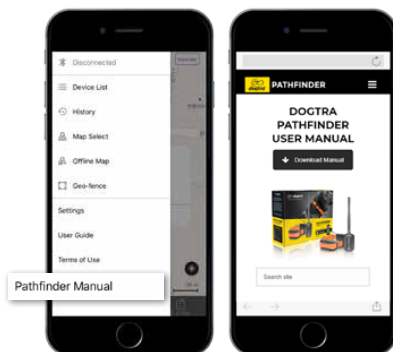

Check the PATHFINDER Web Manual at the bottom of the Menu to see all the app features, such as:

- Map Features
- Marker
- History Record, File, Detail
- Device List Options
- Device Sharing & Receiving
- Map Management: Offline & Custom Map
- Geo-fence
- App Setting



From your computer, check out the manual at www.DogtraPATHFINDER.com for a full version of the PATHFINDER manual, Q&A, and more.

CHANGING THE CONTACT POINT LENGTH

(Not included with TRX)

The Dogtra PATHFINDER comes equipped with standard 5/8" contact points that can be extended to 3/4" contact points, for use on dogs with longer coats. To increase the contact point length from 5/8" to 3/4", follow the steps below.

- 1) Using the included adjustment tool with the side marked 5/8", unscrew the contact points counter-clockwise.
- 2) Place the contact point extension over the exposed threads, flat side down.
- 3) Place the contact points over the extensions and tighten the contact points and extensions clockwise using the adjustment tool with the side marked 3/4".

Caution!

Tighten until firmly in place. Be careful not to over tighten.

To shorten the contact points back to the standard 5/8", start with the adjustment tool with the side marked 3/4", remove the contact point extensions, and tighten the contact points with the adjustment tool with the side marked 5/8".

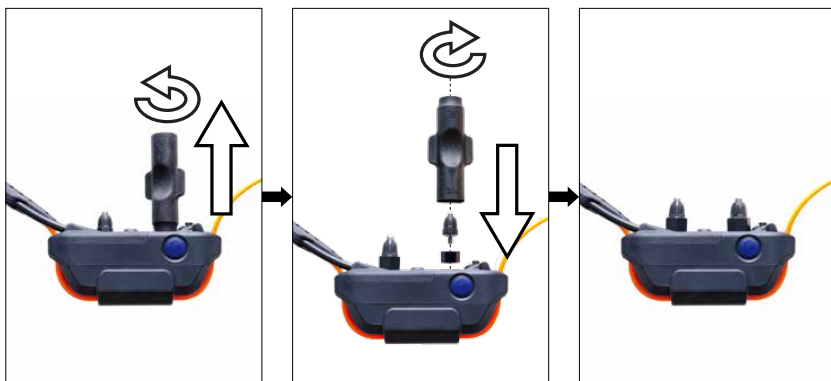

COLLAR FITTING

Proper Fit

The collar should be fitted so that the surgical stainless steel contact points press firmly against the dog's skin. You should be able to fit a finger in between the contact point and your dog's skin. The best location is on either side of the dog's windpipe.

Improper Fit

A loose fit can allow the collar to move around on the dog's neck. When this happens, the contact points may rub against the skin and cause irritation. If the collar is too loose, the contact will not be consistent and cause the corrections to be inconsistent. Dogtra uses surgical stainless steel contact points and anti-microbial plastic to protect the dog's skin.

Attention!

Leaving the receiver/collar in the same location on the dog's neck for an extended period of time can cause skin irritation. If the dog is to wear the e-collar for long periods, occasionally reposition the collar so that the contact points are moved to a different location on the dog's neck. Make sure you check for skin irritation each time you use the unit.

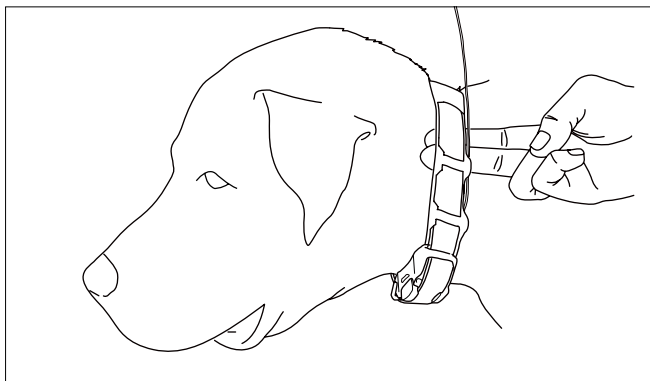

Finding the Right Stimulation (Not included with TRX)

- Open the PATHFINDER app to the E-Collar tab and select your dog and stimulation level.
- The stimulation levels are from 1 (lowest) to 100 (highest).
- Always start at the lowest level of stimulation and work your way up.
- The appropriate level can be found when your dog responds to the stimulation with a mild reaction, such as a tensing of the neck muscles.

Note: Every dog has a different tolerance and reaction to the stimulation. Please look at your dog's reaction to find the right level of stimulation. The stimulation level may vary depending on the situation and distractions. A distracted dog will require a higher level of stimulation compared to when there is no distraction.

REPLACING THE ANTENNA

For the GPS Connector

1. Twist the antenna counter-clockwise to remove.
2. Place the new antenna on the bolt and turn clockwise to tighten the antenna.



For the Collar



Open the antenna enclosure by removing the 4 screws and the contact points. Remove the screw holding the antenna in place to replace the antenna.

MAXIMIZING THE DISTANCE

- The PATHFINDER has a 9-mile line of sight range.
- To get the greatest range, hold the GPS Connector away from your body and avoid touching the antenna.
- Keep your unit properly charged for maximum signal strength.
- The GPS Connector device must be near your phone for proper operation, preferably less than 33 feet.

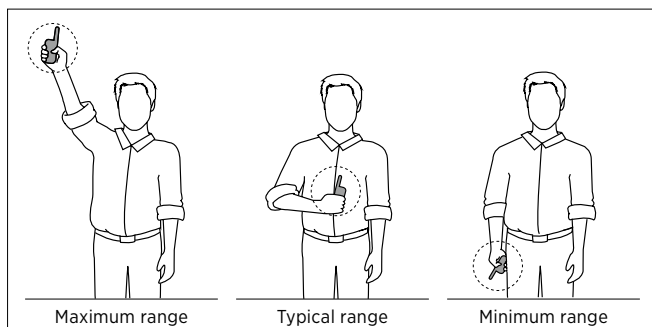

ATTACHING THE BELT CLIP

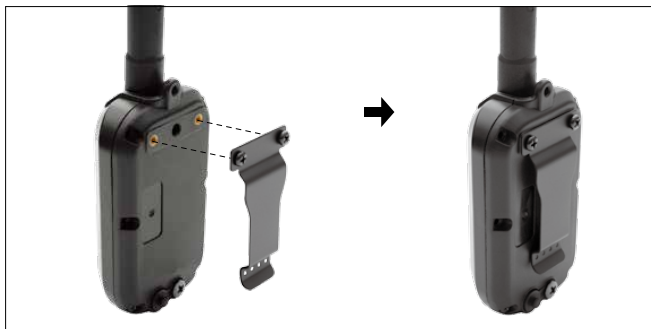

Follow the instructions below to attach the included belt clip to the GPS Connector

- 1) Align the belt clip to the grooves on the back of the GPS Connector.
- 2) With a firm grip, screw on the belt clip's Phillips head screws with a screwdriver.

Caution!

Tighten until firmly in place. Be careful not to over tighten.

USING THE TEST LIGHT (Not included with TRX)



- 1) Turn on the GPS Collar and place the test light over the contact points.
- 2) Press the Nick button in the PATHFINDER app and the test light will light up momentarily.
- 3) Press the Constant button in the PATHFINDER app and the test light will light up as long as the button is pressed, for up to 12 seconds.
- 4) The test light will glow brighter at higher levels of stimulation and dimmer with lower levels.

Note: The test light may not be visible if the intensity level is set below level ten.

TRX COLLAR



The TRX Collar is distinguishable by the orange GPS antenna casing. The TRX Collar does not come with stimulation or tone.

MAP TAB

1. POSITION DISPLAY

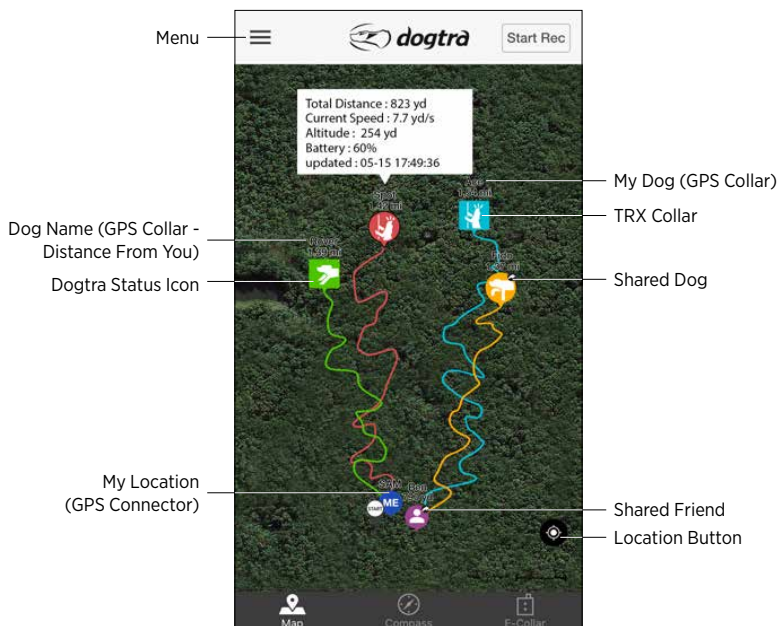

With the GPS Connector paired to a GPS Collar and phone or when receiving shared GPS Connector/Collar devices, the positions will be displayed on the map.

Dog Position Display

Your dog's location is viewed on the map along with the collar name and distance from your position. The dog icon displays your dog's current action status.

The real time 'Collar Icon' information has been added to check the Traveled Distance, Current Speed, Altitude, Battery, Updated Time, and Shared Device.

My Position

When the GPS Connector is paired with your phone, your current position and tracks will be displayed.

When viewing shared GPS Connector devices, an icon (or) will be displayed along with the device name and distance from your position.

*** Devices that are offline or hidden will not be displayed on the map.**

*** The GPS Collar name and color can be edited from Menu/Device List/Device/Edit.**

* : iOS

* : Android

2. DOG ICONS

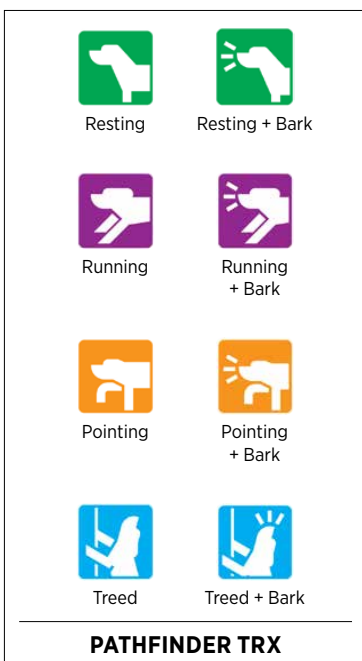
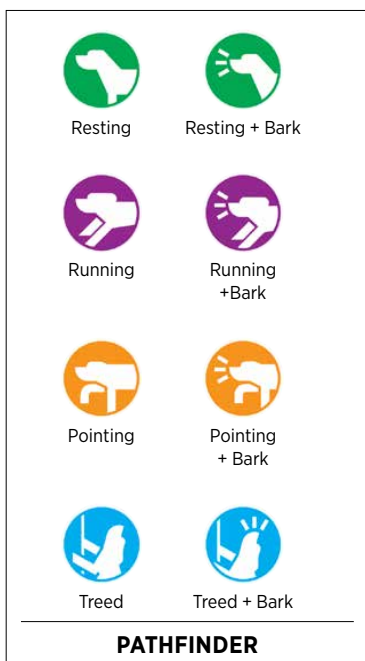

When your dog's action changes, the icon action status will change as well. The dog icons that will display are for Resting, Running, Pointing, and Treeing. A Bark Indicator will display in combination with these icons if the dog barks while doing any of these actions.

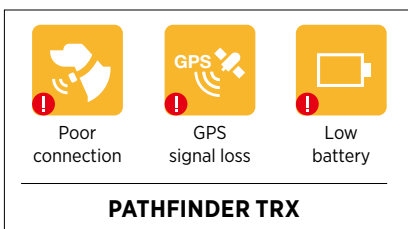
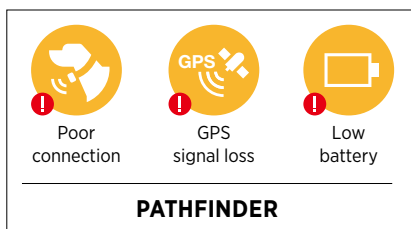

The dog display icon will also change to an icon that represents issues, such as poor connection, GPS signal loss, or low battery. Devices shared will display the shared symbol on the device icon.

The TRX Collar is a tracking only collar that does not have tone or stimulation. The TRX Collar is displayed as a square icon() in the Map and Compass tab, Device List, and Dog Status page. TRX Collars will not be displayed in the E-Collar tab. All other functions are available for the TRX Collar, since both the PATHFINDER and PATHFINDER TRX can be used together in a multi-dog set up.

3. DOG ALERTS

Select a dog on the map to receive notification alerts for that dog.

In the Alarm Settings for Dog Alerts, you can receive notifications for the Selected Collar and All Collars. The current selected dog is displayed with an outline around their icon.

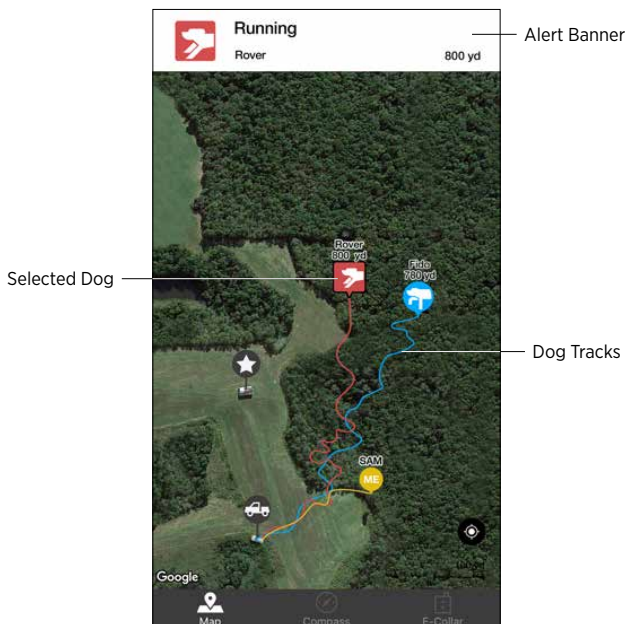

4. MAP FEATURES

The PATHFINDER Map tab has multiple map features to help make finding your way around easier.

Zoom

- Double tap the map with one finger to zoom in once.
- Single tap the map with two fingers to zoom out once.
- Use two fingers to pinch the screen to zoom in and stretch the screen to zoom out.

Scroll

- You can scroll by using one finger to drag the map to the area you want to view.

Tilt

- Tilt the map by using two fingers and dragging the map up or down.

Rotate

- Rotate the map by using two fingers and applying a turning motion.

5. MARKER

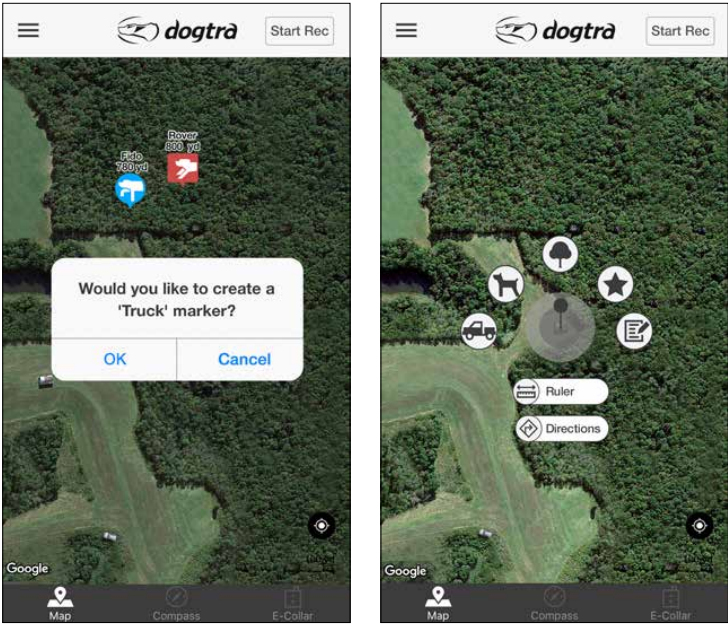

Marker

Markers

Add a 'Truck' marker to mark your car location when the app launches to draw a line between the 'Truck' and 'ME' markers. You may also create a 'Truck' marker at the current location you are at when using the app.

Long press anywhere on the map to open up the Marker Ruler Menu. The markers can be used to mark important locations.

The marker will be stored in the history file. When starting a new Tracking History, the previous marker will still be on the map. If you tap on the marker, you will see the marker delete button and a line from the current location to the marker.

Text can be saved along with the markers. You can create 20 markers of each type (except Ruler and Direction).



Ruler

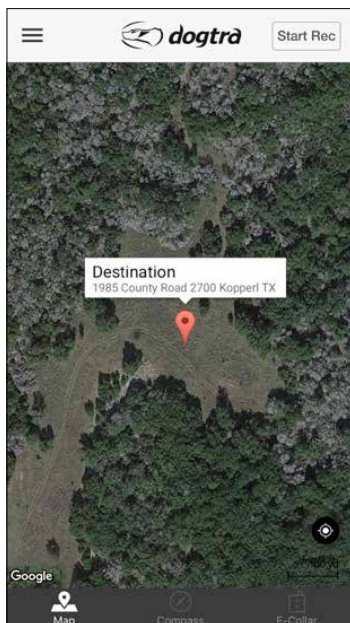

Directions

Ruler

The distance ruler can measure the distance between multiple points. When finished, click "x" to exit out of the distance ruler.

Directions

The Directions function is used to find your way back to your desired destination, which can only be marked with one marker. You must have the Google Maps application installed in order to see the directions to your destination. You will also need to use either cellular data or Wi-Fi to use this function.

6. HISTORY RECORD BUTTON

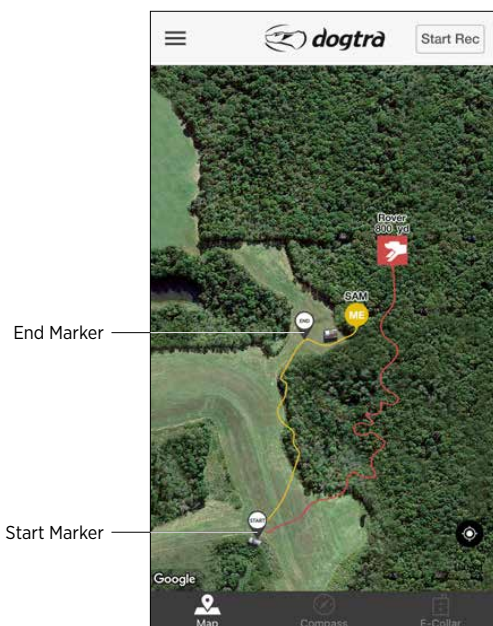

When you press the 'Start Rec' button to record the Tracking History, the Start Marker will be created. When you press the 'Stop Rec' button to stop the recording, a Stop Marker will be created.

You can tap the marker to draw a line between the hunter and the marker. You can see the direction and distance between these two markers on the Compass tab.

The markers cannot be deleted while the recording is in session. You must stop and save the session in order to delete the Start Marker and End Marker.

COMPASS TAB

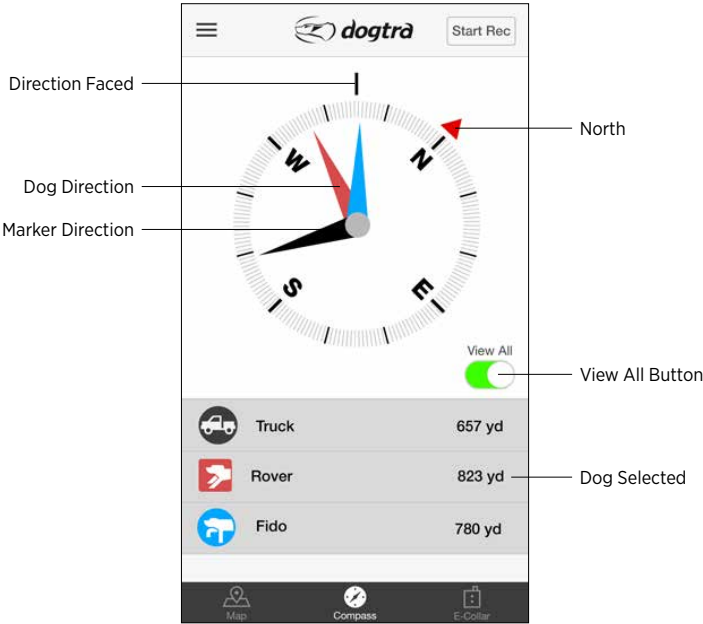

View the direction and distance of dogs, or a selected marker and hunter at a glance. Select dogs and hunters from the list to display them on the compass. You may also tap on a marker on the map to show the information on the Compass tab. Use the 'View All' button to view all dogs and hunters at once. Dogs and hunters are not displayed when hidden or offline.

- Metal phone cases or metal objects attached to the phone will interfere with the compass.
- The phone may need to be calibrated for the compass to work properly.

E-COLLAR TAB (Not included with TRX)

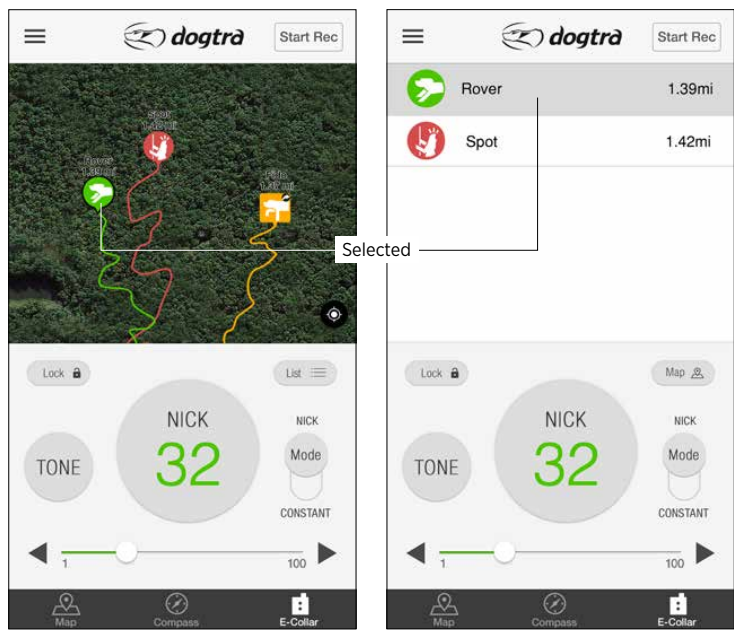

Map View

List View

1. TRAINING FUNCTIONS

The Nick or Constant stimulation or an audible tone can be sent to the selected dog.

The tone sound level cannot be adjusted and the tone will ring each time the button is pressed. The Nick and Constant stimulation modes have stimulation levels from 1 to 100. The stimulation level is controlled by the stimulation slider and stimulation increase/decrease buttons on the left and right of the slider. The stimulation level can be set for individual dogs.

2. E-COLLAR BUTTONS

List/Map View

Dogs can be selected using the dog list or in map view.

List view displays dogs in a list along with their distance from you. The List view is recommended when training multiple dogs.

Map view displays selectable dog icons on a mini map. The Map view is recommended for long distance recall commands.

*** Dogs are not displayed when hidden or offline.**

*** The TRX Collars, Shared Collars, Shared Friend E-Collars will not show on the List view.**



Mode Button

Use the Mode button to switch between Nick and Constant stimulation modes.

Lock Button

The Lock button disables training functions until unlocked.

Use the lock feature so dogs are not accidentally stimulated.

Sending Stimulation

- 1) Select a dog from List or Map view.
- 2) Select the stimulation level using the stimulation slider or stimulation increase/decrease buttons.
- 3) Set the stimulation to Nick or Constant using the mode button.
- 4) When Nick is selected, the receiver emits a single rapid pulse of electrical stimulation. When Constant is selected, the stimulation will give continuous stimulation as long as the button is pushed, for up to 12 seconds.

*** The E-Collar tab is disabled when the Tracking Only Mode is turned on in the Settings menu.**

DEVICE LIST

1. LIST OF CONNECTED DEVICES

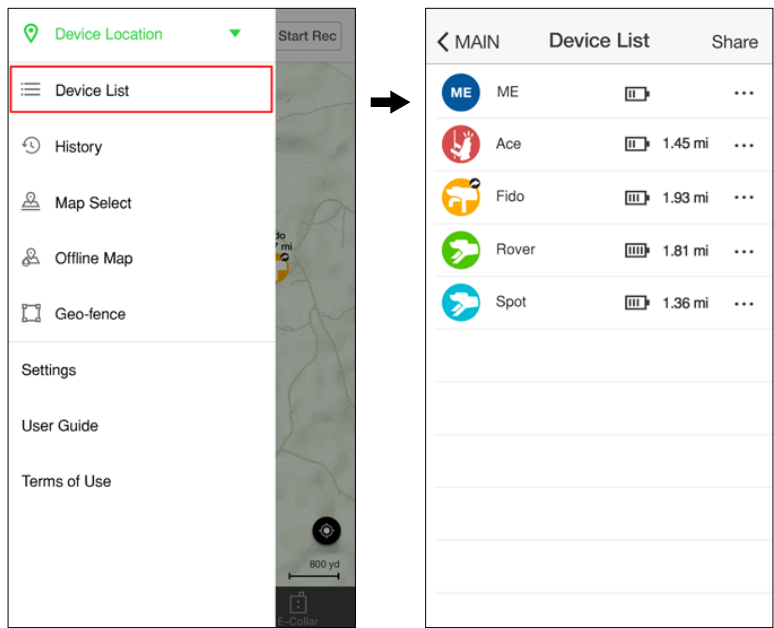

- Connected devices are displayed on the Device List.
- The dog icons display the dog's current action.
- Device battery life and distance from your location are displayed.
- Selecting a device will display detailed information.

2. DEVICE LIST OPTIONS

Press the more options button (...) to bring up the options to hide or reorder devices.

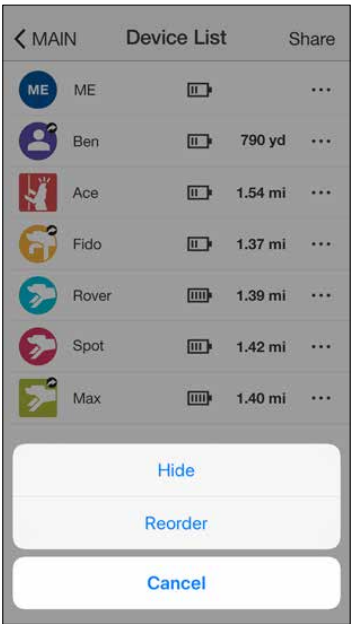

Hide

Hidden devices do not show up in the Map, Compass, and E-Collar tabs. Use the more options button in the Device List to unhide a device.

Reorder

Reorder how the devices show in the app. Press reorder to place the device in sorting mode. Hold down the sort button and place the device in the desired position. The new order will be used in the Map, Compass, and E-Collar tabs.

3. DEVICE SHARING AND RECEIVING A DEVICE

Device Sharing

Press the share button to share and receive GPS Connector/Collar devices. Both sharing and receiving PATHFINDER users must use the device sharing feature within close proximity to each other.

Sharing a Device

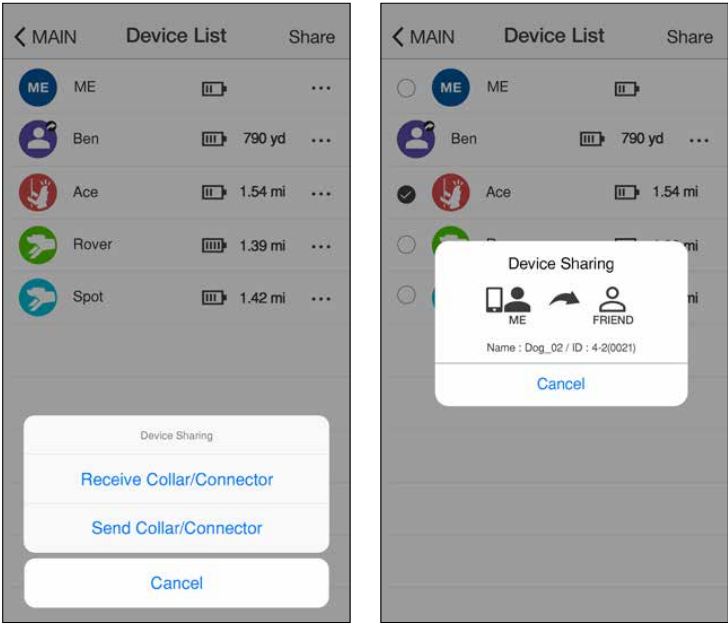

- You can share your position or your dog's position.
- Press the share button and select the device you want to share.
- A pop up will appear when a device has been successfully shared.

Receiving a Device

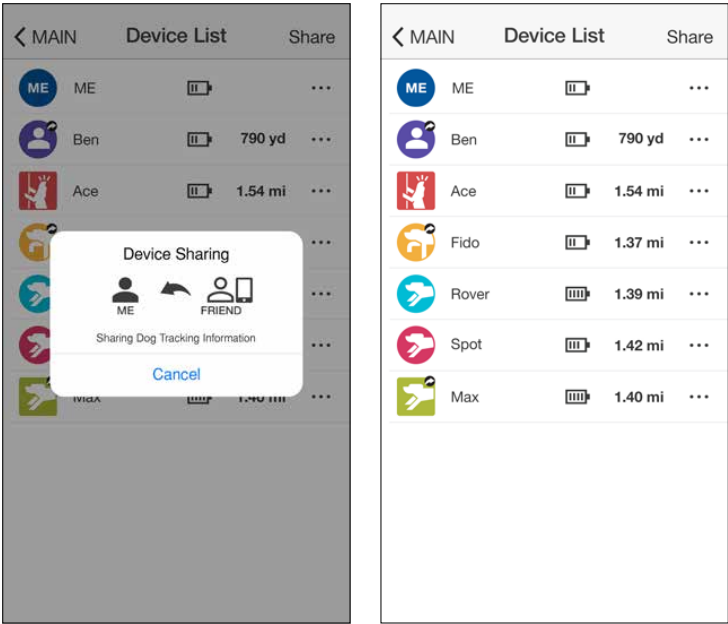

As another PATHFINDER user is sending a device, press the share button and receive from the pop up menu. A pop up will appear when a device has been successfully received. Shared devices can be identified by the shared symbol (🐾 or 🐾) and are displayed on the Map and Compass tabs, along with the tracks and dog statuses as they update.

- E-collar and updating GPS settings are disabled for received shared devices.
- GPS settings are disabled for offline devices.
- TRX Collars that are shared are displayed with a square icon when they are received.

4. DEVICE DETAILS

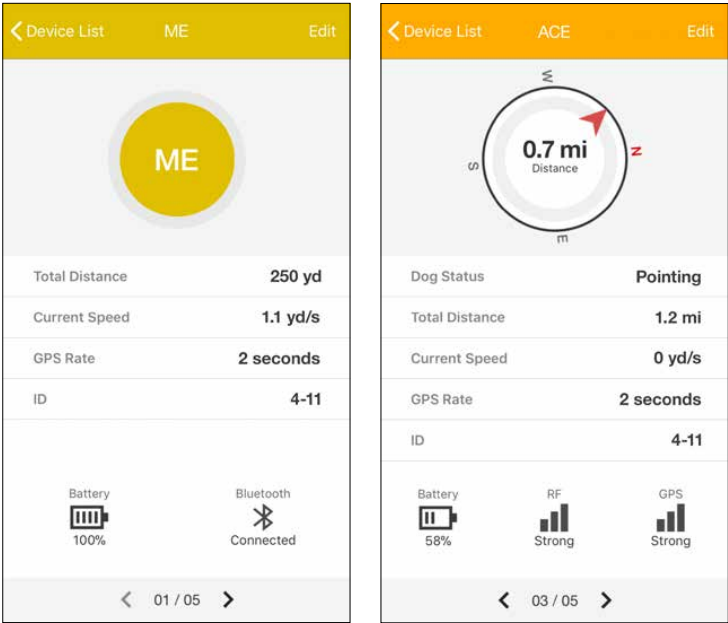

Press a device from the Device List to go to the device details page. The device details displays the total distance traveled, current speed, ID, GPS strength, radio frequency strength, battery level, and shared and hidden statuses. Slide the device details page to view other devices.

Device Info Edit

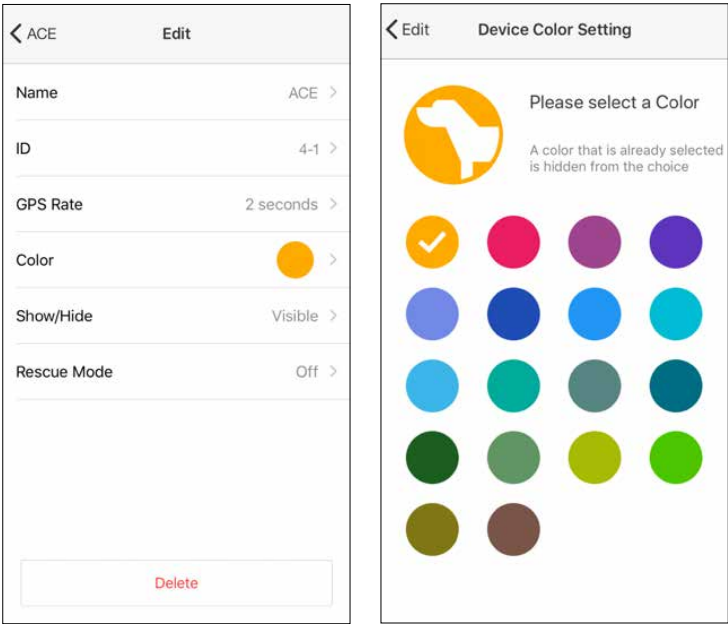

Edit

Press the Edit button to change device settings.

Name

Press Name to edit the device name.

ID

The GPS Collar ID can be changed. Change the ID when the signal conflicts with another GPS Collar. The ID of devices that are shared with you cannot be changed. The first number in the ID is the channel and the second number is the order. Do not use the same ID for additional GPS Collars.

GPS Rate

The GPS update rate can be changed for each device with options for 2 seconds, 6 seconds, 10 seconds, 30 seconds, and 120 seconds. The update rate of devices that are shared with you cannot be changed.

Color

The color associated with the GPS Collar can be changed. The device color is used in the icon, tracks, compass needle, and in the Device List views.

Collar Show/Hide

Hide or show a hidden device.

Rescue Mode

Turning on Rescue Mode activates when the GPS Collar battery life is at 25% or less. The device is placed in sleep mode, and the update rate is changed to 120 seconds to reduce power consumption. The rescue mode setting cannot be changed for devices that are shared with you.

Delete

Delete removes the pairing between the GPS Collar and GPS Connector, or removes from the app devices shared with you. To add the GPS Collar back, the GPS Collar and GPS Connector will have to be paired. Previously shared devices will need to be shared again.

HISTORY

1. HISTORY FILES

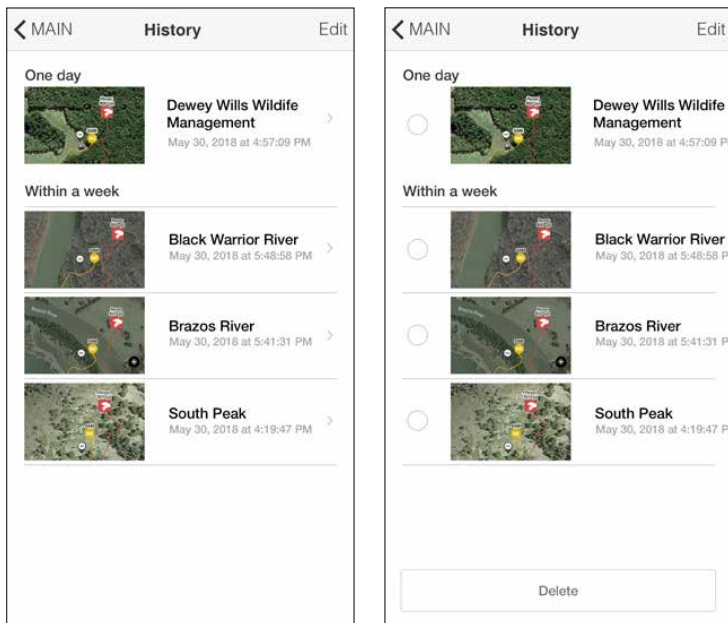

View history files and delete using the edit button. History files currently recording cannot be accessed until completed. Select completed history files to playback and view details. A history file begins recording when the GPS Connector is connected to the phone and the app is open.

2. HISTORY DETAIL

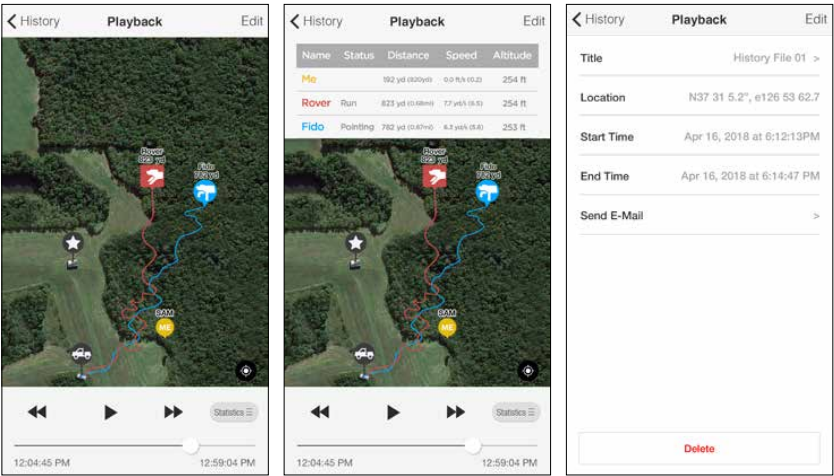

Play Button

The history file displays the track movement of dogs and people. Use the play button to view the movement from start to finish, or use the slider to jump to a specific time.

Show Statistics

If you press the Statistics button, it will show the dog's Status, Distance, Speed, and Altitude at the time it was recorded. If you select an item on the list, it will not play on the map.

Send History File

Completed history files can be emailed as a KML file. iPhone users can download the KML file using iTunes. KML files can be viewed on a desktop computer using Google Earth.

MAP MANAGEMENT

1. MAP SELECT

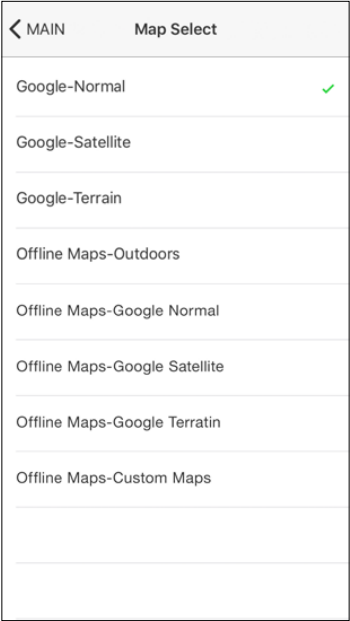

A preferred map view can be selected. Choose between the following options:

- Google Map – Normal
- Google Map – Satellite
- Google Map – Terrain
- Offline Maps – Outdoors
- Offline Maps – Google Normal
- Offline Maps – Google Satellite
- Offline Maps – Google Terratin
- Offline Maps – Custom Maps

2. OFFLINE MAP

The offline map is displayed when cellular data/Wi-Fi is unavailable. Offline maps should be downloaded before entering areas with limited data.

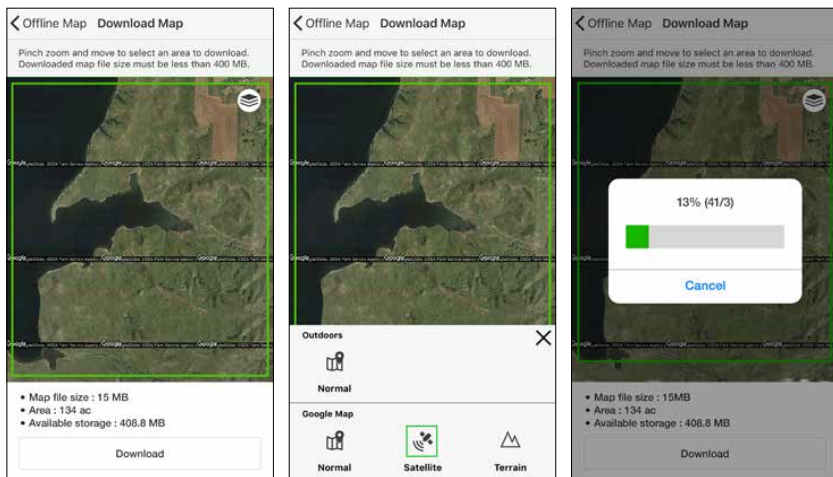

Downloading the offline map area

- 1) Select the type of map you want to download.
- 2) Navigate to the area you want to download and use the pinch and zoom functions to specify the area.

3) Select the area to show a green square with is less than 400MB.

*** If the file is over 400MB, it will show a red square and cannot be downloaded.**

- 4) You may select the map you downloaded in the Offline Map List.

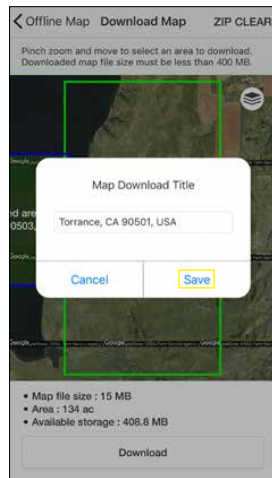
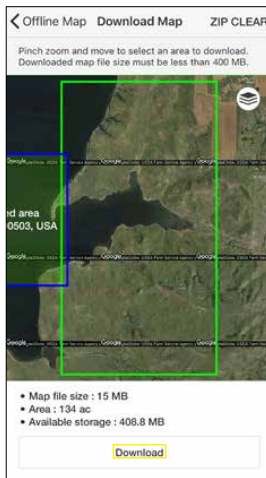

Using zip code to download maps

- 1) Select the type of map you are going to download.
- 2) Press the Zip Code button and enter the zip code of the area you want to download.
- 3) The map can be downloaded if the map size is less the storage space of your smartphone. Please note that it may take a longer time to download if the map area and file size are larger.
- 4) You may select the map you downloaded in the Offline Map List.

*** Zip Code: US, Canada only**

3. CREATING CUSTOM MAP

What is a custom map in the PATHFINDER app?

The PATHFINDER app can display custom maps created in Mbtiles file format. Users can save and share portions of the map in Mbtiles file format. Here you can see how to create and upload Mbtiles files for use in the PATHFINDER app.

Creating Mbtiles Files

The introduction to Mobile Atlas Creator and Maperitive will go over the differences for each program. Use the program that best suits your needs.

Mobile Atlas Creator

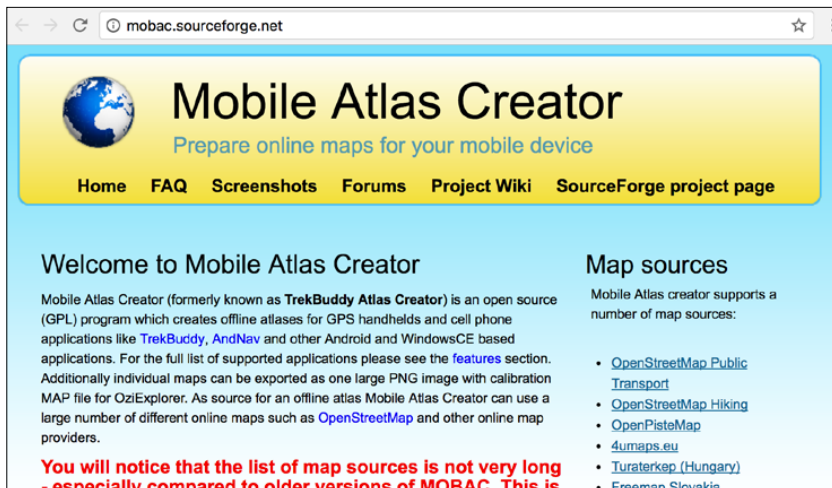
A screenshot of a web browser displaying the Mobile Atlas Creator website. The browser's address bar shows 'mobac.sourceforge.net'. The website has a yellow header with a globe icon and the title 'Mobile Atlas Creator' followed by the tagline 'Prepare online maps for your mobile device'. Below the header is a navigation menu with links: Home, FAQ, Screenshots, Forums, Project Wiki, and SourceForge project page. The main content area is divided into two columns. The left column is titled 'Welcome to Mobile Atlas Creator' and contains a paragraph describing the software as an open-source GPL program for creating offline maps for GPS devices. It mentions previous names like 'TrekBuddy Atlas Creator' and lists supported applications like 'TrekBuddy' and 'AndNav'. It also notes that maps can be exported as PNG images or used as source for offline atlases. A red text box at the bottom of this column states: 'You will notice that the list of map sources is not very long - especially compared to older versions of MOBAC. This is'. The right column is titled 'Map sources' and lists several map providers: OpenStreetMap Public Transport, OpenStreetMap Hiking, OpenPisteMap, 4umaps.eu, Turaterkep (Hungary), and Freemap Slovakia.

← → ↺ Ⓞ mobac.sourceforge.net ☆ ⋮

Mobile Atlas Creator

Prepare online maps for your mobile device

[Home](#) [FAQ](#) [Screenshots](#) [Forums](#) [Project Wiki](#) [SourceForge project page](#)

Welcome to Mobile Atlas Creator

Mobile Atlas Creator (formerly known as **TrekBuddy Atlas Creator**) is an open source (GPL) program which creates offline atlases for GPS handhelds and cell phone applications like [TrekBuddy](#), [AndNav](#) and other Android and WindowsCE based applications. For the full list of supported applications please see the [features](#) section. Additionally individual maps can be exported as one large PNG image with calibration MAP file for OziExplorer. As source for an offline atlas Mobile Atlas Creator can use a large number of different online maps such as [OpenStreetMap](#) and other online map providers.

You will notice that the list of map sources is not very long - especially compared to older versions of MOBAC. This is

Map sources

Mobile Atlas creator supports a number of map sources:

- [OpenStreetMap Public Transport](#)
- [OpenStreetMap Hiking](#)
- [OpenPisteMap](#)
- [4umaps.eu](#)
- [Turaterkep \(Hungary\)](#)
- [Freemap Slovakia](#)

Mobile Atlas Creator is free software that converts images used in maps into the Mbtiles file format.

Installing Mobile Atlas Creator on your Computer

- 1) To create Mbtiles files, you must first install Mobile Atlas Creator on your computer. The latest version of Mobile Atlas Creator can be downloaded from <https://sourceforge.net/projects/mobac/files/>.
- 2) Unzip the file and run the installation program.
 - Window : Execution Mobile_Atlas_Creator.exe
 - Mac or linux : Execution Mobile_Atlas_Creator.jar
- 3) For more information, visit '<http://mobac.sourceforge.net/quickstart/install.htm>'.

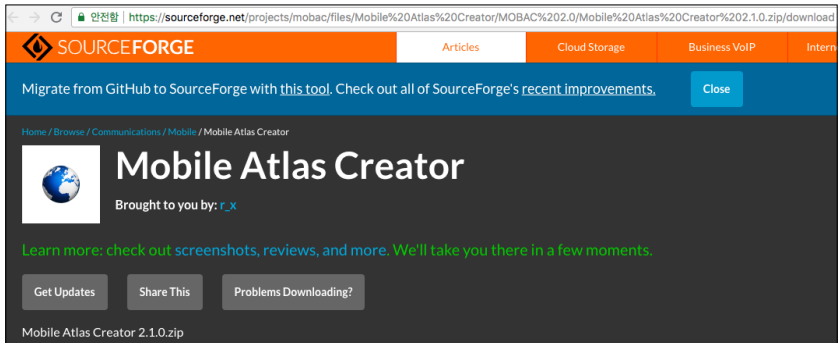

Create Mbtiles files

- (1) Select the desired Map source

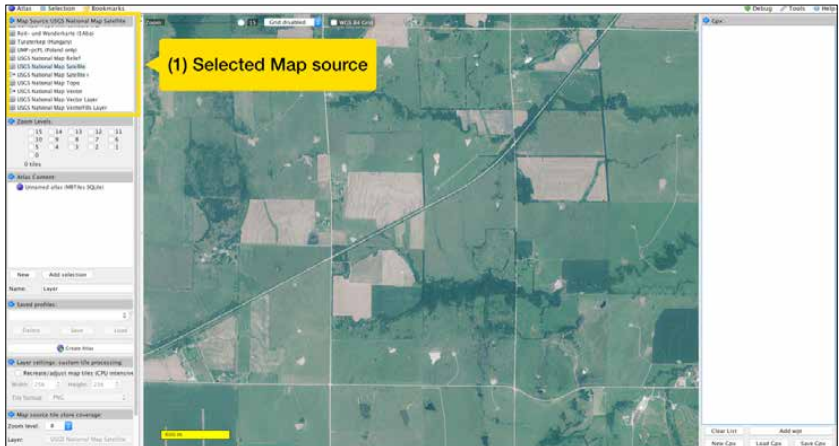

(2) Select the desired area on the map using Drag and Drop.

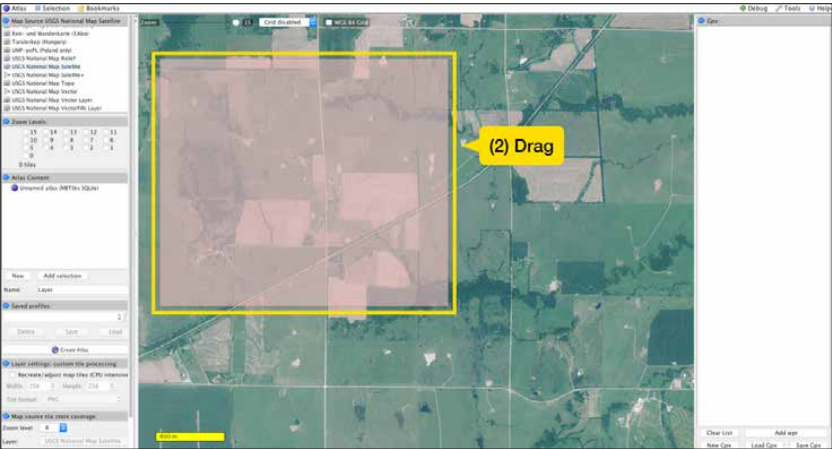

(3) Select the Zoom level to save.



Note: Please check the number of image tiles downloaded. Downloading more than 10,000 image tiles is not recommended.



(4) You can change the name of the file in Atlas Content by right-clicking the title and selecting Rename.



(5) Add the selected area to the map in Atlas Content. First, enter a name in the Name field.



Click the Add Selection button to add the selected region to Atlas Content.



(6) Click on Atlas in the upper left corner to open the menu and select Convert Atlas format.

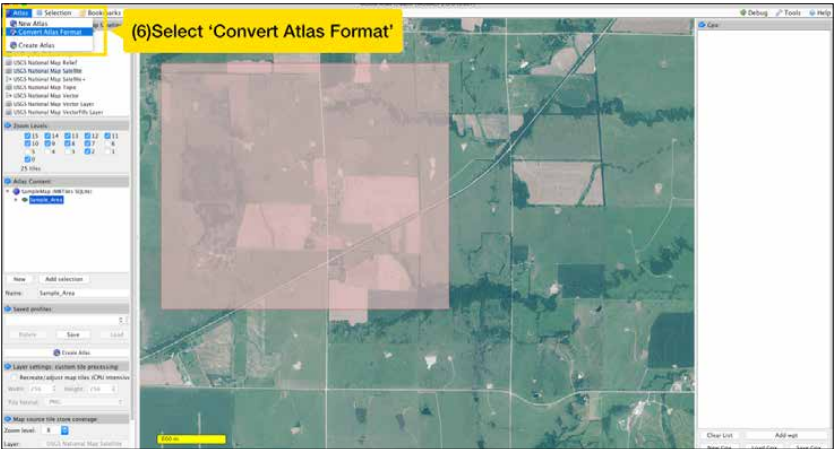

(7) Select the Mbtiles SQLite file format.

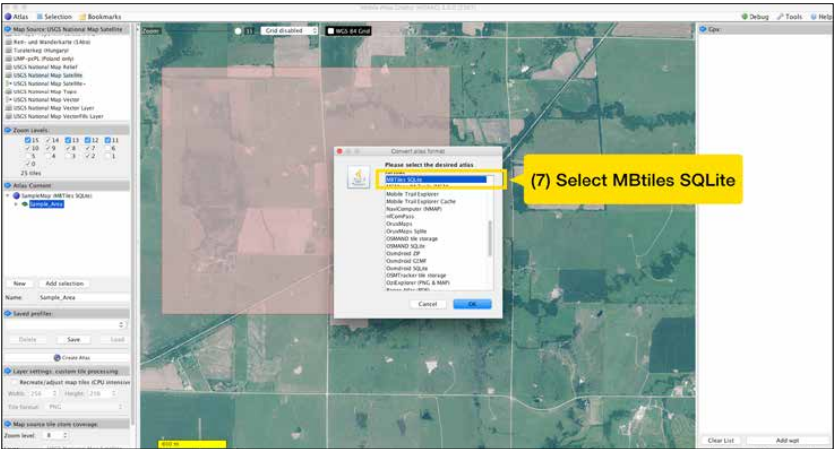

(8) Click the Create Atlas button to start creating Mbtiles.

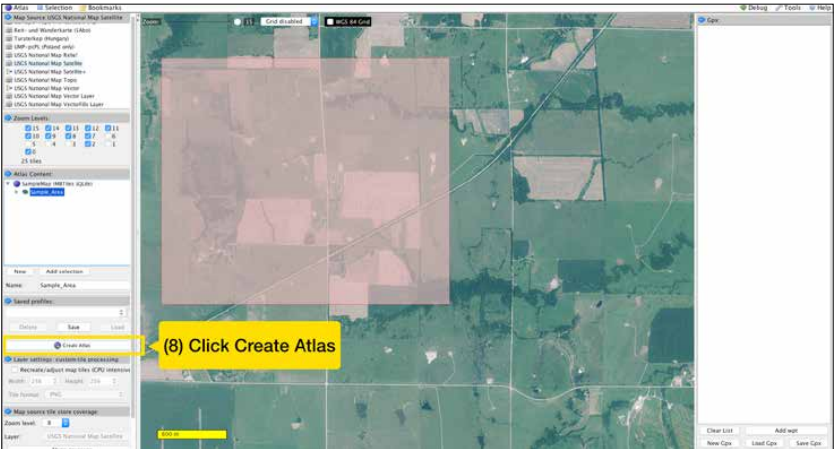

(9) When the creation process is completed, you can check the completed file by pressing the Open Atlas Folder button.

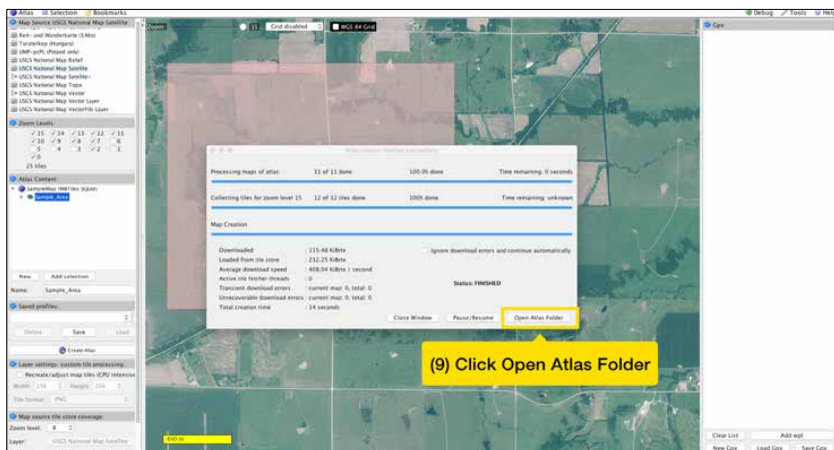

Installing Maperitive on your Computer

Windows: Compatible with Windows XP SP3 and newer with Microsoft.NET 4 installed. Download the latest zip file from 'http://maperitive.net/'. Unzip the file and run maperitive.exe.

OS X: To run Maperitive on OS X, download the latest version of Mono from 'https://www.xquartz.org/' (X11 is already installed on MAC). Download from 'http://maperitive.net/', and go to the Applications directory to unzip it. From the terminal, you can go to the Maperitive directory and run it. Please refer to the Wiki Maperitive Installation for detailed installation instructions.

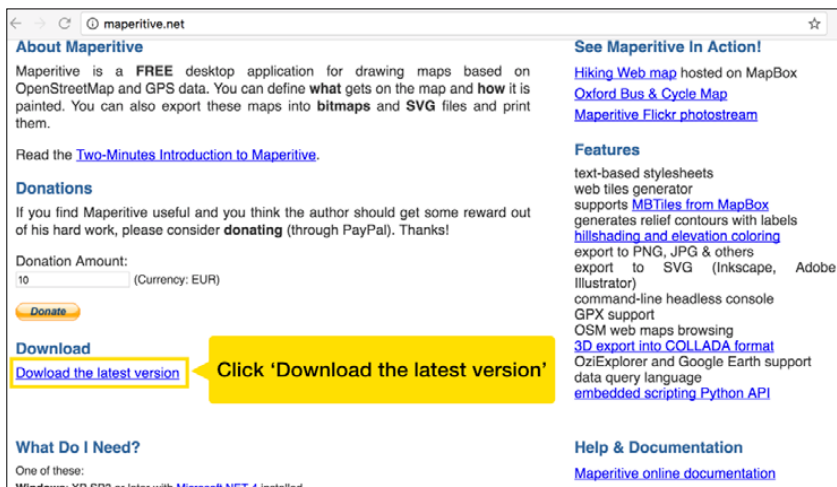

The screenshot shows the maperitive.net website. A yellow callout box points to the 'Download the latest version' link under the 'Download' section, with the text 'Click 'Download the latest version''. The website content includes sections for 'About Maperitive', 'Donations', 'What Do I Need?', 'See Maperitive In Action!', 'Features', and 'Help & Documentation'. The 'About' section describes Maperitive as a free desktop application for drawing maps based on OpenStreetMap and GPS data. The 'Donations' section includes a donation amount input field and a 'Donate' button. The 'What Do I Need?' section lists requirements: Windows XP SP3 or later with Microsoft .NET 4 installed. The 'See Maperitive In Action!' section lists various map types and features. The 'Features' section lists capabilities like text-based stylesheets, web tiles generation, and support for various map formats. The 'Help & Documentation' section provides links to online documentation.

Create Mbtiles files

(1) Turn on Maperitive and zoom in on the desired map area.

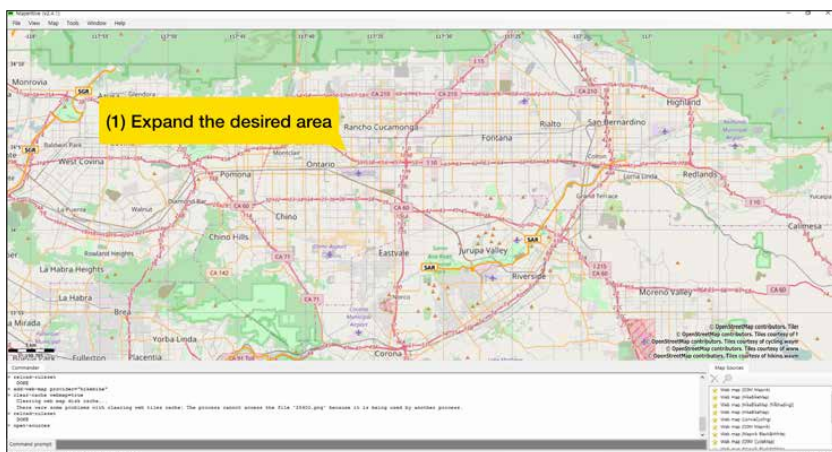

(2) Select the desired map style through Tools -> Add Web Map



(3) Select Map -> Set Geometry Bounds to select the area to save.

*** After selecting an area, zoom out to review the selected area.**

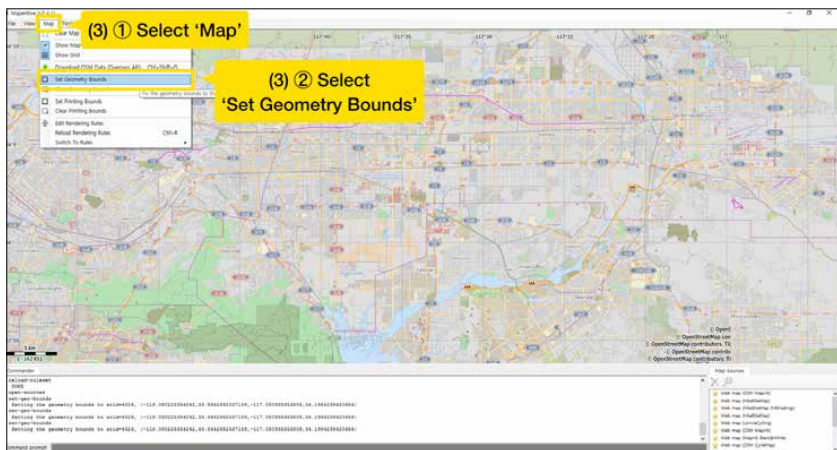

(4) Select Map -> Download OSM Data. Wait for the download to complete.

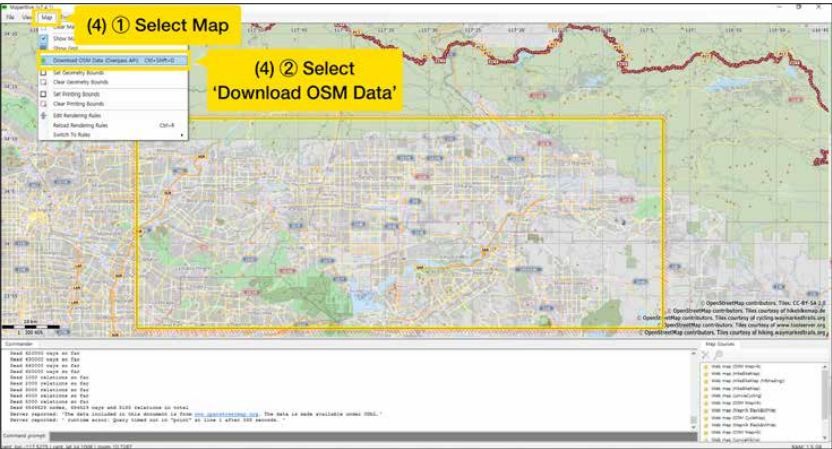

(5) To create Mbtiles, enter the zoom level range (minimum and maximum) for the desired area into the Command prompt. For example: if you want to create Mbtiles with a zoom level between 5 and 18, type into the Command prompt "generate-mbtiles minzoom = 5 maxzoom = 18".
For more information, please reference: <http://maperitive.net/docs/#Commands>

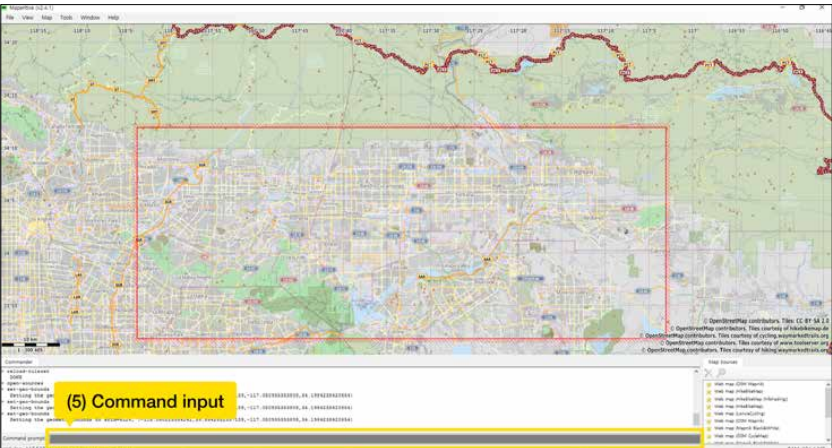

- (6) After the download is complete, follow the path displayed in the Command prompt to see the Mbtiles created.

For detailed explanations please refer to '<http://maperitive.net/docs/TenMinutesIntro.html#Using%20The%20Map>'.

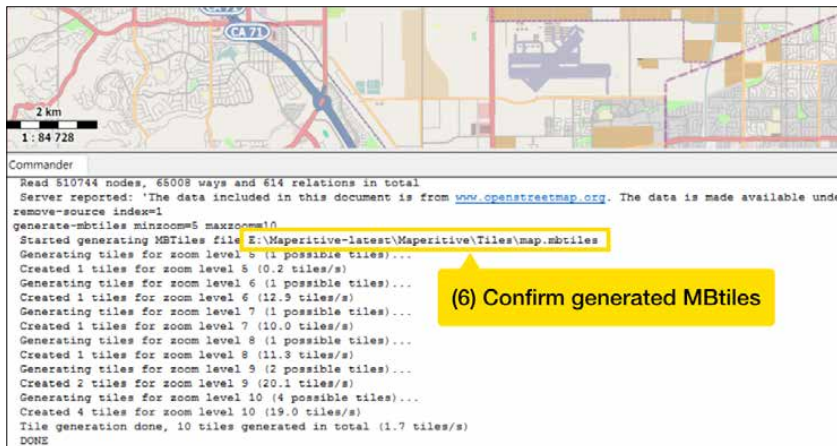

4. UPLOADING MAPS TO YOUR SMARTPHONE (ANDROID, IPHONE)

Uploading Mbtiles files

To use the created Mbtiles files in the PATHFINDER app, they must be placed in a specific repository on your smartphone.

You can upload it directly to your smartphone or upload it to a cloud service and download it via the PATHFINDER app.

Uploading directly to your smartphone - Android

(1) Connect your smartphone to a computer using a USB cable.

*** This guide is based on a Windows 10 PC and Galaxy S5 smartphone.**

(2) Select your smartphone storage from your computer.

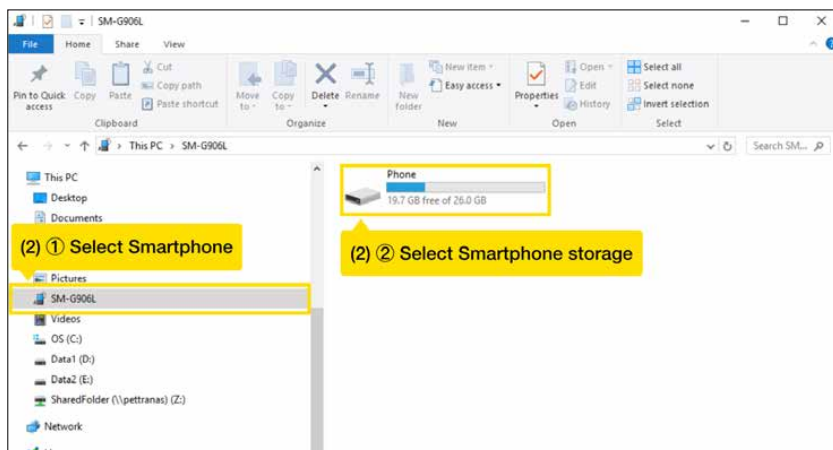

Copy files to a folder

(3) Select the path to save the created Mbtiles file.

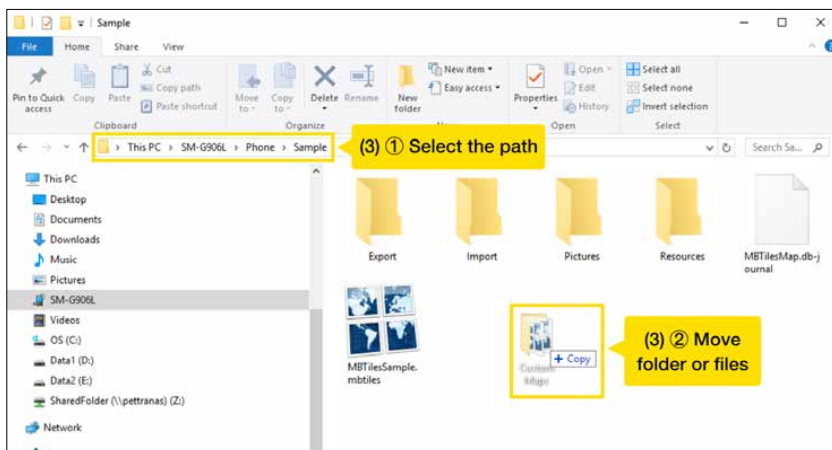

Notes: When saving to internal storage, save Mbtiles in the PATHFINDER / CustomMaps folder to skip importing from the PATHFINDER app.

If the CustomMaps folder is missing, create a new folder directly in the PATHFINDER folder and rename it to CustomMaps. Mbtiles can be copied to the newly created CustomMaps folder.

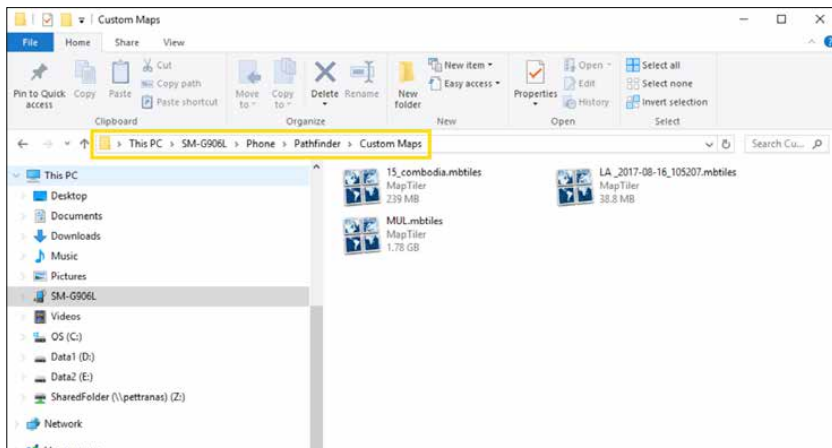

Uploading directly to your smartphone - iPhone

(1) Connect your iPhone to your computer and launch iTunes.

*** This guide is based on iTunes version 12.7.0.166.**

(2) Go to the iPhone summary page.

*** Click the icon to go to the iPhone summary page.**

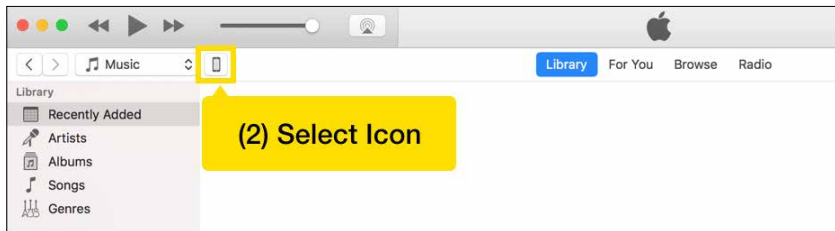

*** The iPhone summary page is shown below.**

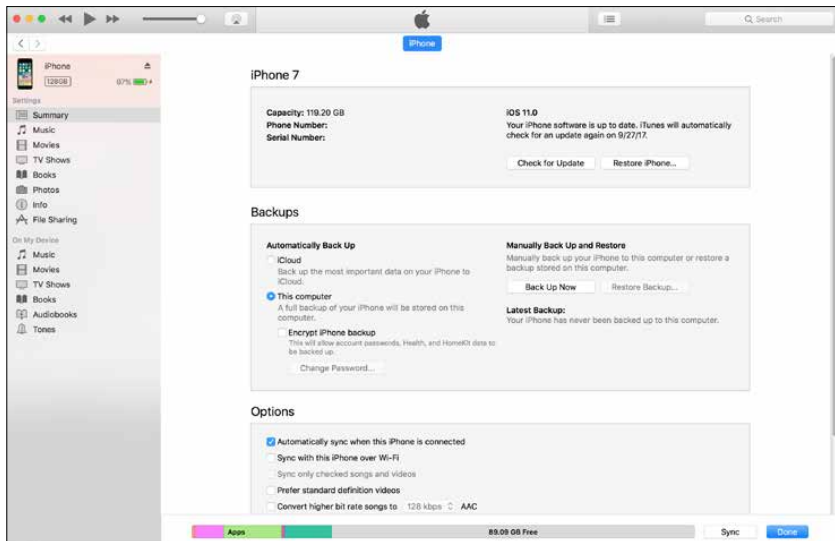

(3) Select File Sharing from the left menu.

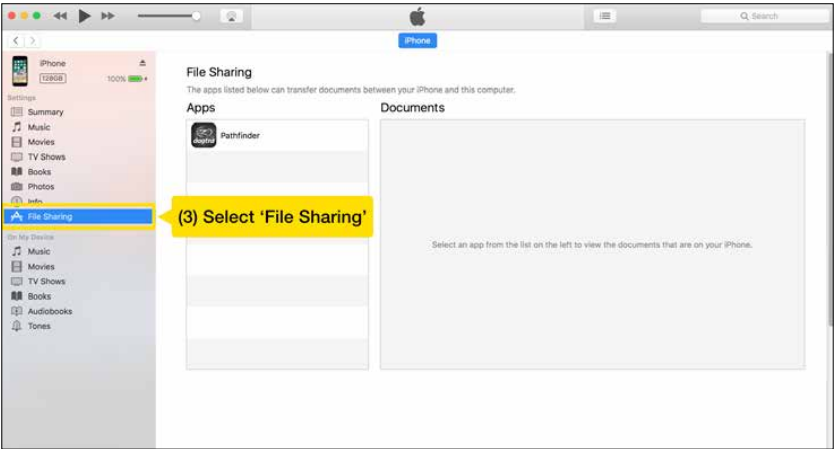

(4) Select PATHFINDER from the File Sharing list.

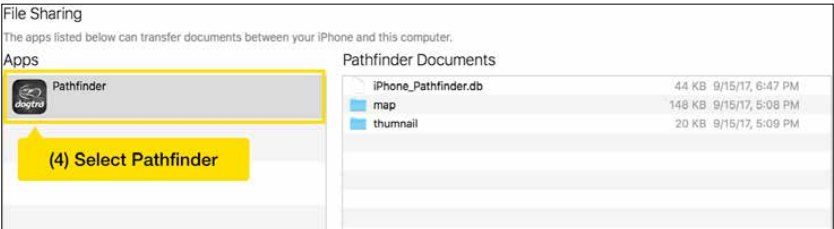

(5) When the Document tab of the PATHFINDER opens, add the Mbtiles by Drag & Drop or the Add button.

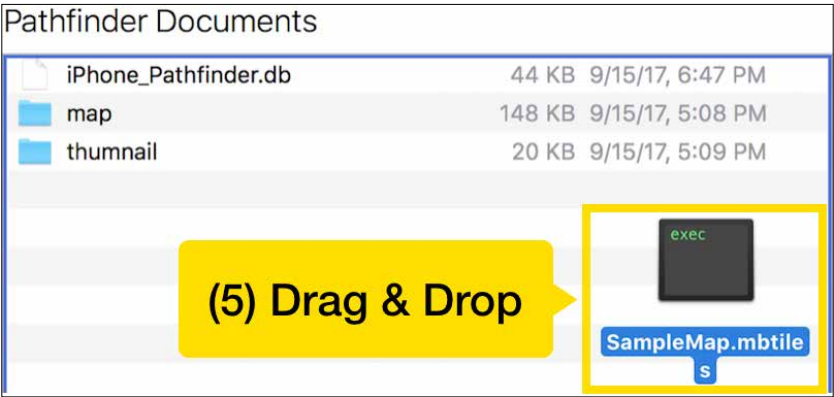

(6) You can see that the Mbtiles files have been added.

*** Mbtiles files placed in the PATHFINDER folder via iTunes can be used without importing from the PATHFINDER app.**

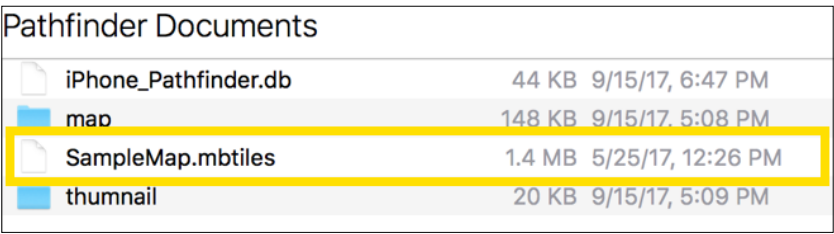

5. UPLOADING FILES

Uploading to iCloud - iPhone

(1) Log in using '<https://www.icloud.com/>'.

For detailed login instructions, please visit '<https://support.apple.com/en-us/HT204174/>'.

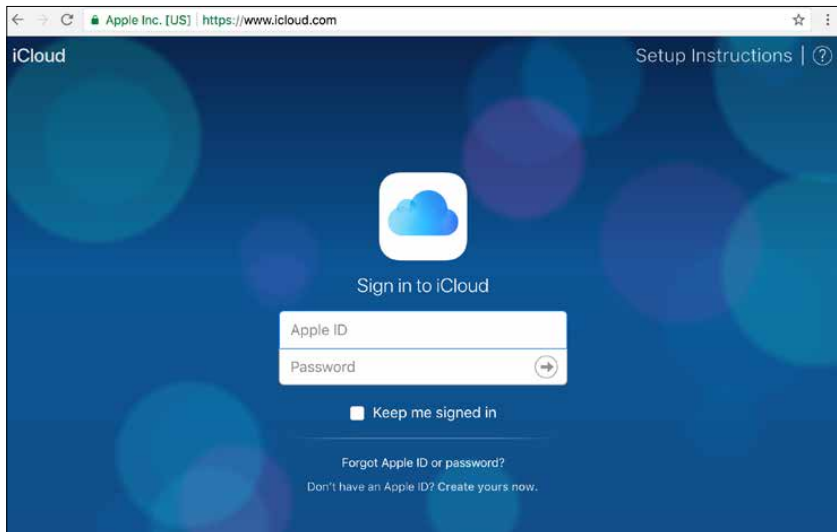

(2) On the main page, click iCloud Drive.

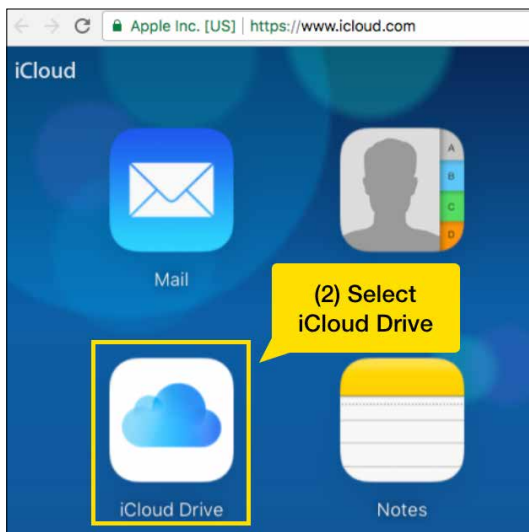

- (3) Upload Mbtiles files using one of the following methods.
- (3-1) Drag & drop the Mbtiles file to iCloud Drive.

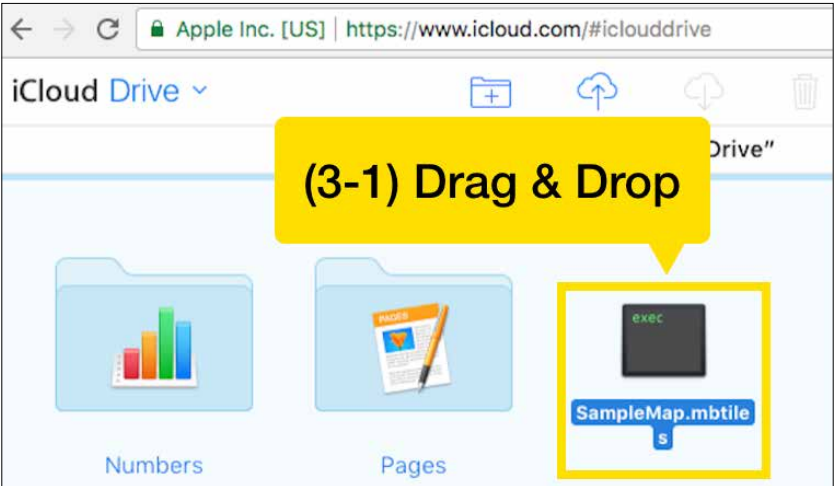

- (3-2) Click the upload icon at the top of the iCloud page and select the Mbtiles file.

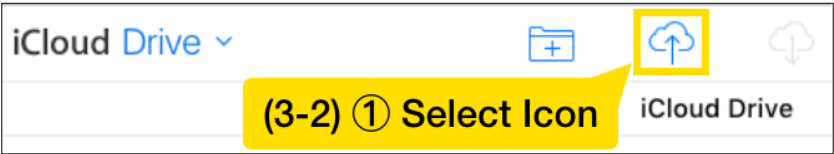

*** If you click the icon, the following window appears.**

Select the desired Mbtiles file and click [Choose] to add the file to iCloud.

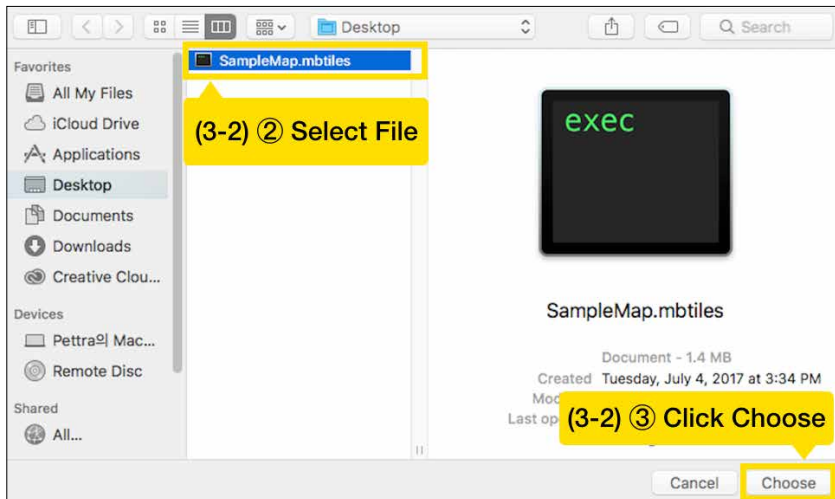

(4) When the upload is complete, you can see that the file has been added.

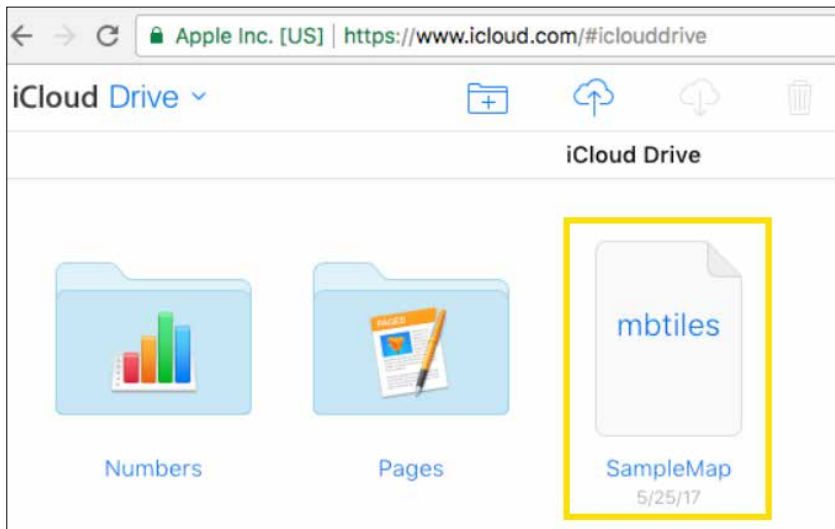

Uploading to Dropbox

Add files from the desktop app.

(1) Install the Dropbox desktop app.

The latest version can be downloaded from '<https://www.dropbox.com/install>'.

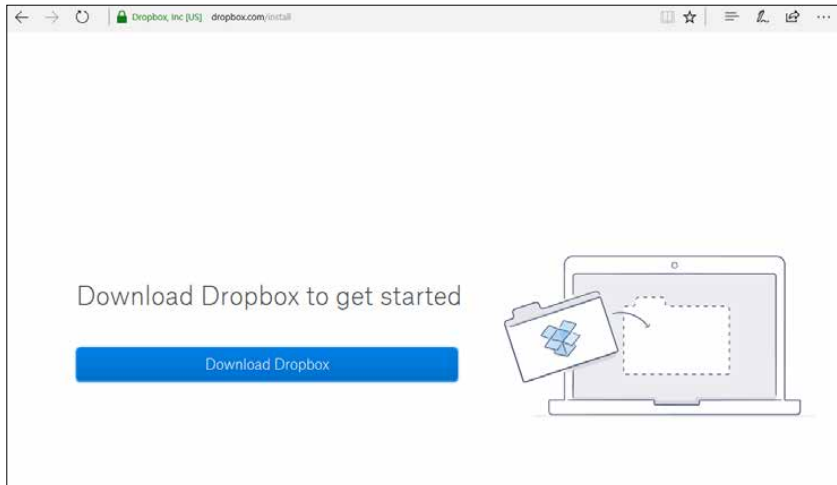

(2) When the installation is finished, open the Dropbox folder from My Computer.

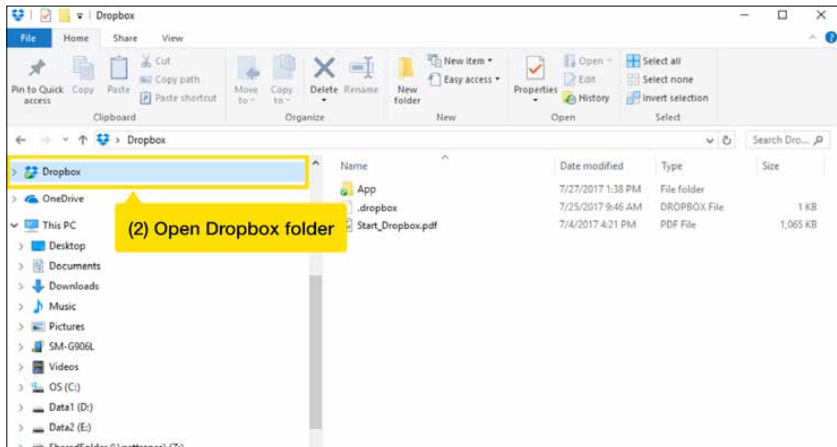

(3) Move the desired Mbtiles file to the Dropbox folder.

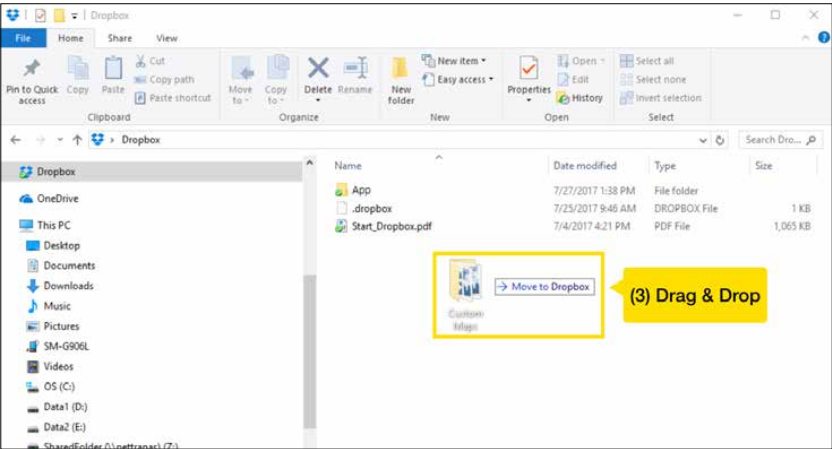

Adding files from a web page

(1) Log in to Dropbox.com.

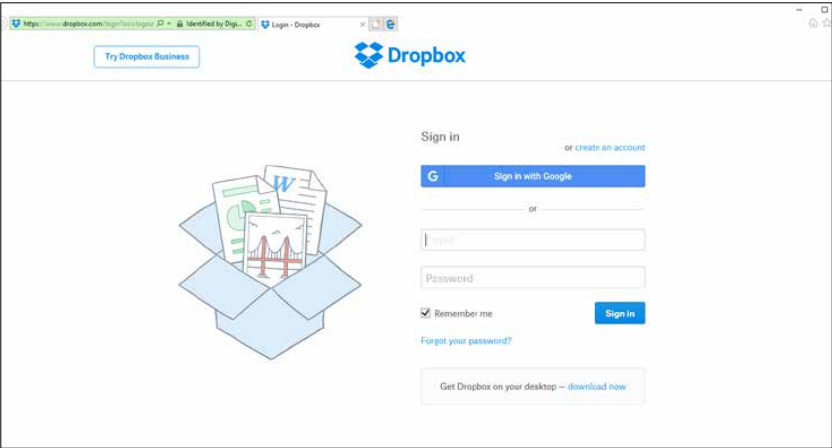

(2) Click the [Upload File] button on the top right corner.

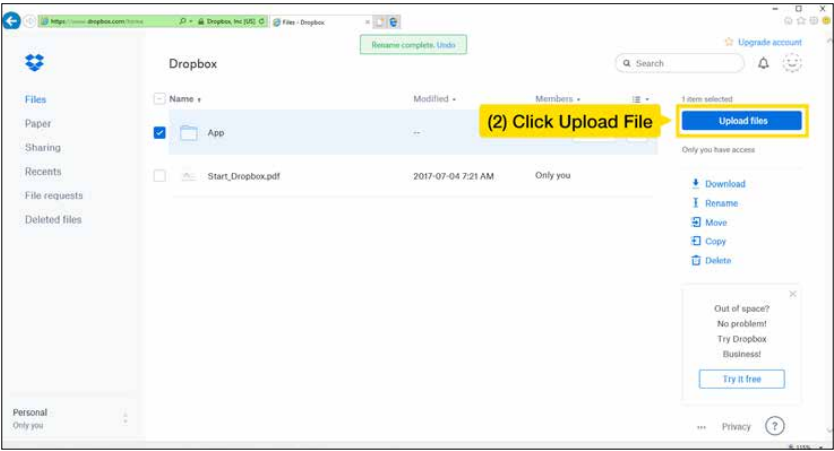

(3) Select the desired Mbtiles file to upload and click [Open] to add them to Dropbox.

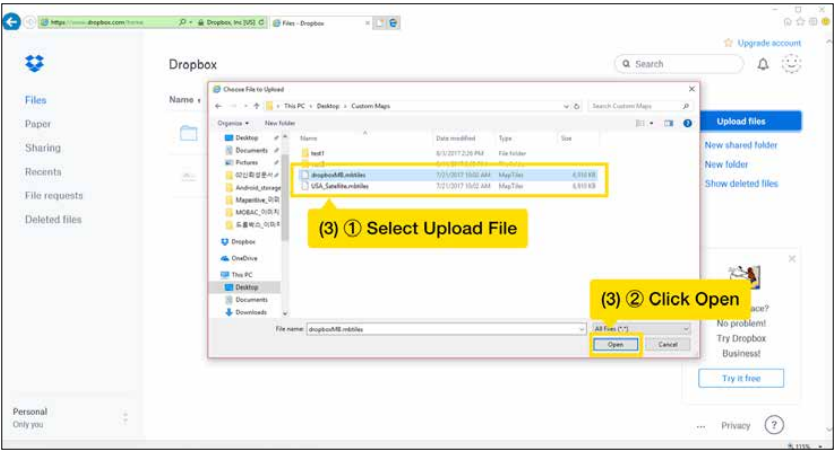

(4) You can also add the files by dragging and dropping them directly into the web browser.

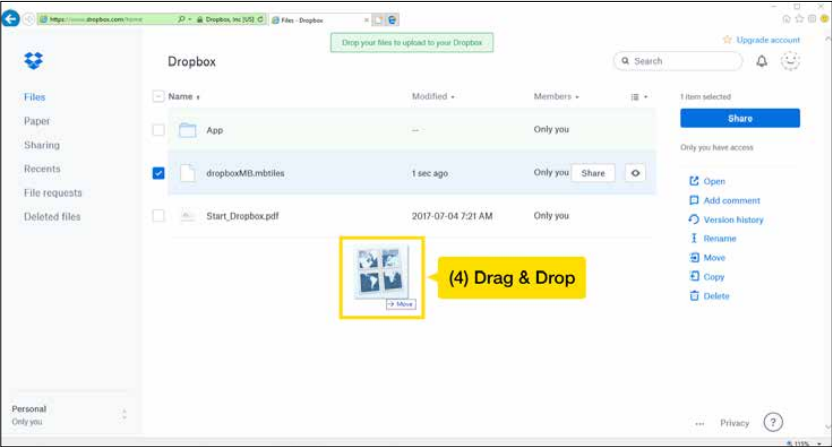

Uploading to Google Drive

(1) Navigate to drive.google.com and sign in with your Google account.

Google accounts can be created at '<https://accounts.google.com/signup>'.

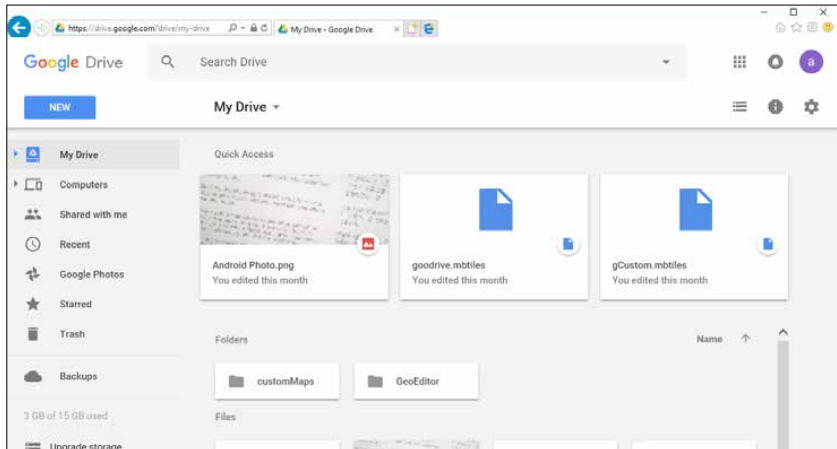

(2) Click the [New] button in the top left corner, then select the Upload File or Folder button.

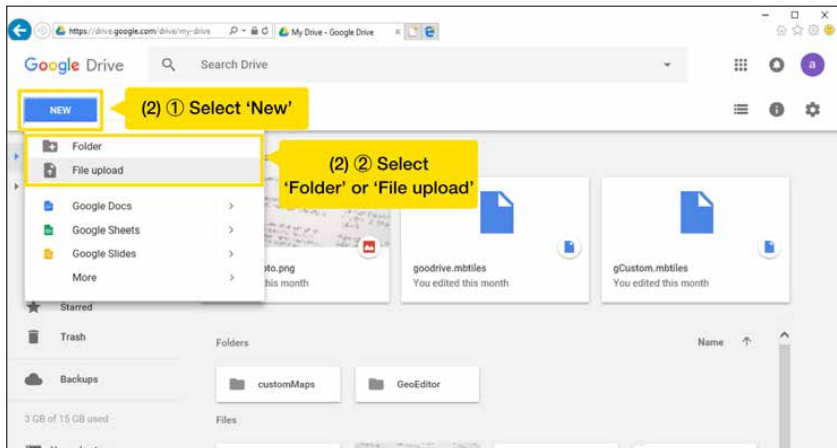

- (3) Select the folder containing the Mbtiles file or the Mbtiles file you want to upload and click [Open] or [OK] to add it to your Google Drive.

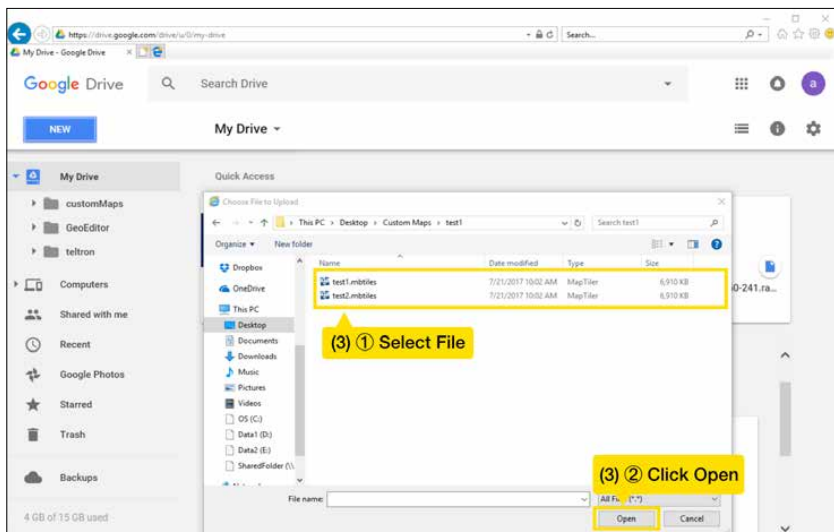

- (4) You can also add the files by dragging and dropping them directly into the web browser.
To learn more about using Google Drive, please visit '<https://support.google.com/drive/answer/2424384?hl=ko&co=GENIE.Platform%3DDesktop&oco=1>'.

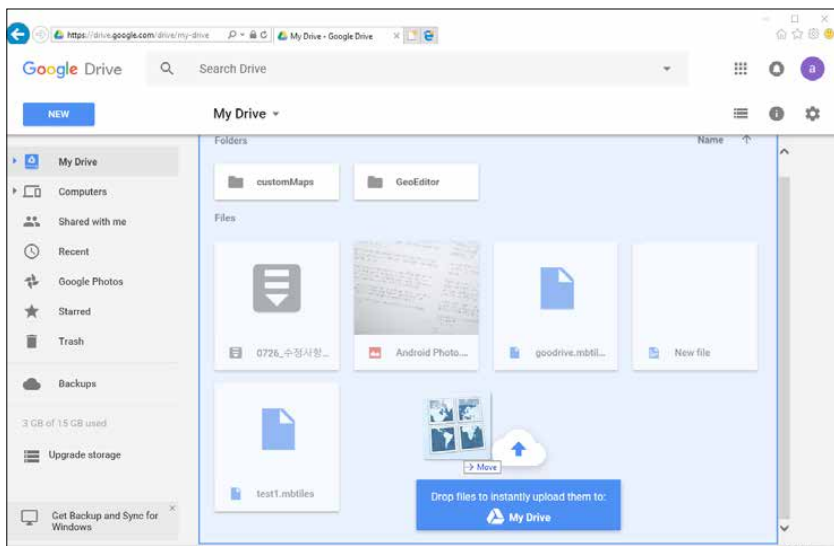

GEO-FENCE



A Geo-fence can be created for a specified area and will be displayed on the Map tab. The dog alerts for the Geo-fence are turned on by default and a notification will appear when a dog exits or enters the Geo-fence. The notification will blink the 'Collar Icon' and app screen, or on the home or lock screen.

- The Geo-fence alerts can be turned on and off in the Settings.

Geo-fence Info ⓘ

The info button displays more information on setting up the Geo-fence.

Saving a Geo-fence

Long press the map to create a Geo-fence point. The Geo-fence points must be created in a clockwise order and cannot intersect. A valid Geo-fence will be displayed in green, while an invalid Geo-fence will be displayed in red and cannot be saved.

Once a valid Geo-fence is created, use the save button to save the Geo-fence on the map. The Geo-fence points can be edited before saving by holding and dragging the points to edit its location.

Multiplex Geo-fence

You can create up to 10 Geo-fences, but they cannot intersect or overlap each other. The overlapped Geo-fences will be displayed in red.

You may create a name for each Geo-fence, which will be used for the fence alarm as well.

Remove a Geo-fence

In the Geo-fence setup window, you may delete the Geo-fence by tapping the center of the fence.

APP SETTINGS

Screen Saver

- The phone screen turns off when covered or in a pocket and turns on when viewed.
- Turn this feature on and off using the On/Off button.
- On Android devices, the screen will turn off when the proximity sensor is covered and turns on when the sensor is exposed.

Shake Control

- Shake your phone to jump between dogs or the main tabs.
- Select between tabs, dogs, and no action.

Volume Button Control

- Use the volume buttons to jump between dogs or zoom in/out on the map.
- Select between zoom, dogs, and no action.

Distance Unit

- The distance is displayed on the main tabs and device list.
- Select between meters and yards.

Speed Unit

- Select between seconds and hours.

GPS Data

- The GPS Data Limit sets how far back the tracks are displayed. If 2 minutes is selected, only the tracks up to 2 minutes will be displayed.
- Select between intervals in 1 to 10 minutes or unlimited.

Tracking Only Mode

The PATHFINDER comes equipped with standard 5/8" contact points that can be replaced with the non-stimulation contacts to disable the e-collar hardware. Set the app to Tracking Only Mode while using the non-stimulation contacts to track only without training features.

- A new history file will begin recording when the Tracking Only Mode is turned on.

Offline Map Data Usage

Turn Offline Map Data on to use cellular data when available with Offline maps. Turn Offline Map Data off to restrict data usage and only display downloaded Offline Maps.

Alarm Setting

< Settings

Alarm Setting

SELECTED COLLAR STATUS

Running

Off

>

Pointing

Off

>

Treed

Selected Collar, Pop Up Message, Voice

>

Bark

Selected Collar, Pop Up Message, Voice

>

GEO-FENCE IN/OUT

Geo-fence In Alarm

Geo-fence Out Alarm

MOBILE-FENCE ALARM

Mobile-fence In Alarm

< Alarm Setting

Pointing

ALERTS

Allow Alerts

Alert target

Selected Collar

Pop Up Message

Vibrate

SOUND

None

Voice

Melody 01

Melody 02

Selected Collar Status

- Set the alert type for dog status changes.
- Separate alert types can be set for each dog status.
- Selected Collar: if you select a collar, the alarm will sound for that collar.
- All Collars: if you do not select a collar, the alarm will sound for all collars.
- The options for alerts are pop up, vibration, and sound, which can be turned on and off.
- Sound alerts include 5 melody options and voice.

Allow Alerts

- Turning off Allow Alerts disables all alerts for the dog status.
- Pop Up Message displays a pop up notification alert.
- Vibrate is a phone vibration alert.
- Sound alerts include 5 melody options and voice. Turn off sound alerts by selecting none.

Mobile-fence alarm

Settings

Alarm Setting

Set Mobile-fence Radius

yards

50

You can set the alarm to sound when the dog enters or exits the Mobile-fence boundary. (1 ~ 2000 meters)

LOW BATTERY WARNING LEVEL SETTING

10%

20%

30%

Done

1

2

3

4

5

6

7

8

9

0

Settings

Alarm Setting

GEO-FENCE IN/OUT

Geo-fence In Alarm

Geo-fence Out Alarm

MOBILE-FENCE ALARM

Mobile-fence In Alarm

Mobile-fence Out Alarm

Set Mobile-fence Radius

yards

50

You can set the alarm to sound when the dog enters or exits the Mobile-fence boundary. (1 ~ 2000 meters)

LOW BATTERY WARNING LEVEL SETTING

10%

20%



The Mobile-fence alarm alerts the user when a dog enters or leaves the preset radius, which can be set to 1 to 2,000 yards or meters. The Mobile-fence alarm will use the same alarm as the Geo-fence.

Geo-fence In/Out

- Turn on/off alerts used with a saved Geo-fence.

Low Battery Warning Level Setting

- The battery warning changes the device icon and displays a notification when the device battery reaches the battery percentage selected.

Bluetooth Pairing

- Begin pairing mode on the phone to pair with the GPS Connector. Use the pairing mode to pair with a new or replacement GPS Connector.

BASIC MAINTENANCE

- Be sure the rubber charging cap is securely in place on the GPS Connector/ Collar when in use.
- Carefully inspect the unit for any missing parts or damage to the casing after use. Damaged or broken casing may affect the waterproof guarantee on the unit.
- The antenna must be securely in place for maximum range.
- Charge the unit for 3.5 hours before storing for extended periods.
- Charge the unit fully once a month while in storage or before use.
- Do not keep the unit exposed to extreme climates.
- Dogtra may include updates and improvements to the PATHFINDER app which can be downloaded through the App Store and Google Play.

TROUBLESHOOTING GUIDE

1. Dog Does Not Respond to Stimulation

- Make sure the receiver/collar is turned on.
- Be sure the strap is on the dog tight enough so that both contact points are touching your dog's skin.
- The contact points may be too short for your dog's thick or long coat. To place an order for longer contact points, please contact Dogtra or a Dogtra dealer. If you are already using longer contact points, you may need to trim the hair on your dog's neck, so that both contact points are touching your dog's skin.
- The intensity level may be too low for your dog. Increase the stimulation until your dog responds, usually by a neck movement, head shaking, or looking over the shoulders. The response may be very subtle.

2. The LED indicator light comes on, but I do not feel any stimulation.

- Your tolerance may be higher than your dog's. We recommend placing both contact points on your inner wrist, where the sensitivity is higher, in order to test the unit.
- The battery may be low. Check the LED indicator lights or the app for battery life.

3. The PATHFINDER has no range or the stimulation is weaker when my dog is farther away.

- Check to see if your fingers are touching the antenna as the range may decrease substantially.
- Keep objects away from touching the GPS Connector antenna as the range may decrease substantially.
- The range indicated is for line-of-sight flat terrain. Heavy brush, trees, hills, buildings, and/or moisture will affect the range of your unit. For the best range, hold the GPS Connector vertically above your head, and/or try moving to higher ground.
- Any electrical conductors will affect the range, such as cars, chain-link dog runs, metal structures, and radio towers. For the best results, operate away from these structures.

4. The GPS Connector/Collar is not holding a charge.

- The charging pin may be damaged. A metal pin inside the charging port should stand straight up and firm in the center. If the pin is wobbly, broken or missing, you will need to send the unit in for repair.
- The charging port must be clean prior to charging, clean out any dirt with a cotton swab and some rubbing alcohol. If your dog was in salt-water, be sure to rinse the GPS Collar and charging port with clean water.
- For Dogtra units over two years old from the purchase date, the batteries may need to be replaced. You can replace them yourself by contacting Dogtra for a replacement battery. Damages incurred to the unit due to improper battery installations are not covered under the warranty. Dogtra strongly recommends sending the unit in for inspection and repair.

5. My dog has skin irritation.

- This may be due to an improper fit or from wearing the collar too long. If your

dog exhibits signs of skin irritation, consult with a veterinarian. Once your dog's skin returns to a normal condition, continue to use the collar and check your dog's neck each time you use the unit.

FCC WARNING

The PATHFINDER complies with part 15 of the FCC Rules. Operation is subject to the following two conditions:

- (1) This device may not cause harmful interference, and
- (2) This device must accept any interference received, including interference that may cause undesired operation.

This is a sensitive radio device. Any unauthorized changes or modifications to this device that are not expressly approved by Dogtra will void the warranty and may void the user's authority to operate the equipment. Please do not tamper or modify the unit.

Radio Frequency Radiation Exposure

This device is a mobile transmitter and receiver that uses an external antenna to send and receive low levels of radio frequency (RF) energy for data communications. The device emits RF energy below the published limits when operating in its maximum output power mode and when used with Dogtra Co. authorized accessories. To comply with RF exposure compliance requirements, the device should be installed and operated with a minimum of 0.2m between the device and your body. The device should not be used in other configurations. This device must not be co-located or operated in conjunction with any other transmitter or antenna.



It has been tested and found to comply with RCM standards.

WARRANTY AND REPAIR INFORMATION

2-Year Limited Lifetime Warranty

Dogtra Company provides the original purchaser with a 2-Year Limited Lifetime Warranty for the 175NCP, 180NCP, 200NCP Gold/C Series, 210NCP Series, 280NCP/C Series, 300M Series, 1400NCP Series, 1500NCP Series, 1600NCP Series, 1700NCP Series, 1800NC Series, 1900NCP/S Series, 2000T&B Series, 2200NCP Series, 2300NCP Series, 2500T&B Series, 2700T&B Series, 3500NCP Series, SureStim Series, ARC Series, COMBO, EDGE RT, and the PATHFINDER. The warranty begins from the date of purchase. For the first two years, coverage is for both parts and labor on warranty repair services.

Accessories such as chargers, splitter cables, antennas, straps, and batteries are covered for the first year only. After the first two years, the Limited Lifetime Warranty covers parts only and does not cover labor fees and accessories. All shipping fees incurred, the cost of accessories after the first year, and labor fees associated with out of warranty repair work are the customer's responsibility. Labor fees will be variable depending on the extent of the work required. The Limited Lifetime Warranty expires 5 years after a model is discontinued from production by Dogtra.

To Qualify for the Dogtra Warranty

All products must be registered and/or a proof of purchase is required to initiate repair work under warranty. To register your Dogtra product, log onto our website at www.dogtra.com, click on the warranty registration link, and fill out the required information. Registration must be completed within 30 days of purchase. If you do not have access to a computer, you can call our toll free number at 1-888-811-9111, and one of our customer service representatives will register the product for you. If you were unable to register your product within 30 days of purchase, we will accept all products for repair with a proof of purchase. We strongly recommend keeping the original receipt. If your product is not registered and a proof of purchase is not available at the time of service, Dogtra will estimate the age of the unit by the serial number. Serial number estimates can differ from the actual purchase date. A serial number estimate is the only method of determining an approximate date of purchase without product registration or a proof of purchase.

Not Covered Under Warranty

Dogtra DOES NOT offer warranty for products that have been bought secondhand or as a resold product. Dogtra DOES NOT replace defective units or provide refunds for products purchased from us after 30 days from the date of purchase. Dogtra DOES NOT cover the cost of shipping outside of the Continental United States. Issues of replacement and refunds on units purchased less than 30 days from an authorized dealer must be addressed to the dealer directly. If the products purchased from an authorized dealer are after 30 days from the date of purchase, please send the units to Dogtra for service and repair.

Dogtra DOES NOT cover the cost of repairs and replacements due to misuse by

the owner or dog, improper maintenance, and/or lost units. Any water damage on the water resistant transmitters of the 175NCP, 180NCP, 200NCP Series, 1400NCP Series, 1500NCP Series, iQ Series, HANDSFREE remote controller, and BALL TRAINER, and the water resistant receivers of the RRS, RRD, RR DELUXE, and BALL TRAINER, will not be covered. All replacement costs for either the transmitter or receiver will be the owner's responsibility.

The warranty is void if the unit has been altered or an unauthorized person has damaged the unit while attempting repair work. Battery replacement by the customer during the first year of the 2-Year Limited Lifetime Warranty is not recommended. If the customer chooses to replace the batteries, any damage to the unit during the change-out by the owner will void the warranty. The removal of serial numbers from any Dogtra products will void the warranty.

Dogtra reserves the right to retain and discard any parts or accessories that have been found damaged upon replacement and repair.

Procedure for Repair Work

If the unit is malfunctioning, please refer to the "Troubleshooting Guide" in the Owner's Manual and call customer service at 1-888-811-9111, for technical support, before sending it to Dogtra for Service. The cost of shipping products under warranty back to Dogtra is the customer's responsibility. Dogtra is not responsible for units damaged or lost in transition to Dogtra. Dogtra is not responsible for loss of training time or inconvenience while the unit is in for repair work. Dogtra does not provide loaner units or any form of compensation during the repair period. A copy of the sales receipt showing the purchase date may be required before warranty work is initiated. Please include a brief explanation outlining the problem and include your name, address, city/state/zip code, daytime phone number, evening phone number, and email address. Or you can visit our website at www.dogtra.com for a service request form. If the repair costs are not covered under warranty, we will call you for payment information and authorization. For any questions concerning your Dogtra products, call us toll free at 1-888-811-9111, M-F 8:00AM - 4:30PM, Pacific Standard Time, or email us at repair@dogtra.com for specific repair inquiries.

Send repair units to Dogtra Company / Repairs
22912 Lockness Avenue, Torrance, CA 90501, U.S.A.

The diagrams and representations in the manual may differ slightly from the actual product depending on the model type.