

USER MANUAL

Dog Training Collar

P-680

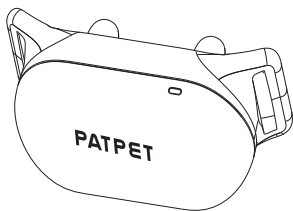

Please read the user manual before beginning.

⚠ WARNING **Not for aggressive dogs.** Do not use this Product if your dog is aggressive, or if your dog is prone to aggressive behavior. Aggressive dogs can cause severe injury and even death to their owner and others. If you are unsure whether this product is appropriate for your dog, please consult your veterinarian or certified trainer.

⚠ CAUTION **Safety during on-leash training.** It is vitally important that you and your dog remain safe while learning on-leash training. Your dog should be on a strong leash, long enough for him to attempt to chase an object, but short enough for him not to reach a road or other unsafe area. You must also be physically strong enough to restrain your dog when he tries to chase.

⚠ CAUTION **Risk of skin damage.** Please read and follow the instructions in this manual. Proper fit of the collar is important. A collar worn for too long or made too tight on the pet's neck may cause skin damage. Ranging from redness to pressure sores.

- Avoid leaving the receiver on the dog for more than 6 hours per day.
- When possible reposition the receiver on the pet's neck every 1 to 2 hours.
- Check the fit to prevent excessive pressure; follow the instructions in this manual.
- Never connect a lead to the electronic collar; it will cause excessive pressure on the contacts.
- When using a separate collar for a lead, don't put pressure on the electronic collar.

- If a rash or sore is found, stop using the collar until the injured part is healed.
- If the condition persists over 48 hours, see your veterinarian.

These steps will help keep your pet safe and comfortable. Millions of pets are comfortable while they wear stainless steel contacts. Some pets are sensitive to contact pressure. You may find after some time that your pet is very tolerant of the collar. Then, you may relax these precautions. It is important to continue daily checks of the contact area. If redness or sores are found, discontinue using until the skin fully healed.

COMPONENTS

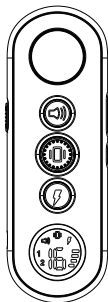

Remote
(Transmitter)

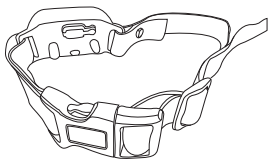

Receiver

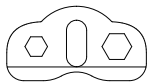

Test Light

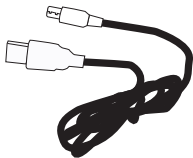

Charger Cable

OVERVIEW

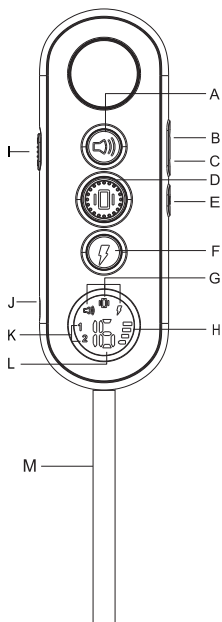

Remote

- A. Tone Button
- B. Shock Level +
- C. Shock Level -
- D. Vibration Button
- E. On/Off Button
- F. Shock Button
- G. Mode indication
- H. Battery Display
- I. Switch dog 1 or dog 2 mode
- J. Charging Port
- K. Dog 1 or dog 2 mode
- L. Shock Level Display
- M. String

Receiver Collar

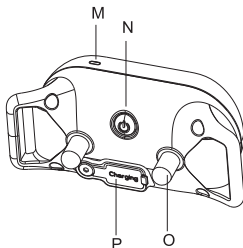

- M. LED Indicator
- N. On/Off Button
- O. Contact Points(x2)
- P. Charging Port (with cover)

Prepare the Remote & Receiver

Turn ON/OFF the Remote

1. Long press the ON/OFF button to turn the remote ON.
2. LCD will be lighted, and show the information of current channel, battery power and levels. If not, please charge the remote.
3. Long press the ON/OFF button to turn the remote OFF.

Turn on the Receiver Collar

- Press the On/Off Button the Green LED light comes on.
- In normal mode, the Green LED will flash every 4 seconds, indicating the Receiver Collar is on and ready to receive a signal from the Remote.





Turn off the Receiver Collar

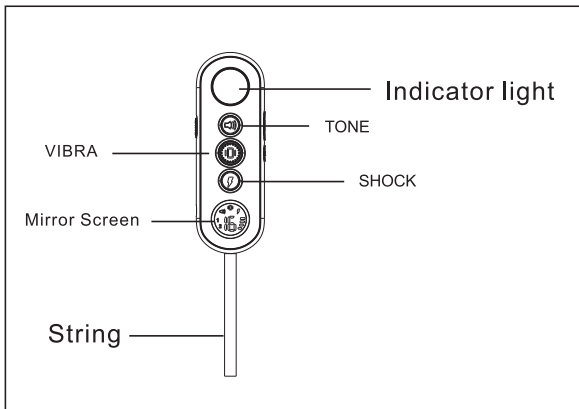

- Press long the On/Off Button until the Red LED light shuts off (This takes approximately 3 seconds).
- Release the On/Off Button.

NOTE:



To extend the life of the batteries, please turn the Receiver Collar off when it is not in use.



1. Press  or  or  once to send a vibration, sound, shock command to Receiver Collar.
2. Press and hold  or , Receiver Collar will have a continuous vibration/shock, It will stop automatically after 10 seconds.

Note: Do NOT press and hold  or  for long time to avoid physical or psychological hurt to the dog.

Dog 1/2 Button

1. Toggle  once to switch between Dog 1 and Dog 2.
2. Press “  ” to adjust Shock Level from 1-16.

● Assemble the Collar Strap

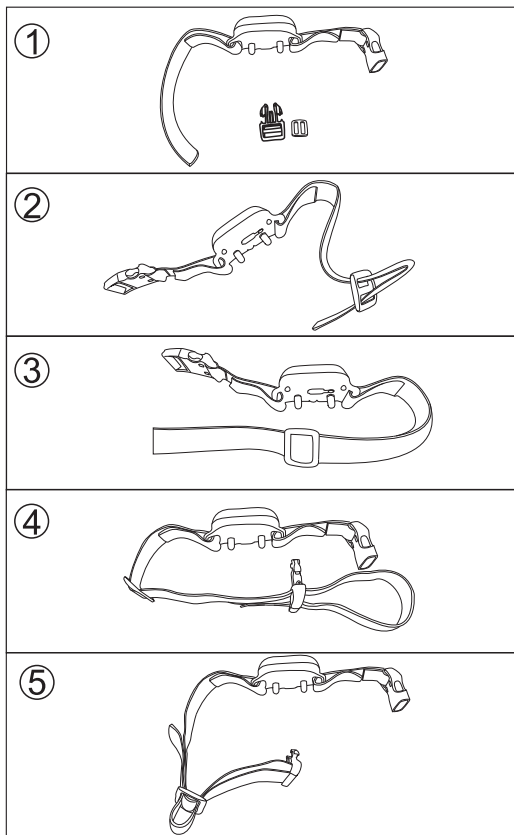

⑥

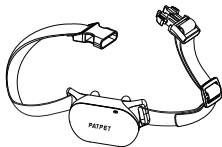

○ Wear the Collar Receiver

Remark: The proper fit and placement of your training collar is important for effective operation. The contact points must directly touch the neck skin of your dog.

1. Start with the collar turned off and your dog standing comfortably, not sitting(A).
2. Put the receiver collar directly under the chin of your dog. Make sure both the contact points are in the center of your dog's neck and contacted his neck.

NOTE: Sometimes it's necessary to trim the hair around the contact points to make sure that contact is consistent.

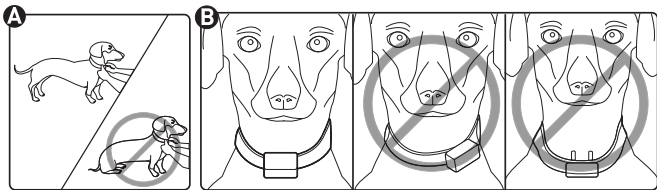

● How to Find the Best Shock Level

The unit comes with Up and Down buttons to control the Shock Level, with Level 1 being the lowest level for Shock and Level 16 being the highest for Shock.

Better adjust the Shock level suitable for your dog according to his acceptance limitation for shock. Always start at the lowest level and work your way up.

The appropriate level can be found when the dog responds to the Shock with a mild reaction, such as a tensing of the neck muscles. The Shock Level may vary depending on the training situation. When highly distracted, dogs will require a higher level of Shock.

● To Maximize the Remote Distance

The unit has a 300 - meter range. The range may vary depending on the way of the Transmitter being held. Hold the Transmitter away from your body to receive the greatest range. For maximum signal strength, keep the device properly charged.



Maximum range





Typical range





Minimum range

*Avoid touching the antenna, as the range may decrease substantially.

BUTTON & INDICATOR

	<p>Indicates Shock levels ranging from 1-16, Appears in the right lower part.</p>
	<p>Indicates the active dog receiver. Appears in the left part.</p>
	<p>Indicates battery's power level. Note: The battery icon will flash when battery is low .</p>

Remote	Button Function	Indicator
	<p>Delivers audible tone to collar (volume cannot be adjusted)</p>	<p>Green</p>
	<p>Delivers vibration to collar. (vibration will pause if keep pressing for more than 10 seconds)</p>	<p>Orange</p>
	<p>Delivers shock to collar base on current level (shock will pause if keep pressing for more than 10 seconds)</p>	<p>Red</p>

Receiver	Indicator
Power On	Flashes once
Normal operation - Good battery	Flashes once every 5 seconds
Tone	While pressed, light flashes green
In pairing mode	Flashes once every second for 15 seconds
Complete Pairing	Flashes rapidly for 3 times
Complete Charging	Light stays green
Power Off	Flashes red for 2 times
Normal operation - Low battery	Flashes red rapidly till auto power-off
Vibration/Shock	While button is pressed, the light flashes red
Charging	The light stays red

CHARGING

The unit had a partial charge when it left our facility. Upon receiving the collar, be sure to give it a 4-hour initial charge before the first use.

Note:

- a . While Transmitter is charging, the battery icon on the screen will scroll and the indicator light will be red. When fully charged, the light will flash red .
- b . While Receiver is charging, the indicator will also be red, but when finished, it will become green.
- c . Do not charge the unit near any flammable substance .

TEST

1. Turn on the Receiver Collar.
2. Hold the Test Lamp contacts against the Contact Points.
3. Press the Shock Button and the Test Lamp will be lighted. It will be lighter accordingly with the Shock Level increasing.

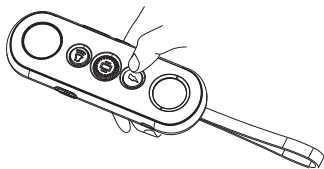
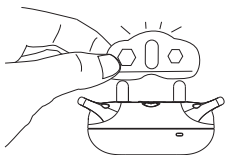

PAIRING

1. Use the  switch on the Remote to select Dog 1 .
2. With the Remote turned on and the Receiver Collar turned off, press and hold the ON/OFF Button on the Receiver Collar for 4-5 seconds.
3. The Red & Green LED will blink for about 10 seconds indicating that it is ready for pairing.
4. Press and hold Tone Button and Vibration Button at the same time for 2-3 seconds, the Green LED on the Receiver Collar will blink for 5 times indicating successful pairing.

Pairing a Second Collar with the Remote

Use the  Button on the Remote to select Dog 2.
Then follow the above pairing steps from 2-4.

TIPS

- Pets should be at least 6 months old before using the Training Collar.
- Be sure to let your pet associate the collar with happy things.
- Using a treat and a praise AS SOON AS the dog obeys the command, as positive training is better than negative training. Adding the treat helps reinforce the good behavior. The object of the collar is do not of need to use it.
- It's NOT A TOY ! Only responsible family members can use the Training Collar, so that your pet will not be confused
- If your pet reacts to the collar by hiding or acting fearfully, check the settings as they may be too high for your pet's needs.
- It is recommended to train one dog at a time in a distraction-free environment, both to increase efficiency and to avoid temptation or distraction from other dogs.

⚠ WARNING

Never use the Remote Training Collar to correct or eliminate any form of aggressive behavior. We recommend you to consult your local veterinarian or professional trainer to determine if your pet might be aggressive.

Is the Shock safe for my pet ?	While the Shock is unpleasant, it is harmless to your pet. Electronic training devices require interaction and training from the owner to achieve desired results.
How old does my pet have to be before using the Remote Training Collar?	Your pet should be able to recognize basic obedience commands such as "Sit" or "Stay". Pets should be at least 6 months old before using the Training Collar.
Once my pet has obeyed my commands, will he still continue to wear the Receiver Collar?	Probably not. But we suggest you to reinforce dog's good behaviours regularly.
Is the Receiver Collar waterproof?	Yes.
Will I get exact 300 meters of range with the Remote Training Collar?	The range of the Remote Training Collar will be affected by terrain, weather, vegetation, as well as other electronic devices such as radio.
How long can I continuously deliver Shock to my pet?	The maximum time you can press the Shock Button and deliver Shock to your pet continuously is 10 seconds. After this, Shock cannot be delivered until you release and press the button again.

<p>My pet does not respond when I press a button.</p>	<ul style="list-style-type: none"> • Make sure the Receiver Collar has been turned on. • If the range reduces compared to the first time you used, the battery of the Transmitter or Receiver may be low. • Terrain, weather, vegetation, transmission from other radio devices and many other factors can impact the amount of range. • Test the Receiver with the Test Light to confirm if shock function is normally. • Increase the Shock Level. Refer to “How to find the best Shock Level” for more information. • Make sure the Receiver Collar’s Contact Points are placed snugly against your pet’s skin. Refer to “Collar fitting” for more information.
<p>The Receiver Collar will not turn on.</p>	<ul style="list-style-type: none"> • Make sure the Receiver Collar has fully charged. For the initial charge, be sure to charge it for 4 hours. Subsequent charges only take 2-3 hours.
<p>The Receiver Collar is not responsive to the Remote Transmitter.</p>	<ul style="list-style-type: none"> • Verify if the Receiver Collar is on. • Verify if the battery of the Transmitter is fully charged. • Verify if the training collar has been paired.

WARRANTY

1-Year Warranty

The original purchaser for this unit is provided with 1-YEAR WARRANTY.

The warranty begins from the date of purchase. For the first year, coverage is for both Parts and Labor on warranty repair services, but the return postage is for the buyer's account.

Accessories such as chargers, splitter cables, antennas, straps, and batteries are covered for the first year only. When the warranty expires, customers will need parts and repairs at their own expense.

To Qualify for the Warranty

All products must provide a proof of purchase in order to initiate repair work under warranty. We strongly recommend keeping the original receipt. If the proof of purchase is not available, we will estimate the age of the unit by the S/N number. but it will be the only method that we judge your order time.

Won't Qualify for 1-Year Warranty

We DO NOT offer warranty for products that have been bought secondhand or as a resold product.

Issues of replacement and refunds, if units are kept less than 30 days from an authorized dealer must be addressed to the dealer directly. If more than 30 days, please send the units to us for after-sale.

Manual damage or loss is not covered by the warranty.

Any water damage on the Water Resistant Transmitters and the Water Resistant Receivers of our product series will not be covered. All replacement costs for either the transmitter or receiver will be the owner's responsibility.

The warranty is void if the unit has been altered or an unauthorized person who attempting to repair work has damaged the unit.

Replacement of batteries is not recommend during the warranty period. If the customer chooses to replace the batteries, any damage to the unit during the change-out by the owner will make the warranty void. We reserve the right to retain and discard any parts or accessories that have been damaged upon repairing.

Procedure for Repair Work

If the unit is malfunctioning, please refer to the “Troubleshooting Guide” in the Operating and Training Guide before sending it back for Service. The cost of shipping products under warranty is the customer’s responsibility. We are not responsible for units damaged or lost in transition. We are not responsible for the loss during training while the unit is under repairing. We do not provide renting units or any form of compensation during repairing.

A copy of the sales receipt showing the purchase date may be required before warranty work is initiated. Please include a brief outline of the problem and include your name, address, city/state/zip code, daytime phone number, evening phone number, and email address.

Compliance FCC - USA

This device complies with part 15 of the FCC Rules. Operation is subject to the following two conditions:
(1) This device may not cause harmful interference.
(2) This device must accept any interference received, including interference that may cause undesired operation.

CAUTION: Modification or changes to this equipment not expressly approved by Patpet Technology Co., Ltd may void the user’s authority to operate the equipment.

NOTE: This equipment has been tested and found to comply with the limits for a Class B digital device, pursuant to part 15 of the FCC Rules. These limits are designed to provide reasonable protection against harmful interference in a residential installation. This equipment generates, uses, and can radiate radio frequency energy and, if not installed and used in accordance with the instructions, may cause harmful interference to radio communications. However, there is no guarantee that interference will not occur in a specific installation. If interference does occur to radio or television reception, which can be determined by turning the equipment off and on, the user is encouraged to try to correct the interference by one or more of the following measures:

- Reorient or relocate the receiving antenna.
- Increase the separation between the equipment and the receiver.
- Connect the equipment to an outlet on a circuit different from that to which the receiver is connected.
- Consult customer care, the dealer, or an experienced radio/TV technician for help.

PATPET

 <https://patpet.us/>

 support@patpet.com

 @PATPET

 1-855-888-9922



MADE IN CHINA

