

USER MANUAL

Model U01

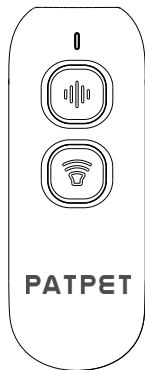

Ultrasonic Training Remote

Please familiarize yourself with the device for the safety of your pet !

WARNING

Dogs with a more sensitive personality may behave irritably or out of control because of fear after hearing sound waves. We recommend that you make sure that you have a safe distance from your dog when you use this product for the first time.

TECHNICAL SPECIFICATIONS

Material Quality	ABS+PC
Operating Range	Up to 10 Ft
Product Dimensions	96*35*32.5mm
Battery	AAA Alkaline Battery * 4
Acoustic Emission	23KHz~27KHz
Product Weight	47g

* Average hearing frequency range for Human is 20Hz~20KHz and for Dog is 15Hz~120KHz.

WORK PRINCIPLES

This mini Ultrasonic Training Remote is made with Ultrasonic Technology. When the dog has unwanted behaviors, you can press the Ultrasonic Button, then your dog will hear a special sound, which will make him a little uncomfortable. After repeating for a few times, dog will learn that his behavior will bring uncomfortable feeling to himself. Remember that every time your dog stops his problem behavior, treat him at once. In this way, you will soon be able to shape your dog more polite.

DISPLAY

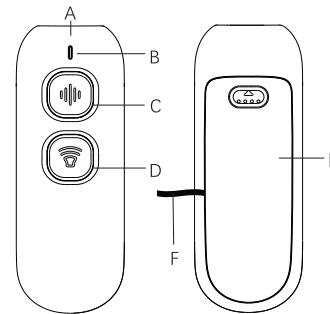

- A. Ultrasonic Emission Port
- B. Indicator Light
- C. Ultrasonic Button
- D. Tone Button
- E. Battery Cover
- F. Battery Drawstring

OPERATION

Install Battery

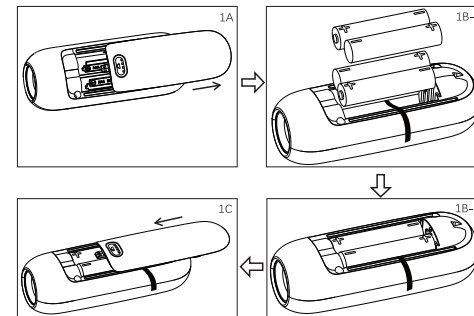

Note:

1. If the device will be idle for a long time, please remove the batteries.
2. Before installing the batteries, please make sure the Battery Drawstring under the battery.
3. When you replace new batteries, just pulling the Battery Drawstring up to make the replacing process easier.

Function Test

After the batteries are installed, take a small thin piece of paper such as toilet paper in a quiet and windless environment and place it on the Ultrasonic Emission Port, and press the Ultrasonic Button a few times. Under normal circumstances, the paper will slightly shake due to the emission of sound waves. At this time, you will also hear the faint sound of sound waves emitted.

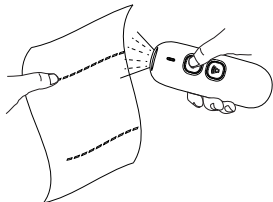

Note

1. Please aim at a corner of the paper to test ,so as not to produce the effect.
2. This test method is only valid for Ultrasonic mode.

Protection Mode

If you press and hold the Ultrasonic Button for 10s, the device will stop emitting ultrasonic and enter into protection mode. Press the Ultrasonic Button again and it will work normally.

Low Battery Reminder

In the standby state, if the indicator light starts to flash red once every 5s, or the indicator light flashes red 3 times quickly when the Ultrasonic Button/Tone Button is pressed, it means that the battery is low. Please replace the battery in time to ensure that the product works normally.

NOTE

1. Different dog breeds may react to the ultrasonic sound differently.
2. The product may not be effective on dogs with hearing problems.
3. Do not use the device against your ear for testing.
4. This device is not a toy, keep out of reach of children.
5. Do not submerge the unit in water or any other liquid.
6. We recommend you to use the Tone mode firstly when you find your dog's problem behavior. If your dog has no response to this mode, you can try the Ultrasonic mode, as the Ultrasonic waves will make the dog a little uncomfortable.
7. If used frequently, dogs may become immune to the sound waves, so be sure to use the device at the right time and complete the behavior training before your dog becomes immune.

1-YEAR WARRANTY

If there is a quality issue on the item, please send the info below to **support@patpet.com** to qualify for the warranty.

1. The order screenshot covering order ID
2. A short video or pics to show the problem
3. Your shipping address

After confirming your product is within One-Year Warranty, we will replace one new for free.

COMPLIANCE FCC - USA

1. This device complies with part 15 of the FCC Rules. Operation is subject to the following two conditions:
(1) This device may not cause harmful interference.
(2) This device must accept any interference received, including interference that may cause undesired operation.

CAUTION: Modification or dismantling to this equipment not expressly approved by Manufacture may void the user's authority to operate the equipment.

DISCLAIMER

We have the right to modify any information any time contained in this manual Without prior notice and without any liability. We shall not be liable for any consequences caused due to failure to follow the relevant instructions on this manual. We reserve the right for the final interpretation on this manual.

PATPET

Rooted in R&D of Pet Training Supplies since 2014

 <https://patpet.com>

 @PATPET

 1-855-888-9922

 support@patpet.com



MADE IN CHINA