

# Castle Cat House & Scratcher

CW-10273

02/10/23 V2

This Package Contains

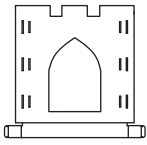

A x 2

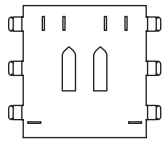

B x 2



C x 2

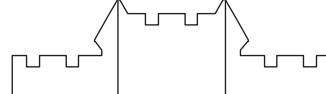

D x 1

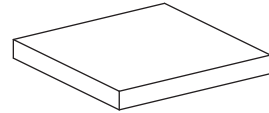

E x 2

## Completed Item

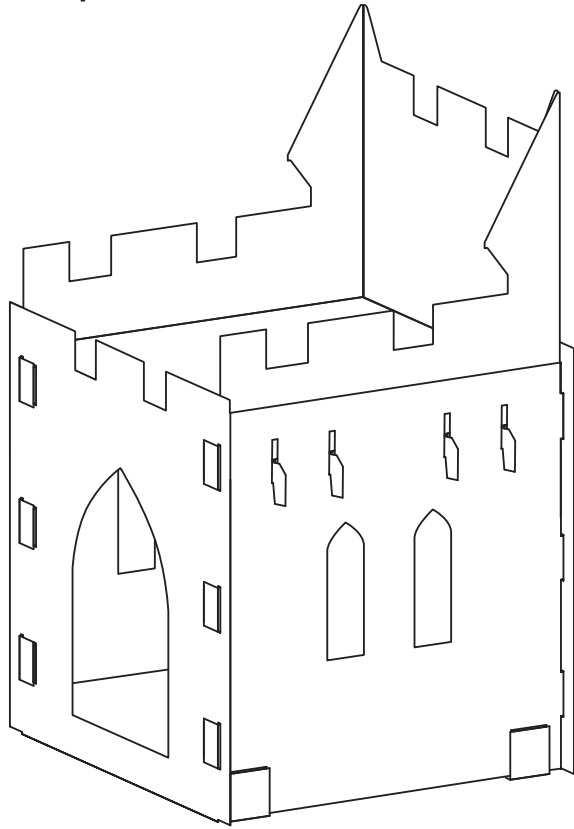

## Step 1

Assemble **Panels (A)** and **(B)** as pictured below. Insert the tabs of **Panels (B)** through the large slots in panels **(A)**.

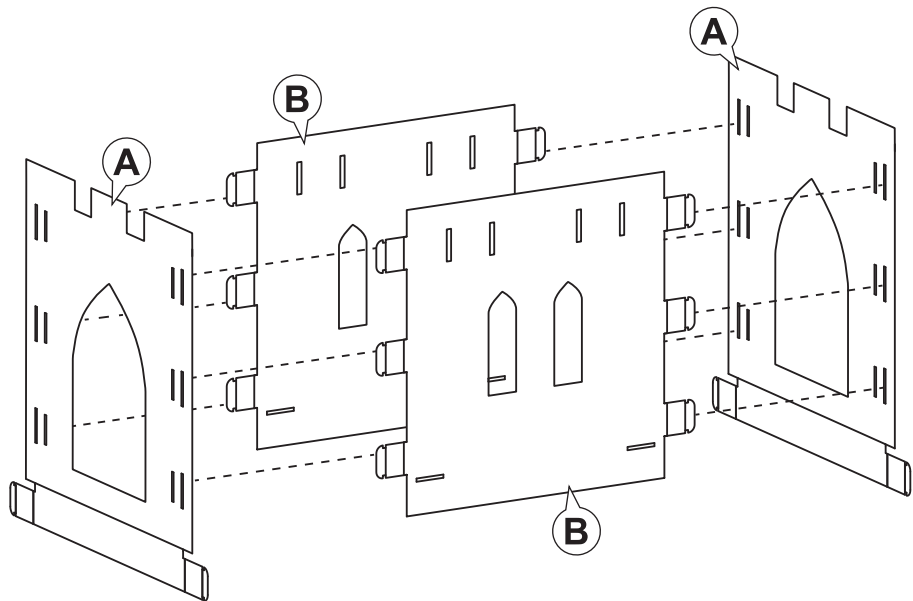

## Step 2

Fully insert tabs into **Panels (A)**, then wrap the tabs around and insert into the small slots as detailed below. Repeat on the back side.

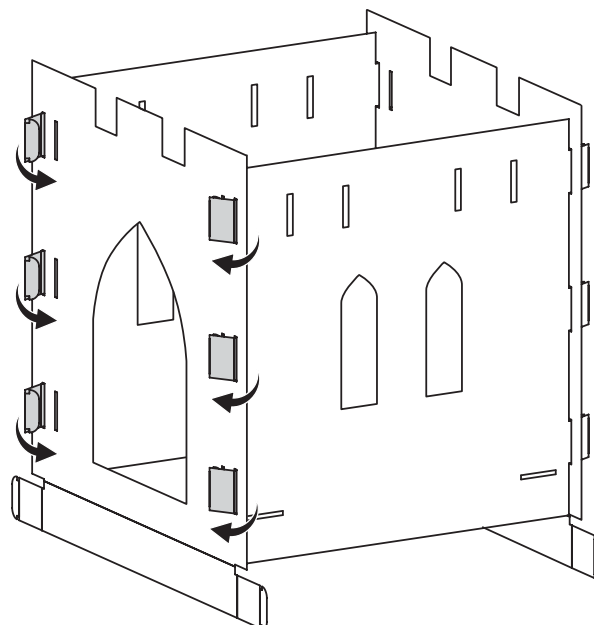
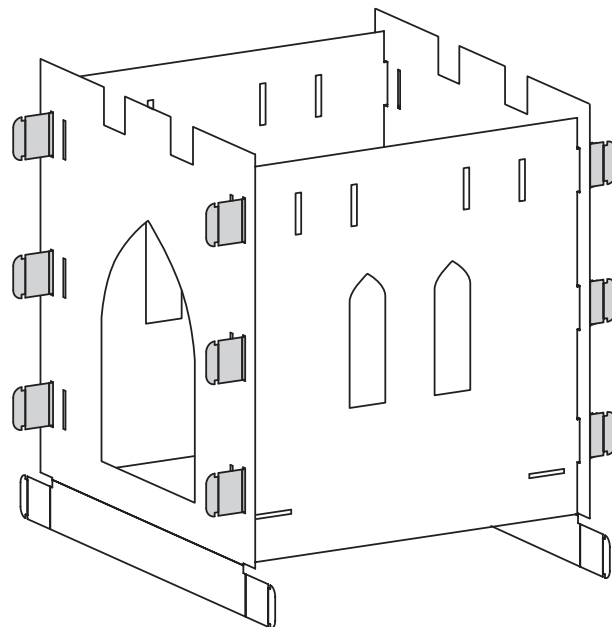

Line up tab with large outer slot.

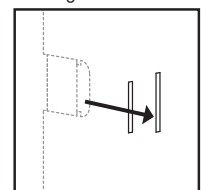

Push completely through.

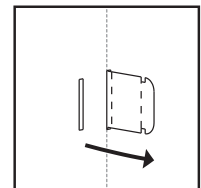

Fold front and insert tab into small slot.

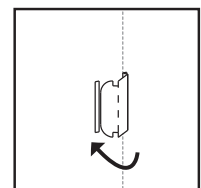

### Step 3

Place **Combined Panels** over **Scratcher (E)**.

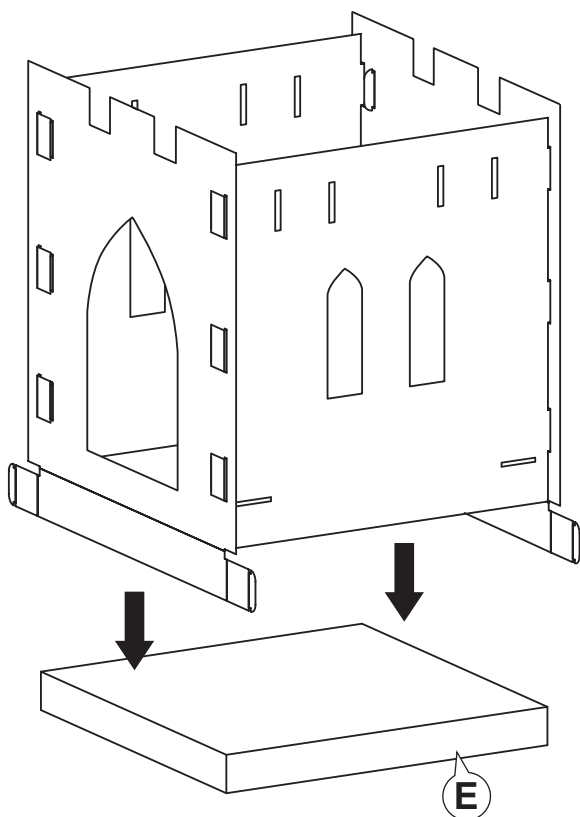

### Step 4

Fold bottom flaps of **Panels (A)** under **Scratcher (E)**. Fold front and back tabs up, and insert into the slots of **Completed Panels** as pictured below.

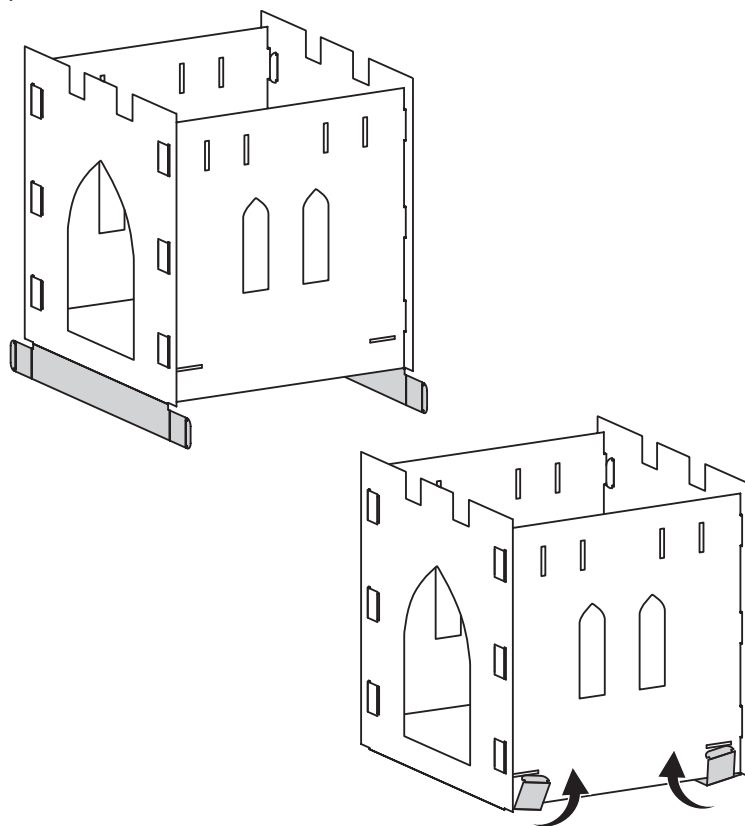

### Step 5

Fold **Platforms (C)**, and while holding tight, insert into slots on top of **Completed Panels** as shown.

Fold over **Panel (1)** and then fold **Panel (2)** underneath it. **Hold Closely Together.** Repeat on other side.

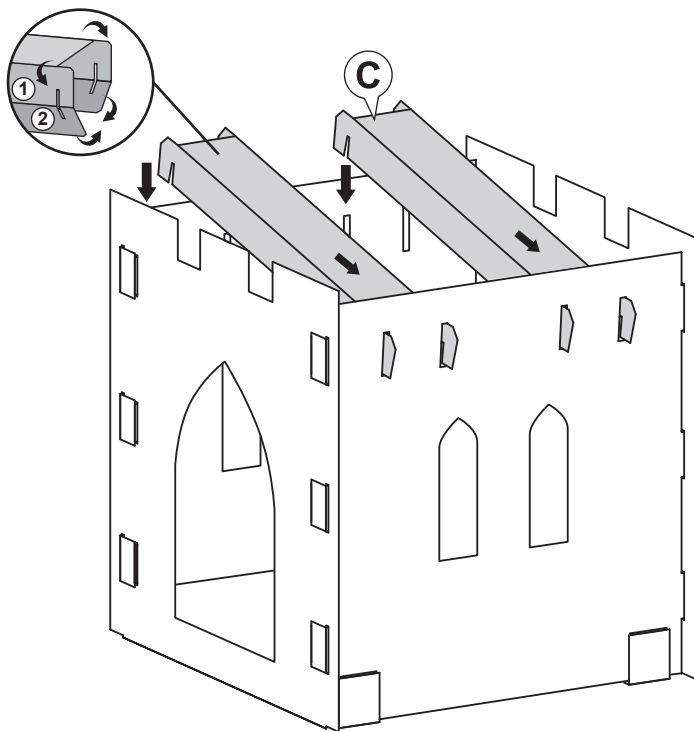

### Step 6

Fold sides of **Top Panel (D)** and insert it onto the **Completed Panels** as shown. Add second **Corrugate Board (E)**. This corrugate board is held in place by the platforms below it.

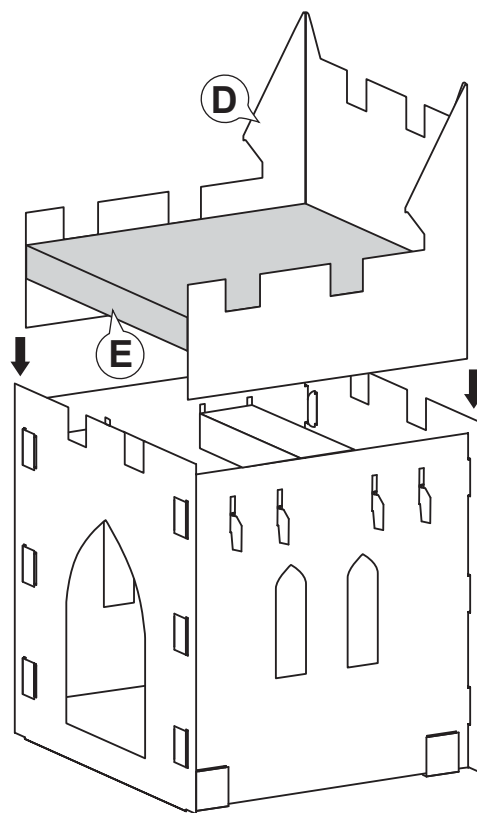

Because every cat is different, it is important to monitor your cat's behavior with this product. If at any time your cat damages this item, or any portion of this item becomes damaged, remove the damaged portion or discontinue use of the product.

### QUESTIONS?

Call our friendly customer service team any time. We're here 24/7! 1-800-67-CHEWY (672-4399)