

QUICK START GUIDE

Trainer Dog Collar, Waterproof, Rechargeable, 430 Yards Range

Make sure to read this guide carefully and review the warnings and battery-handling instructions in the full instruction manual prior to setting up and using the product.

How the Collar Works

This training collar delivers tone, vibration and static corrections at the touch of a button, with 100 adjustable levels of vibration and static stimuli. Always start from the lowest level and increase it until you reach the level that's best for your dog.

Components

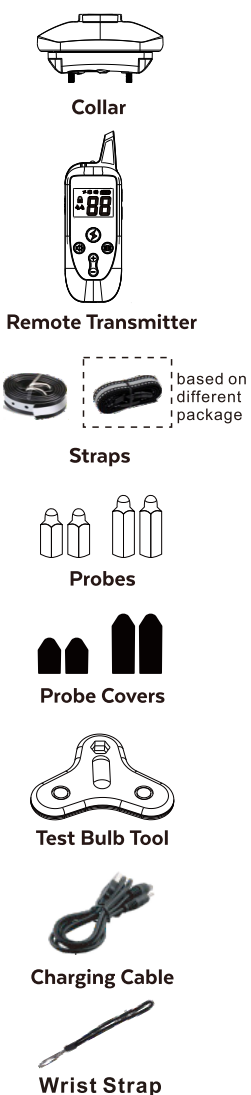

Remote Transmitter

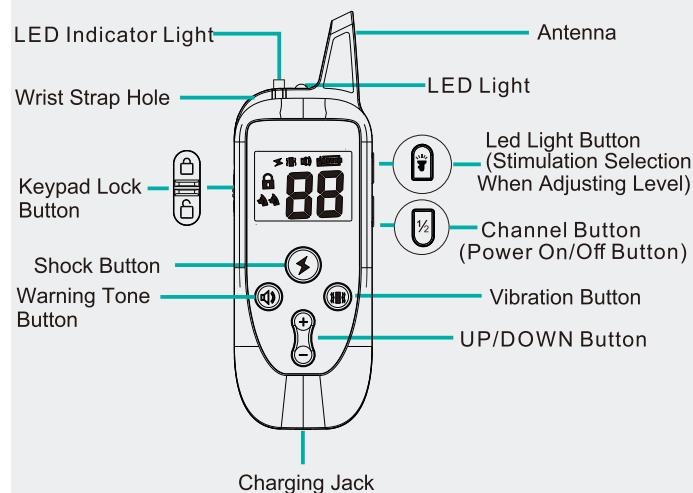

Receiver

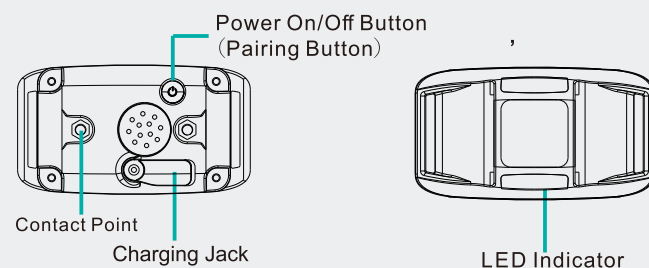

Installing the Probes

Install the proper probes and covers. Use the test bulb tool to tighten the probes until snug.

For short-hair dogs, use the short probes.

For long-hair dogs, use the long probes.

Attaching the Straps

1. Feed the strap through the openings on the collar and through the slide adjuster.
2. Pull the strap through the clip on the other end of the strap.
3. Slide the strap back through the slide adjuster.

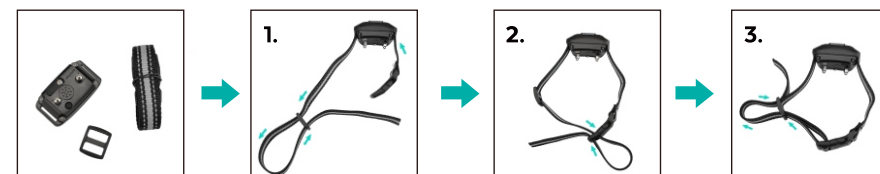

Charging the Transmitter & Receiver

Prior to use, charge the transmitter and receiver for at least 3 hours.

1. Plug the USB cable into a PC, power bank or adapter.
2. Lift the rubber cover on the receiver and plug in the large connector.
3. Plug the small connector into the charging jack on the transmitter.

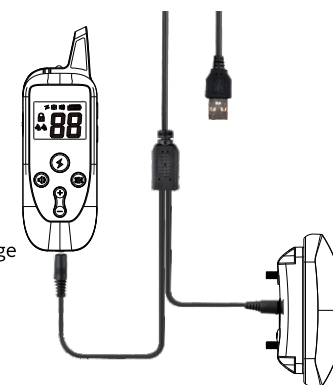

Power on the Transmitter

Press and hold the channel button for 2 seconds to turn the transmitter on or off.

- The display will turn off after 2 minutes of inactivity.
- Press any button to reactivate the transmitter.

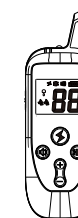

Power on the Receiver

Press and hold the power button for 2 seconds to turn the receiver on or off.

- The receiver will vibrate and the green LED light will blink when powered on.

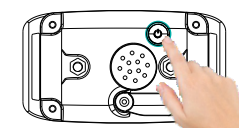

Testing the Transmitter & Receiver

Test the warning tone and vibrate functions by pressing those buttons. The receiver should respond with warning tone or vibration.

Test the shock command by holding the test bulb tool to the contact points on the receiver and pressing the shock button. The test bulb tool should light up.

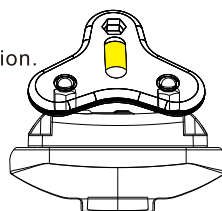

Fitting the Receiver

1. Turn off the receiver.
2. With your pet standing, put the collar around their neck where a normal collar would sit.
3. Center the contact points on the front of your dog's neck.
4. Tighten the collar until you can fit only one finger between the collar and your dog's neck.

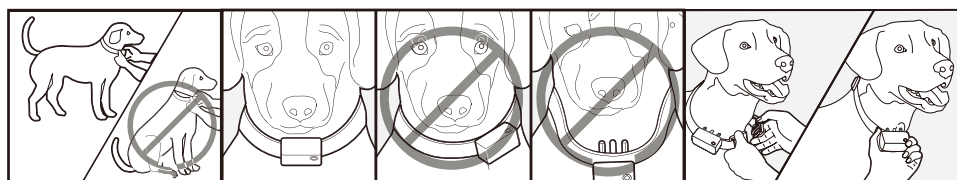

Operating the Transmitter

How the Transmitter Works

Press the beep, shock or vibrate button once to send a short command to the receiver.

Press and hold the beep, shock or vibrate button to send a continuous command to the receiver. The command will automatically stop and reset after 10 seconds.

NOTE: To avoid distress, it is not recommended to deliver extended shock and vibration commands.

If you have two receivers, select channel 1 or channel 2 on the transmitter first, then operate the beep, shock or vibrate buttons and the receivers will respond accordingly.

Transmitter Display

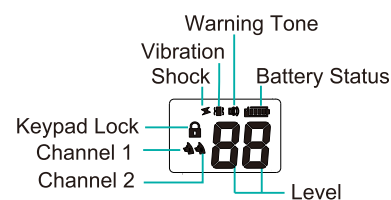

	Shock Mode
	Warning Tone Mode
	Vibration Mode
	Battery Level
	Shock/Vibration Stimulation Level
	Warning Tone Stimulation Level
	Channel
	Keypad Lock

Maximizing Operating Distance

To maximize range:

1. Keep the receiver and transmitter properly charged.
2. Hold the transmitter high with the antenna vertical.
3. Avoid touching the antenna during operation.

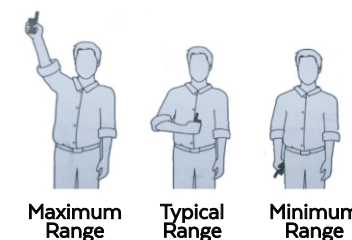

Frequently Asked Questions

Q: Is the stimulation safe for my pet?

A: While static stimulation is unpleasant, it is harmless to your pet.

Q: How old should my pet be before using this product?

A: Pets should be at least 6 months old before using this product.

Q: Once my pet is trained, will they have to keep wearing the collar?

A: Probably not, but you may need to reinforce training with the receiver collar from time to time.

Q: Is the receiver water resistant?

A: Yes. It is IP67 Waterproof rated, but make sure the charging area is dry. The transmitter is not waterproof.

Q: Will I get exactly 100% of range with this product?

A: The range varies according to terrain, weather, vegetation and transmission from other radio devices.

Q: How long can the product deliver continuous stimulation?

A: The max continuous stimulation is 10 seconds. The transmitter times out after 10 seconds.

Troubleshooting

My pet does not respond when I press a button.

- Make sure the receiver is on.
- Ensure that the receiver and transmitter are charged.
- Many factors impact the range. Review them in the manual.
- Test the receiver again to ensure it is working.
- Increase the stimulation level.
- Make sure the probes with covers touch your dog's skin.

The receiver will not turn on.

- Make sure the receiver has been charged for at least 2-3 hours.

The receiver is not responding to the transmitter.

- Make sure the receiver is on.
- If the indicator light is blinking rapidly, recharge the receiver.
- Review the manual section on pairing the receiver and transmitter.