

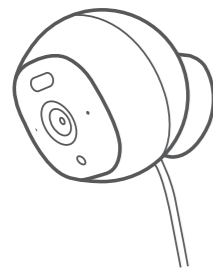

## QUICK START GUIDE

Solo OutdoorCam C22 / C24



### Product Overview

#### Outdoor Cam Pro / Outdoor Cam

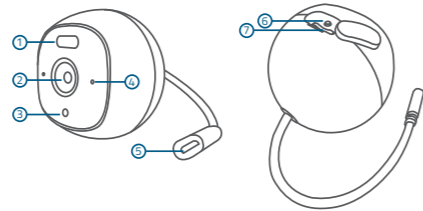

- ① Spotlight
- ② Lens
- ③ Status LED
- ④ Microphone

- ⑤ Micro USB port
  - Connect to a USB charger
- ⑥ SYNC button
- ⑦ microSD card slot
  - Insert a microSD card to store recordings

01

### Powering On the Camera

1. Connect the micro USB connector to the Outdoor Cam Pro / Outdoor Cam's micro USB port and the other end to a power adapter.
2. Plug the power adapter into a power outlet. Wait until the camera status LED turns solid blue.

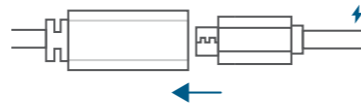

02

### Setting Up the System

1. Download the eufy Security app from the App Store (iOS devices) or Google Play (Android devices).



2. Create an account and tap "Add Device" to add Outdoor Cam Pro / Outdoor Cam to your device list.
3. Follow the on-screen instructions to complete the setup.

03

### Mounting the Camera

#### A. Place the camera on a table

Attach the bottom of your camera to the magnetic base and place it on the table.

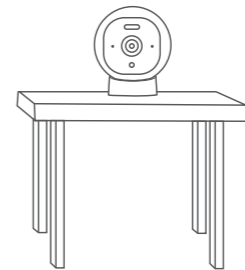

04



Anker Innovations Limited. All rights reserved. eufy Security and eufy Security Logo are trademarks of Anker Innovations Limited, registered in the United States and other countries. All other trademarks are the property of their respective owners.

51005002602 V03

## B. Mount the camera onto a wall

### Note

Before mounting the camera:

- Unplug the USB cable from the power adapter.
- Find a spot where the camera can easily reach a power outlet.
- Make sure the camera receives a strong Wi-Fi connection in the spot you want to mount it so that it can stream video to your eufy Security app.
- A 3M adhesive strip is provided for people who don't want to drill holes in the wall. Adhere the metallic plate with the 3M adhesive strip after fastening the charging cable under the metallic plate's hook
- The provided USB adapter is NOT waterproof. Using a waterproof socket box is recommended when installing the camera outdoors..

1. Drill a pilot hole using a power drill. Install the metallic plate using the provided anchors (optional) and screws. Anchors are needed for walls that are made of brick or concrete. Make sure there is enough space for the charging cable to run through before you fix the screws.

05

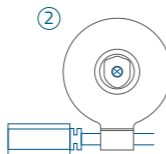
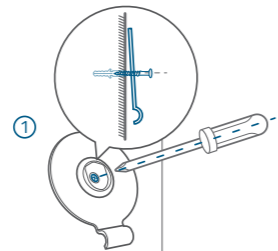

06

2. Attach the magnetic base to the metallic plate. Attach the Outdoor Cam Pro / Outdoor Cam onto the magnetic base.

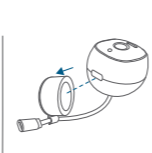

3. Rotate the camera to adjust the view and check it using the live stream which you can access in the eufy Security app.



Tip: For more details, check the online manual:  
<https://www.eufylife.com/support>

07

## Notice

### FCC Statement

This device complies with Part 15 of the FCC Rules. Operation is subject to the following two conditions: (1) this device may not cause harmful interference, and (2) this device must accept any interference received, including interference that may cause undesired operation.

**Warning:** Changes or modifications not expressly approved by the party responsible for compliance could void the user's authority to operate the equipment.

**Note:** This equipment has been tested and found to comply with the limits for a Class B digital device, pursuant to Part 15 of the FCC Rules. These limits are designed to provide reasonable protection against harmful interference in a residential installation.

This equipment generates uses and can radiate radio frequency energy and, if not installed and used in accordance with the instructions, may cause harmful interference to radio communications. However, there is no guarantee that interference will not occur in a particular installation. If this equipment does cause harmful interference to radio or television reception, which can be determined by turning the equipment off and on, the user is encouraged to try to correct the interference by one or more of the following measures: (1) Reorient or relocate the receiving antenna. (2) Increase the separation between the equipment and receiver. (3) Connect the equipment into an outlet on a circuit different from that to which the receiver is connected. (4) Consult the dealer or an experienced radio/ TV technician for help.

### FCC Radio Frequency Exposure Statement

The device has been evaluated to meet general RF exposure requirements.

The device can be used in fixed/mobile exposure condition. The min separation distance is 20cm.

Notice: Shielded cables

All connections to other computing devices must be made using shielded cables to

maintain compliance with FCC regulations.

The following importer is the responsible party

Company Name: POWER MOBILE LIFE, LLC

Address: 400 108th Ave NE Ste 400, Bellevue, WA 98004-5541

Telephone: 1-800-988-7973

### IC Statement

This device complies with Industry Canada licence-exempt RSS standard(s).

Operation is subject to the following two conditions:

- (1) this device may not cause interference, and
- (2) this device must accept any interference, including interference that may cause undesired operation of the device.

Le présent appareil est conforme aux CNR d'Industrie Canada applicables aux appareils radio exempts de licence. L'exploitation est autorisée aux deux conditions suivantes:

- (1) l'appareil ne doit pas produire de brouillage, et
- (2) l'utilisateur de l'appareil doit accepter tout brouillage radioélectrique subi, même si le brouillage est susceptible d'en compromettre le fonctionnement."

This Class B digital apparatus complies with Canadian ICES-003.

Cet appareil numérique de la classe B est conforme à la norme NMB-003 du Canada.

### IC RF Statement:

When using the product, maintain a distance of 20cm from the body to ensure compliance with RF exposure requirements.

Lors de l'utilisation du produit, maintenez une distance de 20 cm du corps afin de vous conformer aux exigences en matière d'exposition RF.

09

## Customer Service

### Warranty

12-month Limited Warranty

### Call Us

United States +1 (800) 988 7973 Mon-Fri 9AM-5PM (PT)

United Kingdom +44 (0) 1604 936 200 Mon-Fri 6AM-11AM (GMT)

Germany +49 (0) 69 9579 7960 Mon-Fri 6:00-11:00

### Email Us

Customer Support: [support@eufylife.com](mailto:support@eufylife.com)



Anker Innovations Limited

Room 1318-19, Hollywood Plaza, 610 Nathan

Road, Mongkok, Kowloon, Hong Kong

10