

Spaceship Cat House & Scratcher

This Package Contains

CW-10267

03/22/23 V2

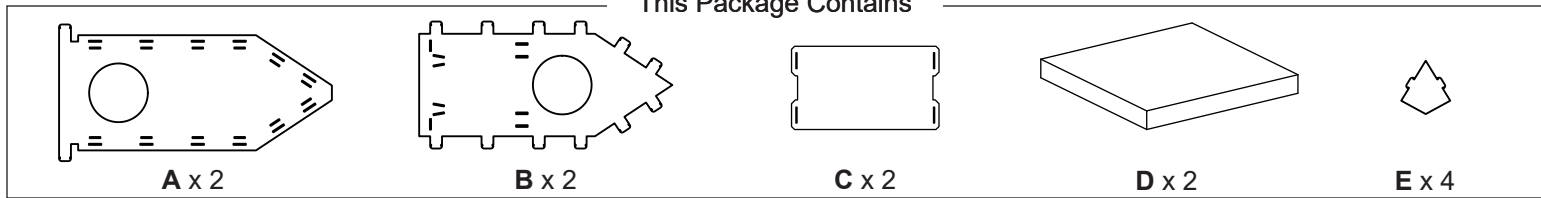

Completed Item

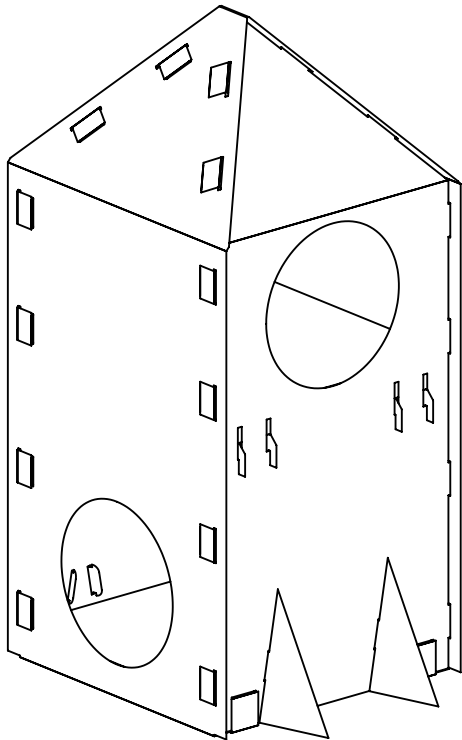

Step 1

Assemble **Panel (A)** to **Panels (B)** as pictured below. Insert the tabs of **Panels (B)** through the large slots in **Panel (A)**

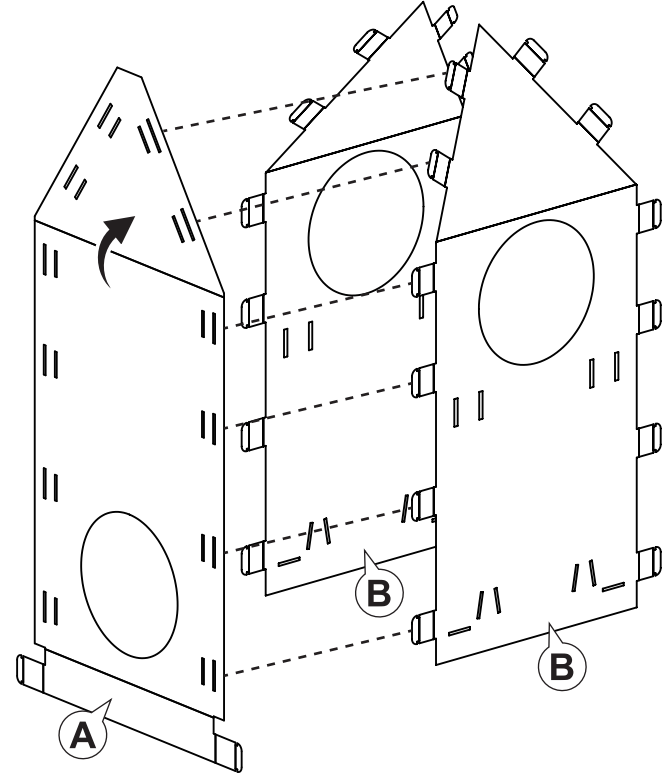

Step 2

Fully insert tabs into **Panel (A)**, then wrap the tabs around and insert into the small slots as detailed below.

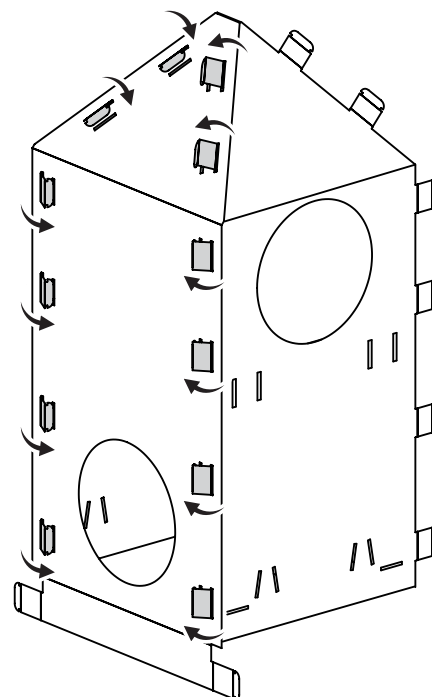
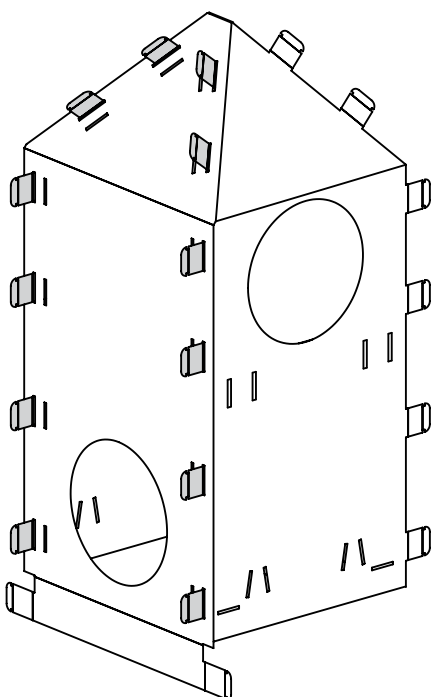

Step 3

Fold **Platform (C)**, and while holding tight, insert into slots in **Completed Panels** as shown. Fully insert into one side before inserting into the other.

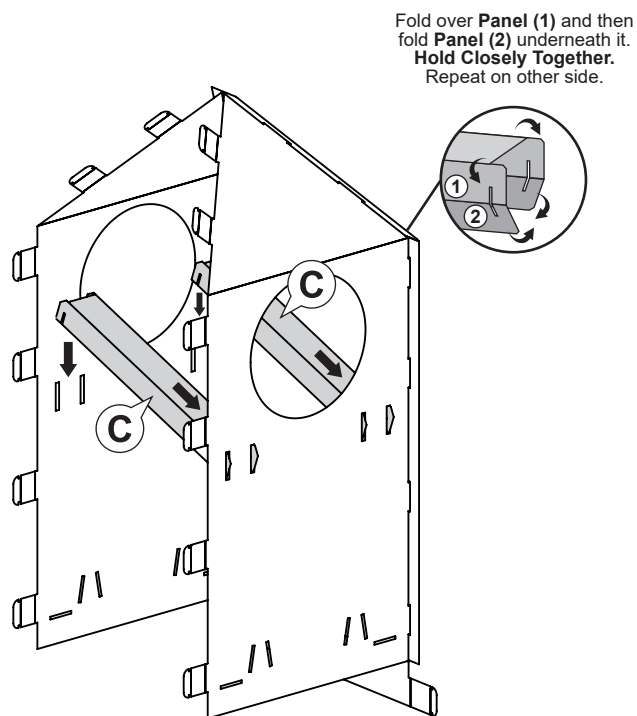

Step 4

Insert **Scratcher (D)** into **Completed Panels**.

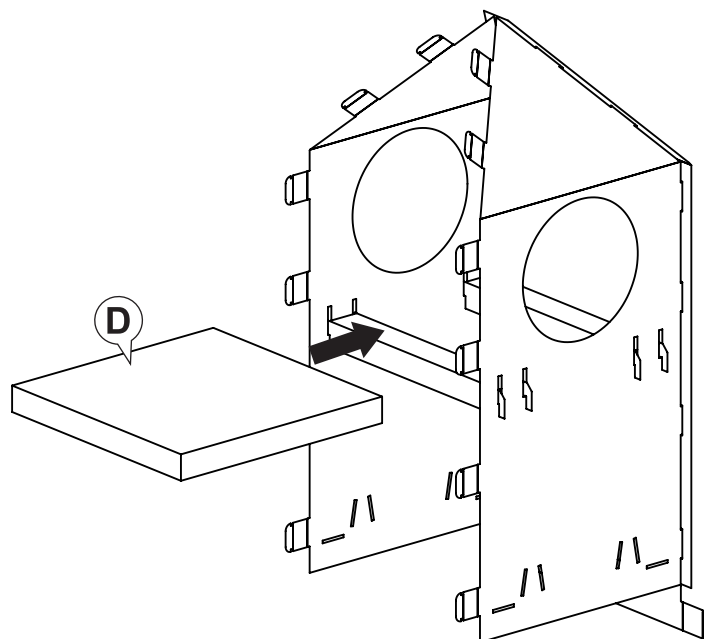

Step 5

Assemble **Panel (A)** to **Completed Panels** as pictured below. Fully insert tabs into **Panel (A)**, then wrap the tabs around and insert into the small slots as detailed below.

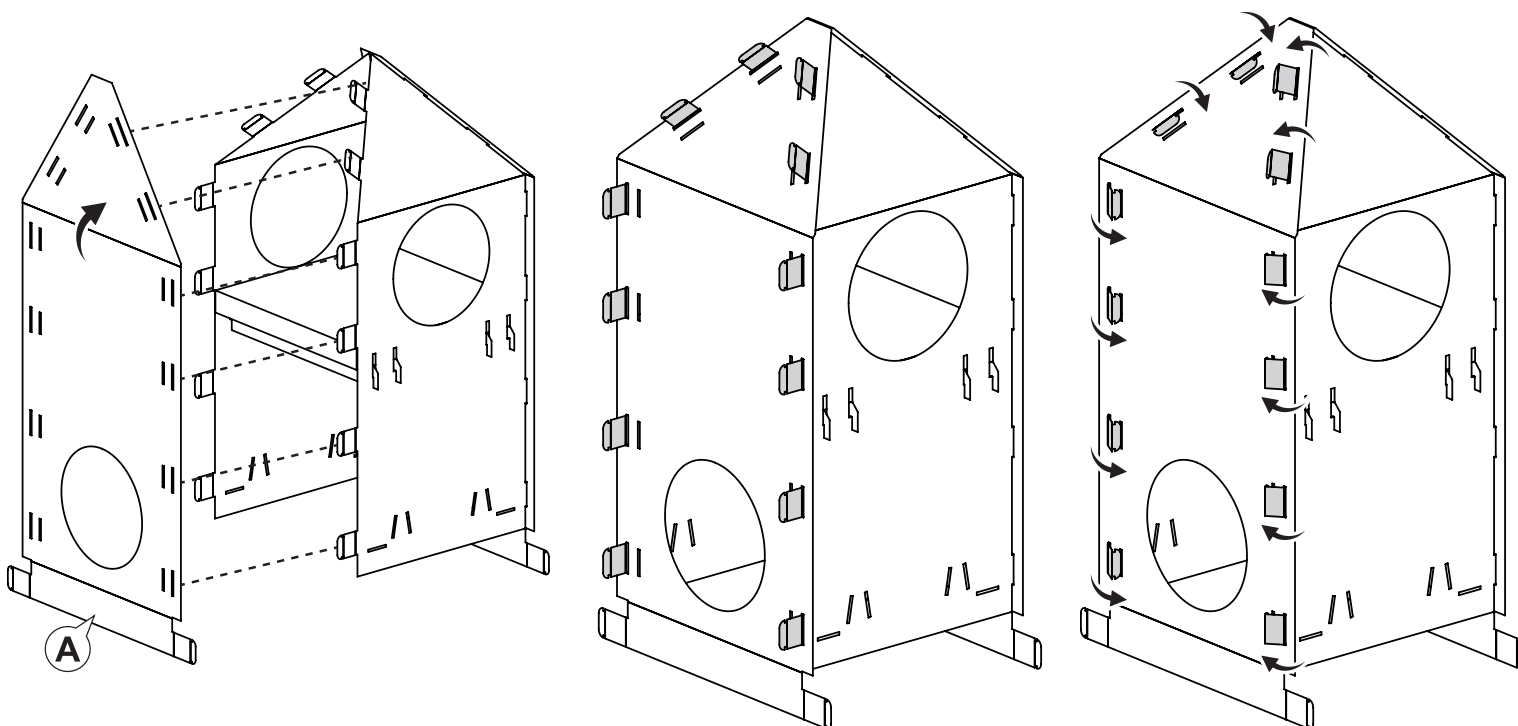

Line up tab with large outer slot.

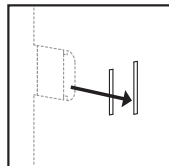

Push completely through.

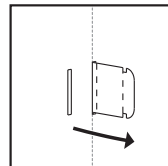

Fold front and insert tab into small slot.

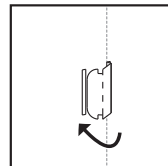

Step 6

Place **Combined Panels** over **Scratcher (D)**.

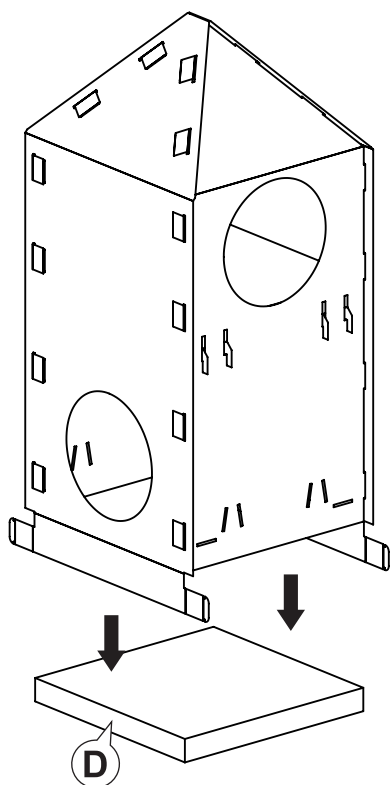

Step 7

Fold bottom flaps of **Panels (A)** under **Scratcher (D)**. Fold front and back tabs up, and insert into the slots of **Completed Panels** as pictured below.

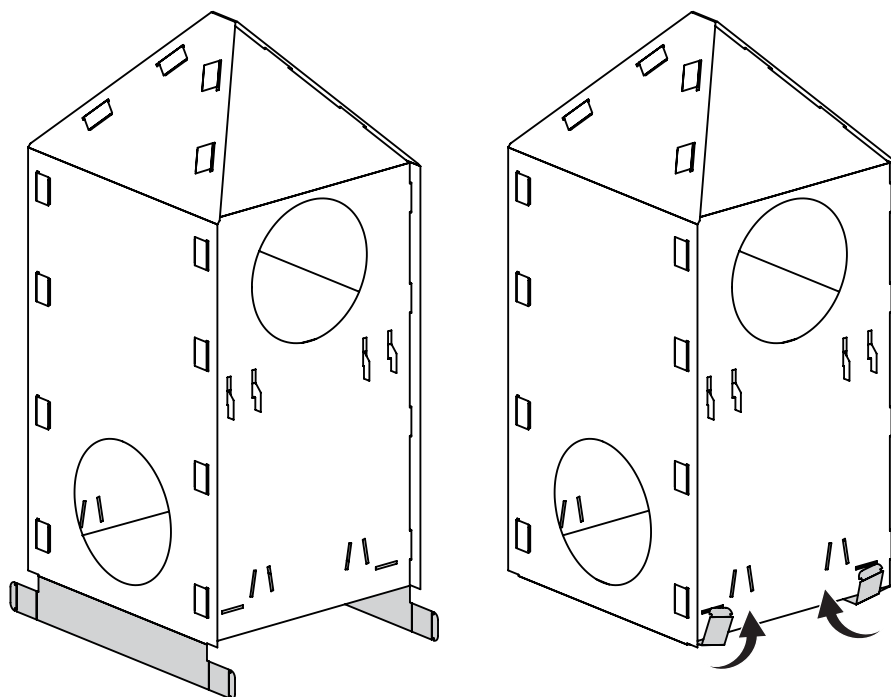

Step 8

Insert **Wings (E)** as pictured below.

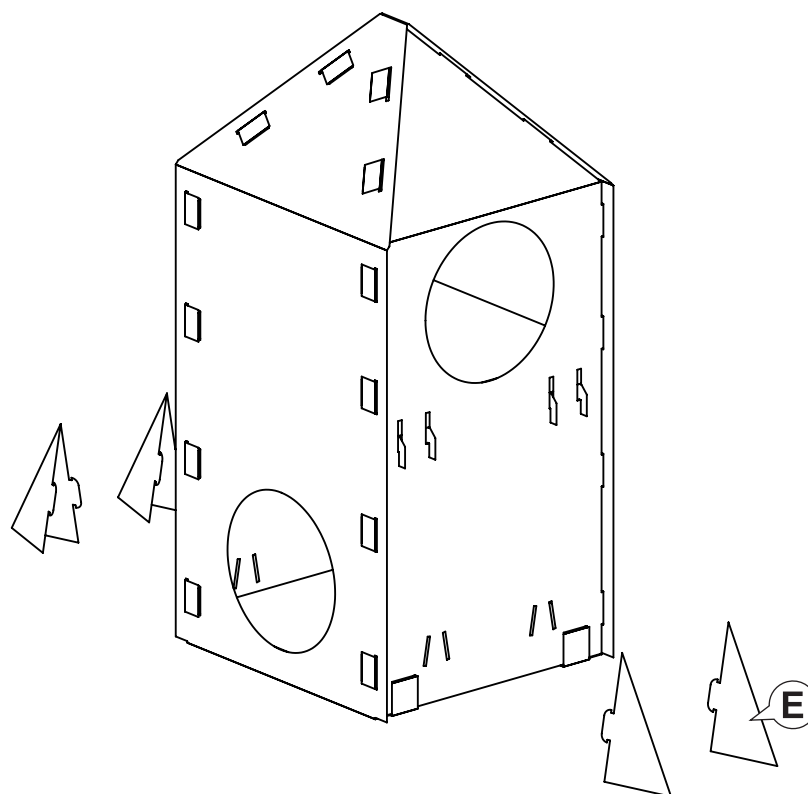

Because every cat is different, it is important to monitor your cat's behavior with this product. If at any time your cat damages this item, or any portion of this item becomes damaged, remove the damaged portion or discontinue use of the product.

QUESTIONS?

Call our friendly customer service team any time.
We're here 24/7! 1-800-67-CHEWY (672-4399)