

# Quick Start Guide

3 Pets Unit

PETFON

## Contents

Contact	1
Package content	2
Overview	2
Pre-use settings	3
Product installation	5
Secret cell	5
Battery status	6

## Contact

### Note:

This unit is designed for users who have 3 dogs which consists of 3 trackers. You can choose to use one or two if you don't have that many dogs. If you have more than 3 dogs, the system will not be able to add the additional ones due to the limit of your cellphone's Bluetooth.

Please go to "Help Center" for more advanced functions, you could also scan the following QR code for detailed video guides:



Installation Guide



APP Using Guide

### Contact:

Tel: +1-201-657-5353 (7:00-14:30 EST)  
Email: ubisighttech@gmail.com



1

## Package Content

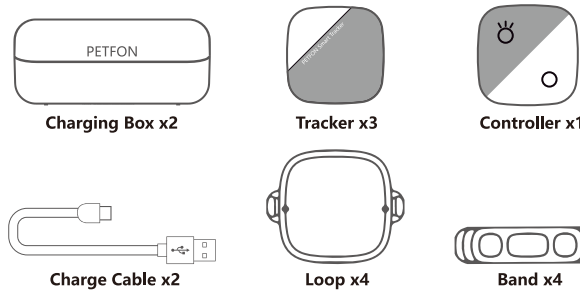

## Overview

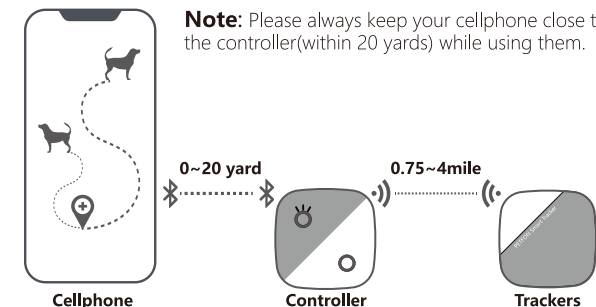

2

## Pre-use Settings

### STEP 1

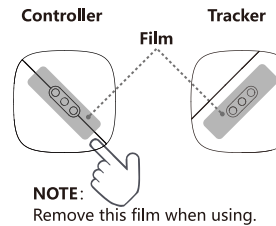

### Activate devices

Take out controller and trackers, REMOVE the bottom film, and PUT THEM BACK into charging box. The indicators embed in the trackers and controller would flash blue light when they are successfully activated.

## Pre-use Settings

### STEP 2



### Download APP

Scan QR code to download and install Petfon APP. You could also download it from Apple APP store or Google Play directly by searching "Petfon".

## Pre-use Settings

### STEP 3



### User Registration

Open Petfon APP, click "Register", enter personal email to obtain a verification code. Check your email and enter the verification code you received. Finalize the registration by creating password.

3

## Pre-use Settings

### STEP 4



### Connect devices

- ① Open APP, tap binding notification on top of the screen to start scanning.
- ② Follow APP Guide to complete binding controller and the 1st tracker.
- ③ Please click "+" icon to bind the 2nd and 3rd tracker.
- ④ Tap "Device" to check connection status.

## Pre-use Settings

### STEP 5

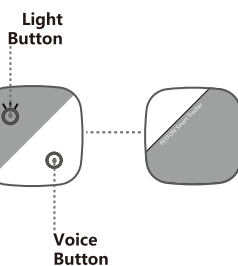

### Test devices

Press light button on controller to light up trackers, press it again to turn it off.

Press voice button on controller to open ring bell.

## Product Installation

### STEP 6

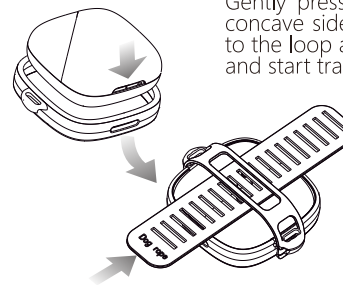

### Product Installation

Gently press Tracker down to the concave side of loop, Attach band to the loop as shown in the picture and start tracking.

## Secret Cell

You can keep the band in this secret cell in case it gets lost.

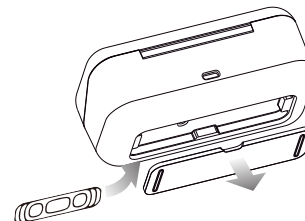

## Battery Status

### ① In tracking progress

Indicator	Battery status
Blinking Orange Light	Battery capacity < 20%
Blinking Red Light	Battery capacity < 10%

### ② In charging process

Place tracker and controller in the Charging box, the charging progress would get started automatically

Indicator	Battery status
Solid Green Light for 5 seconds and goes out:	Fully charged
Blinking Blue Light	Charging

### ③ Battery status for charging box

Indicator	Battery status
Solid Orange Light	Battery low
Solid Blue Light	Battery sufficient

### Charging Box

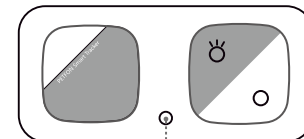

Battery Capacity Indicator

6