

USER MANUAL

B800 Bark Collar

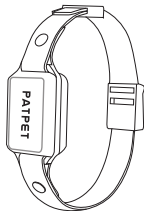

Please familiarize yourself with the Bark Collar for the safety of your pet !

THINGS YOU NEED TO PAY ATTENTION

- ① To avoid false triggering of the screen, please lock the screen after selecting the working mode.
- ② The trigger condition of the product is that sound and body shaking occur at the same time. If you find that the device is not triggered when the dog barks, it is likely that the trigger condition is not met. Please don't worry.
- ③ Because the product is an automatic trigger mechanism, if the environment is noisy, the product may trigger falsely. We recommend that you choose a fixed place and time to use this product for special behavior training for dogs.
- ④ This is not an ornament. Please don't let your dog wear it continuously for more than 6 hours to avoid excessive pressure on the dog's skin causing wear and tear.
- ⑤ Any question, please contact us timely for professional help, via **support@patpet.com**

COMPONENTS

- ① Bark Collar
- ② Magnetic Charging Cable
- ③ Test Light
- ④ Contact Points
- ⑤ Conductive Silicone Cap

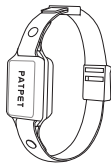

DESCRIPTION

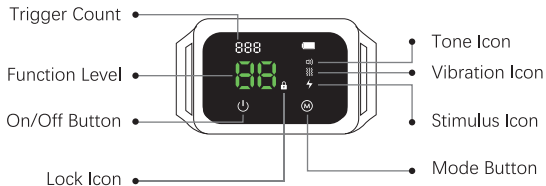
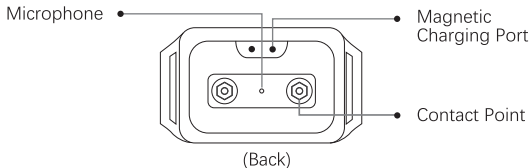

OPERATION

① Turn-on and turn-off

Turn-on: Press and hold the On/Off button to turn on the device.

Turn-off: Press and hold the On/Off button to turn off the device.

Screenoff: The screen will go off if no operation occurs within 30 s.

You may touch any button to light the screen up



② 3 Training Modes

Tap the “M” button for switching Tone/Vibration/Stimulus functions, among which Tone level is unadjustable ; Vibration and Stimulus range from level 1-6.

You may press and hold the “M” button to adjust the levels.

③ Trigger Count

Each trigger will be recorded. The maximum is 999 times. **You may double click the “M” button 2 times to clear the trigger record.**

④ Protection Mode

When the product is triggered 6 times in a row, it will enter the protection mode, and resume work after 1 minute automatically. The screen will show as below.



⑤ Lock/Unlock the Screen

Double clicking the On/Off button to lock the screen, then the function keys will not operate.



Double clicking the On/Off button again to unlock the screen, then the system will return to normal.



⑥ Charge

Please charge the device before first use!

The charging cable is a DC interface and the input voltage is 5V 1A.

Training Mode Test

- ① Turn on the bark collar and switch to Stimulus Training Mode ,at level 6. Put the stimulation test light on the contact points, then shout "woof, woof" to the collar while shaking it. Normally ,the test lamp will flash when triggered.



- ② Switch to Tone/Vibration mode ,without the test light ,just shout "woof,woof" to the collar while shaking it .Normally ,the collar will beep/vibrate when triggered .
Please note the product can only be triggered by both sound and shaking.

WEARING

The correct wearing of the bark collar is essential for effective operation.

Wearing Steps

- ① Check that the bark collar is turned off.
- ② Keep your dog in a comfortable standing position.(A)
- ③ In order to better pick up the microphone and increase the trigger sensitivity, we recommend that you adjust the collar directly below your dog's mouth.(B)
- ④ Check the tightness of the bark collar by inserting a finger between the collar strap and your dog's neck making sure the the collar strap is not too tight or too loose.(C)
- ⑤ If the collar strap is a little longer for your dog ,please trim the collar strap.(D)

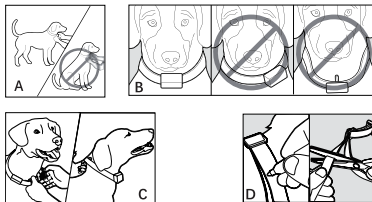

Note

The following practices may be detrimental to your dog.

- ① Attach the device too tightly around the dog's neck.
- ② Attach a belt to the collar.
- ③ Leave the device on the dog for more than 6h. We recommend you reposition the collar every 2h, and check your dog's neck skin regularly.

FAQ

Q: How can I prevent the screen from being touched by my dog by mistake?

A: After you select the model ,please double-click the power button to lock the screen.

Q: How can I tell if my dog's behavior has improved?

A: You can refer to the number of triggers displayed on the screen.

Q: Can I let my dog wear it all the time?

A: No .To protect your dog's skin ,please do not wear it more than 6 hours continuously ,because the contact points will cause extra pressure on dog's neck . Also ,please check your dog's neck skin regularly .

Q: Can my dog swim with the collar?

A: Yes ,absolutely .This model has the highest waterproof grade attribute.

Q: Why does my collar trigger sometimes and sometimes not?

A: There are two situations:

- ① The trigger condition of the product is that sound and body shaking occur at the same time. If you find that the device is not triggered when the dog barks, it is likely that the trigger condition is not met. Please don't worry.
- ② Because the product is an automatic trigger mechanism, if the environment is noisy, the product may trigger falsely. We recommend that you choose a fixed place and time to use this product for special behavior training for dogs.

Q: How can I get my dog form positive behavior within a short period ?

A: Every time your dog has good behavior when the collar triggered ,reward him at once .Then repeat and be consistent ,under normal circumstances, repeat 10 times, and your dog will be able to form relevant memories.

Q: My dog doesn't reply to the stimulus .Why?

A: Most likely because your dog has thicker hair ,which prevents contact points from touching the skin.

1-YEAR WARRANTY

If the product has quality failure ,please send the below info to **support@patpet.com** to activate the warranty.

- ① The order screenshot to show your purchase time
- ② One short video to show the problem
- ③ Your current shipping address

After confirmation ,we will ship you the replacement part within 5 business days.

FCC COMPLIANCE

This device complies with part 15 of the FCC Rules. Operation is subject to the following two conditions:

- ① This device may not cause harmful interference,
- ② This device must accept any interference received,
including interference that may cause undesired operation.

EXPLORE MORE ABOUT PATPET

chewy

amazon

Walmart

PATPET



682 e-Collar for Small Dog



A01 Bark Collar



320 Training Collar 300M



650 Remote Training Collar



640 Training Collar 1000M



U01 Training Remote



**We are honored to provide service for you and
your furry friend in the following days!**



PATPET

Rooted in Pet Training Supplies since 2014

 1-855-888-9922

 @PATPET

 support@patpet.com



MADE IN CHINA