

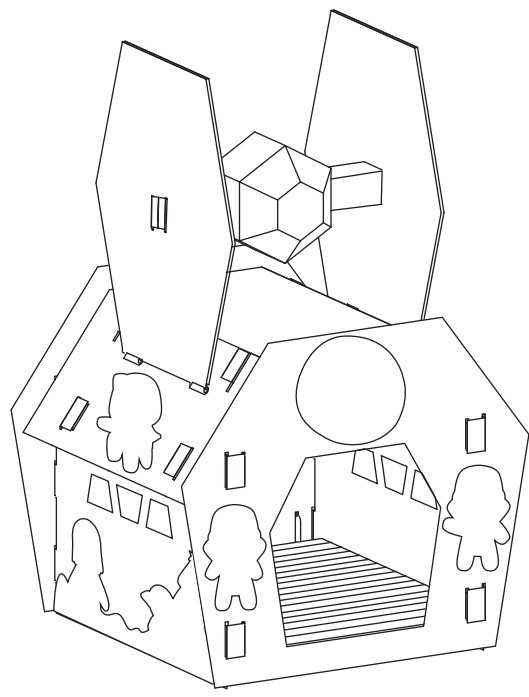

This Package Contains

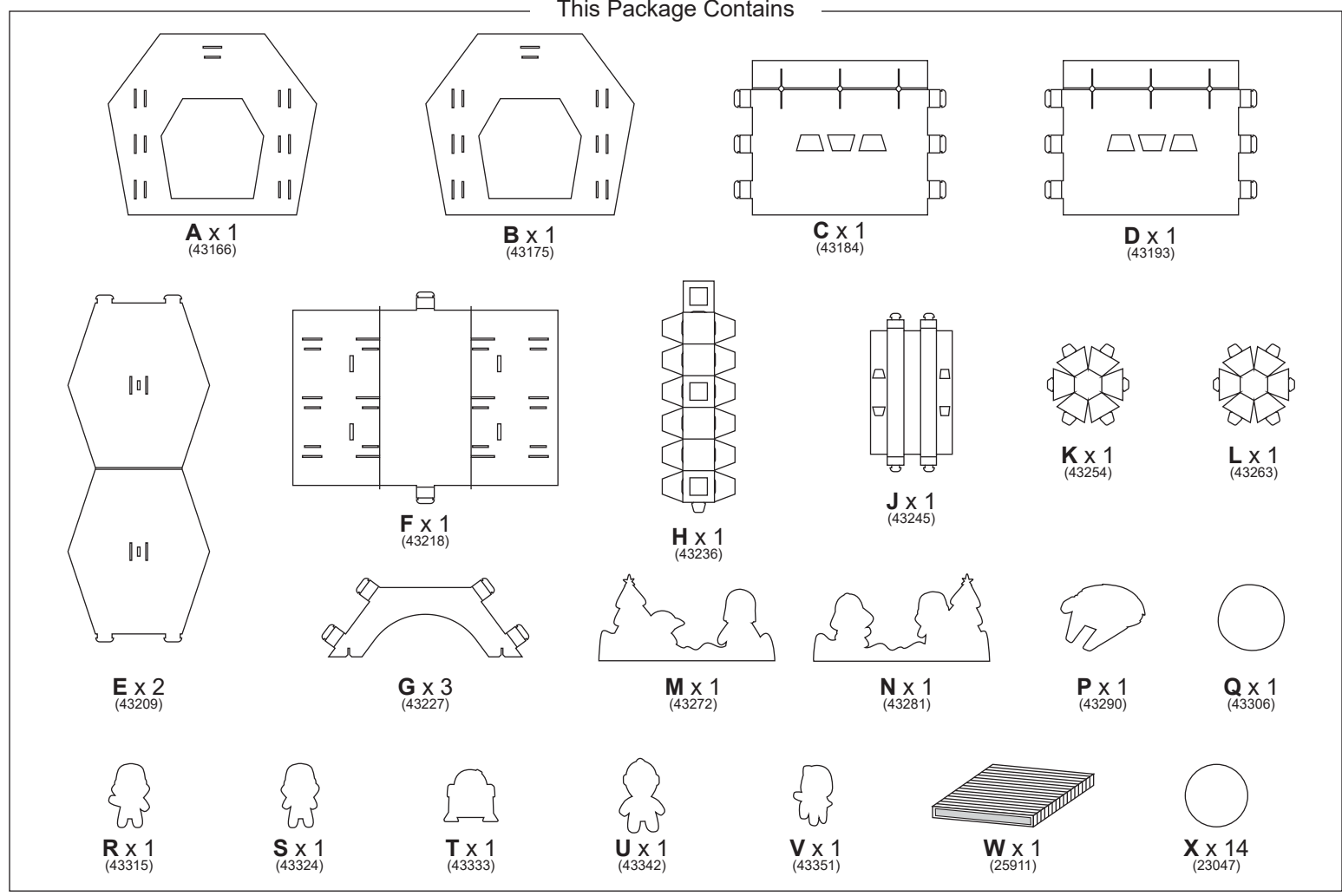

 Because every cat is different, it is important to monitor your cat's behavior with this product. If at any time your cat damages this item, or any portion of this item becomes damaged, remove the damaged portion or discontinue use of the product.

QUESTIONS?
 CALL OUR FRIENDLY CUSTOMER SERVICE TEAM ANYTIME.
 WE'RE HERE 24/7! 1-800-67-CHEWY (672-4399)

Step 1

Fold **Strut (J)** as shown below. Lock tabs into slots.

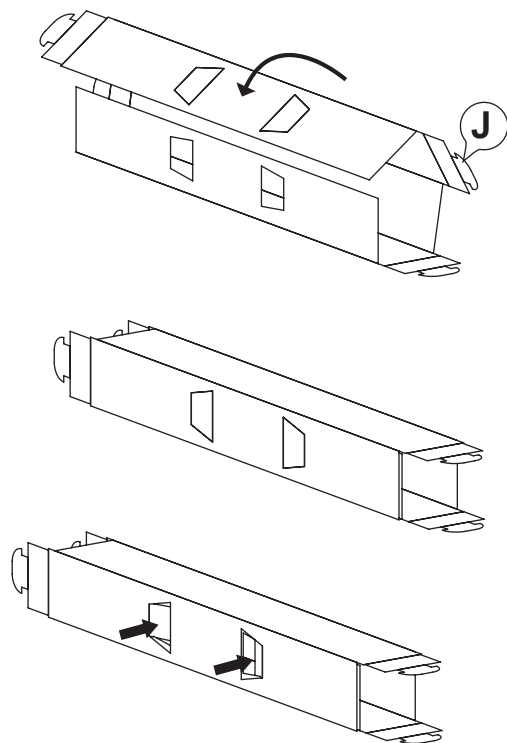

Step 2

Pre-fold and roll **Cockpit (H)** as shown below. Insert tab into slot.

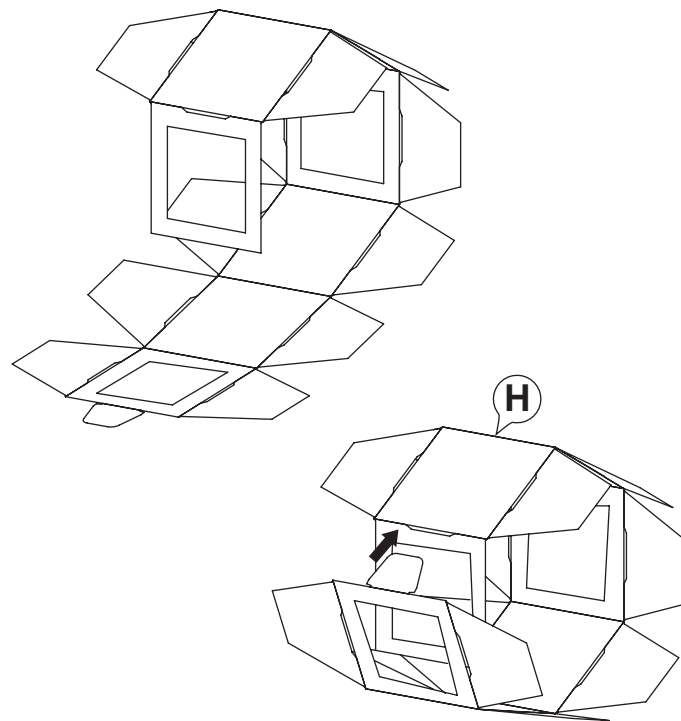

Step 3

Attach **Sides (L&K)** to **Cockpit (H)** by inserting tabs into slots as shown below. Match the numbers on the tabs for the correct orientation.

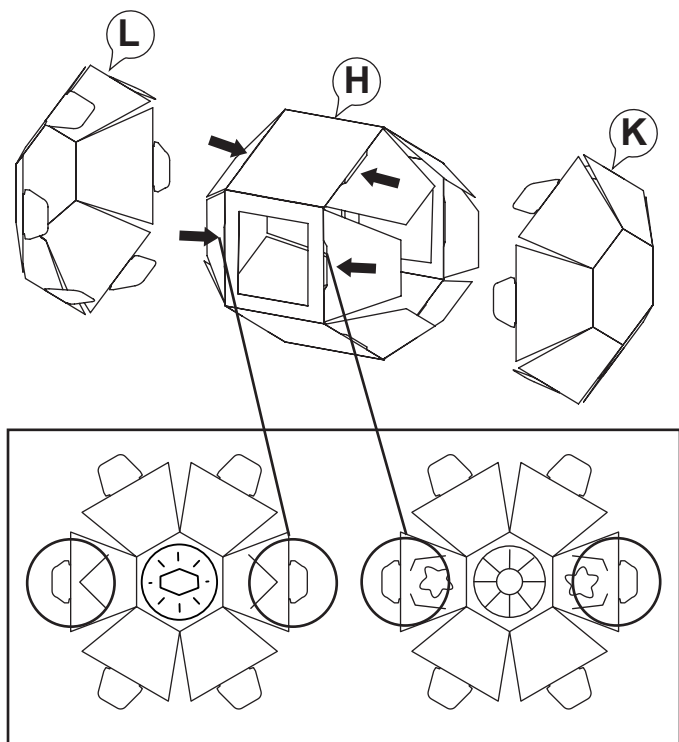

Step 4

Reinforce connections by placing **Clear Stickers (X)** over the tabs and slots of **Lower Panels** as shown

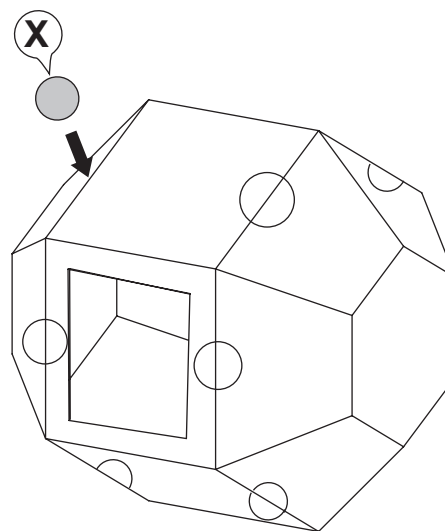

Step 5

Insert **Strut (J)** through completed **Cockpit** as shown below.

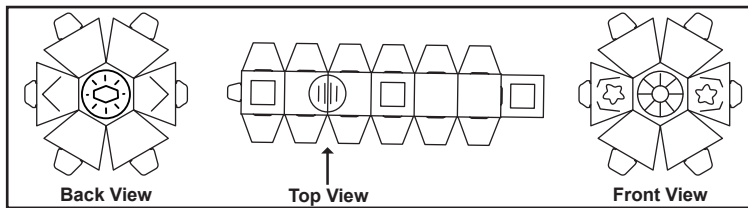
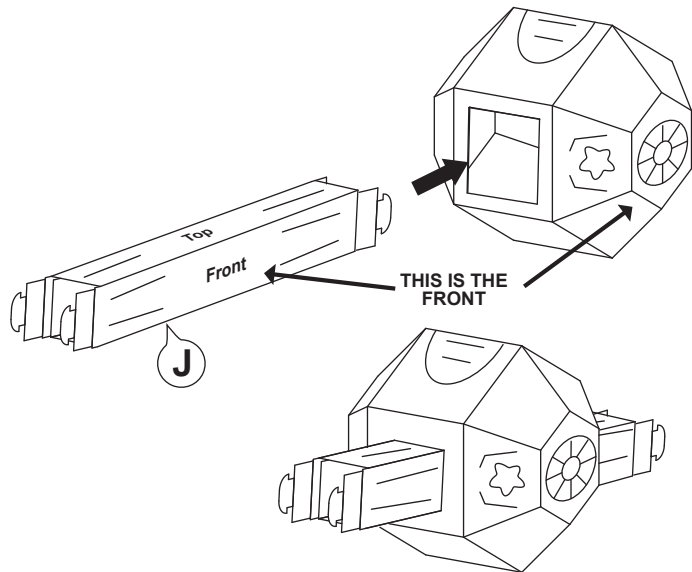

Step 6

Fold **Wings (E)** as shown below.

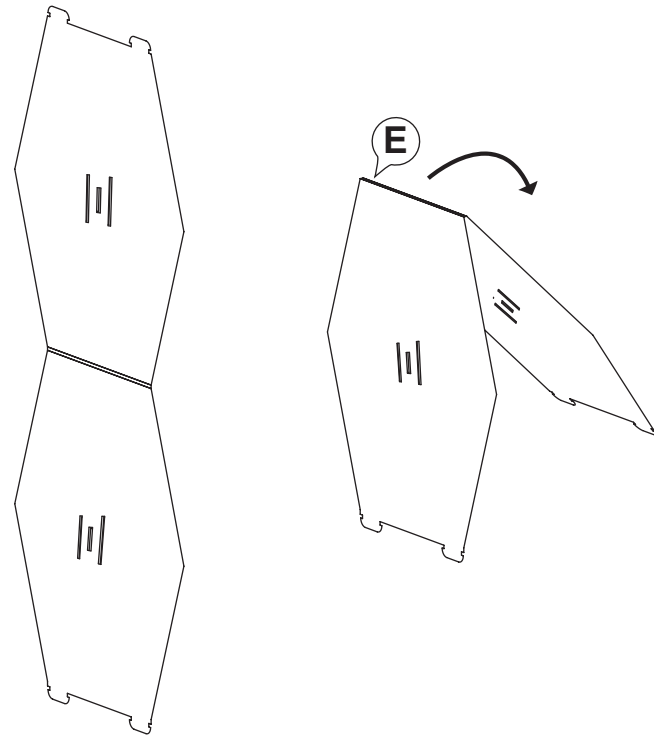

Step 7

Attach **Wings** to **Cockpit** as shown below. Arrange the panels according to the reference below

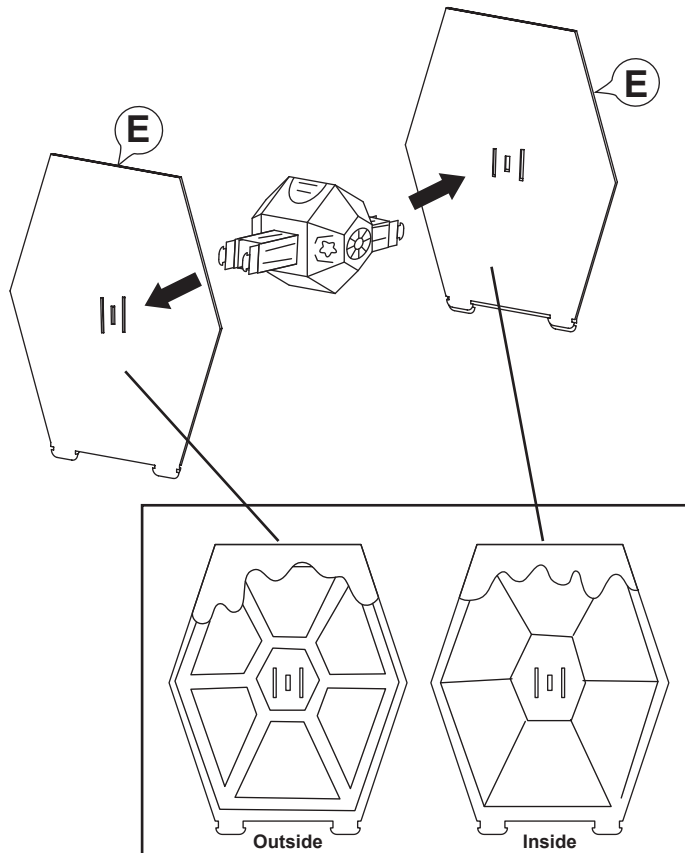

Step 8

Fold tabs and insert into slots as shown below. Repeat on both sides.

| | |
|--|--|
| <p>8.1 Line up tab with right exterior slot.</p> | <p>8.2 Push completely through.</p> |
| <p>8.3 Wrap front and insert tab into middle slot.</p> | <p>8.4 Push middle seam to lock in place. Reinforce connections by placing Clear Stickers (X) over the tabs</p> |

Step 9

Attach **Roof (F)** to **Braces (G)**. Fold tabs and insert into larger slots as shown below.

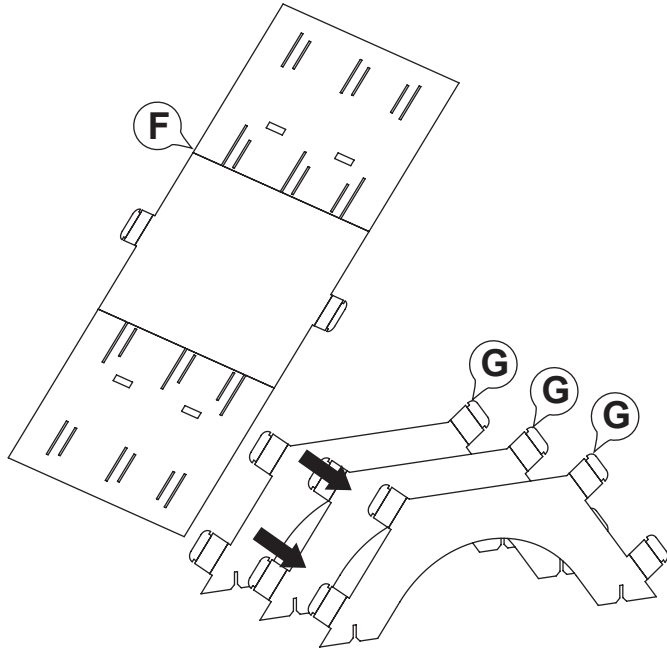

Step 10

Wrap around the side of **Braces (G)** and insert tabs into larger slots on the other side.

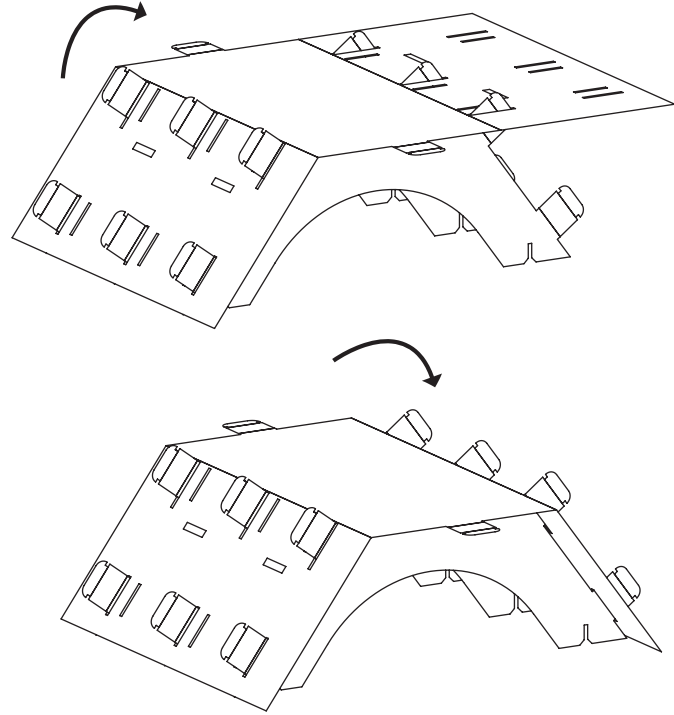

Step 11

Lock roof in place by inserting tabs into smaller slot as shown below.

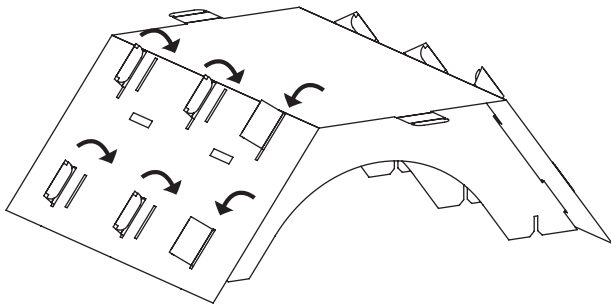

| | |
|--|--------------------------------------|
| <p>11.1 Line up tab with large slot.</p> | <p>11.2 Push completely through.</p> |
| <p>11.3 Wrap front and insert tab into small slot.</p> | <p>11.4 Push to lock in place.</p> |

Step 12

Fold **Side Walls (C & D)** of upper panels as shown below.

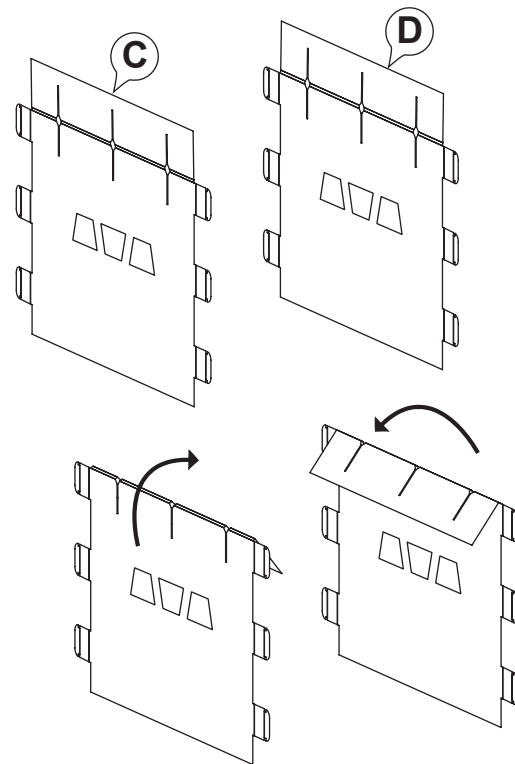

Step 13

Attach **Completed Roof** to side walls by inserting **Braces** into slots of **Walls**. Push down to lock fully in place.

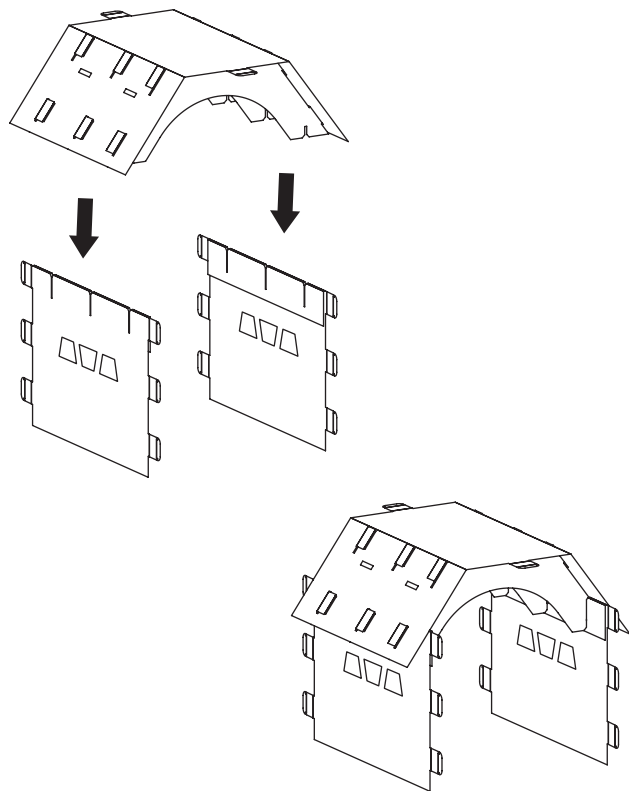

Step 14

Line up **Front Panel (A)** and **Back Panel (B)** with **Completed Panels**. With the graphics on the tabs lining up, fold tabs and insert into larger slots.

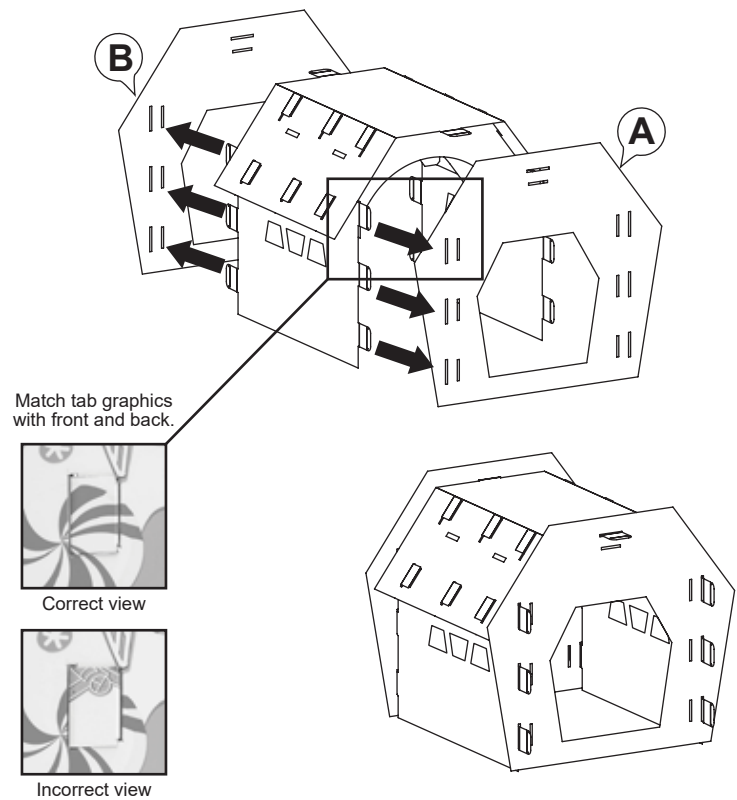

Step 15

Lock sides in place by inserting tabs into smaller slot as shown below.

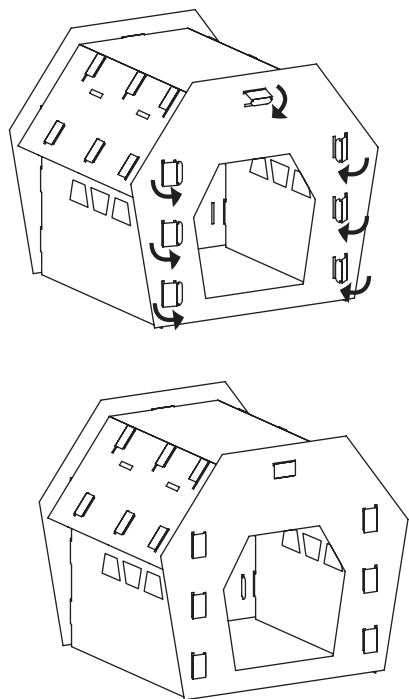

Step 16

Attach **Assembled Ship** to roof by inserting tabs into slots as shown below.

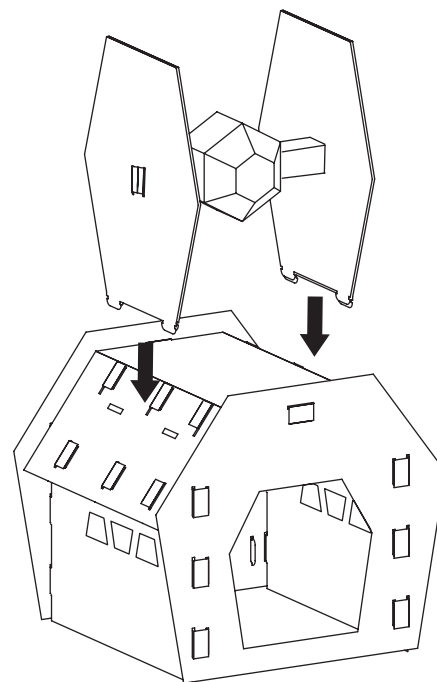

Step 17

Remove protective film from double-sided tape of **Corrugate Board (W)**. Slide **Completed Panels** down over the sides until it rests over **(W)** as shown. Press to attach the board to the front and back panels.

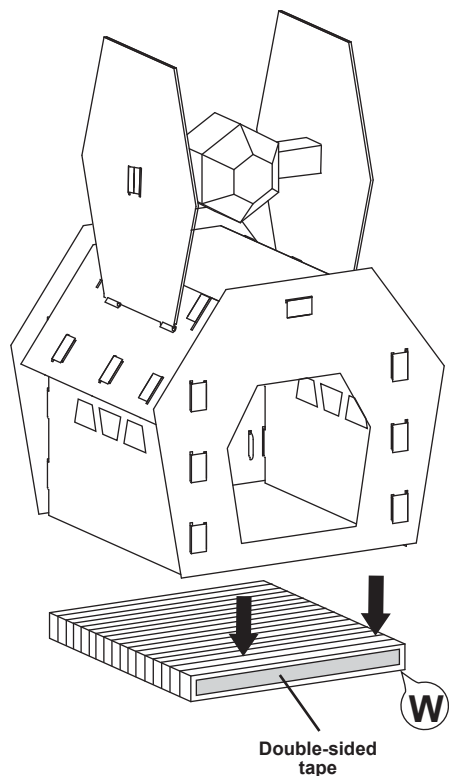

Step 18

Remove protective film from double-sided tape of **Side Characters (N & M)** attach stickers anywhere on the house.

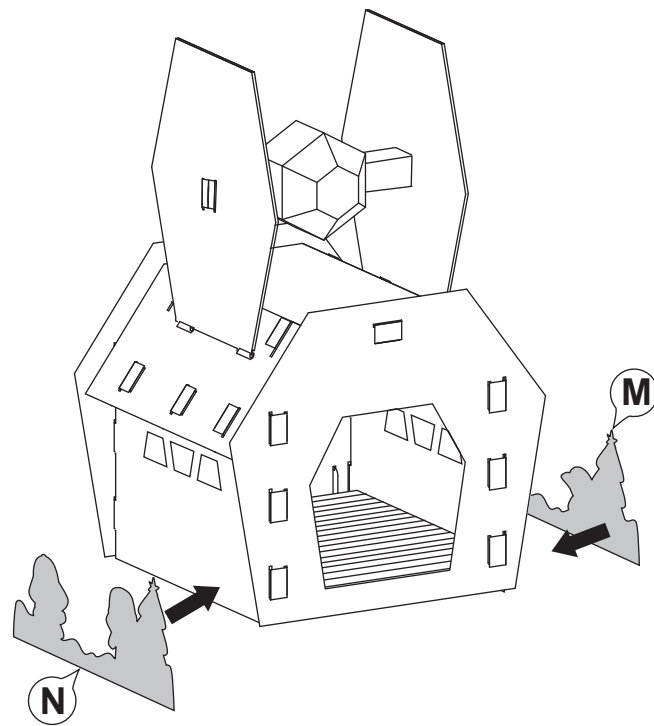

Last Step

Remove protective film from double-sided tape of **Small Characters (P, Q, R, S, T, U & V)** attach stickers anywhere on the house.

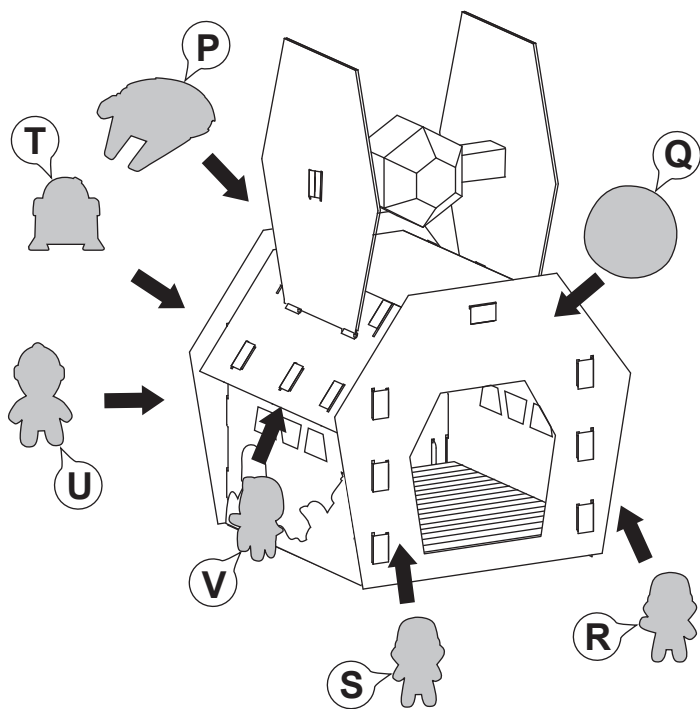

Completed Item

NOTICE: THIS SHIP IS NOT A STEP. DO NOT ALLOW YOUR CAT TO CLIMB ON TOP OF THE ROOF. IT IS NOT INTENDED TO HOLD THE WEIGHT OF A CAT.

