



# Acrylic Bowl Wall Mounted Cat Wall Shelf Product Manual

**sku# 373439**

46 cm L x 40 cm W x 15 cm H  
18.11 inches L x 15.75 inches W x 5.9 inches H

# Assembly Instructions

Please Read Through All Instructions Before Starting

## Parts Included

Prior to assembly, please be sure to identify and sort all parts shown below.

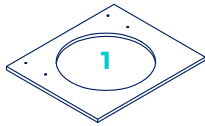

**1PC Base Board**  
18.11 inches x 15.35 inches

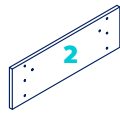

**1PC Back Board**  
18.11 inches x 5.90 inches



**1PC Transparent Acrylic Bowl**  
11.81 inches

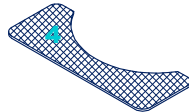

**2PCS Sisal Mat**  
14.56 inches x 6.30 inches

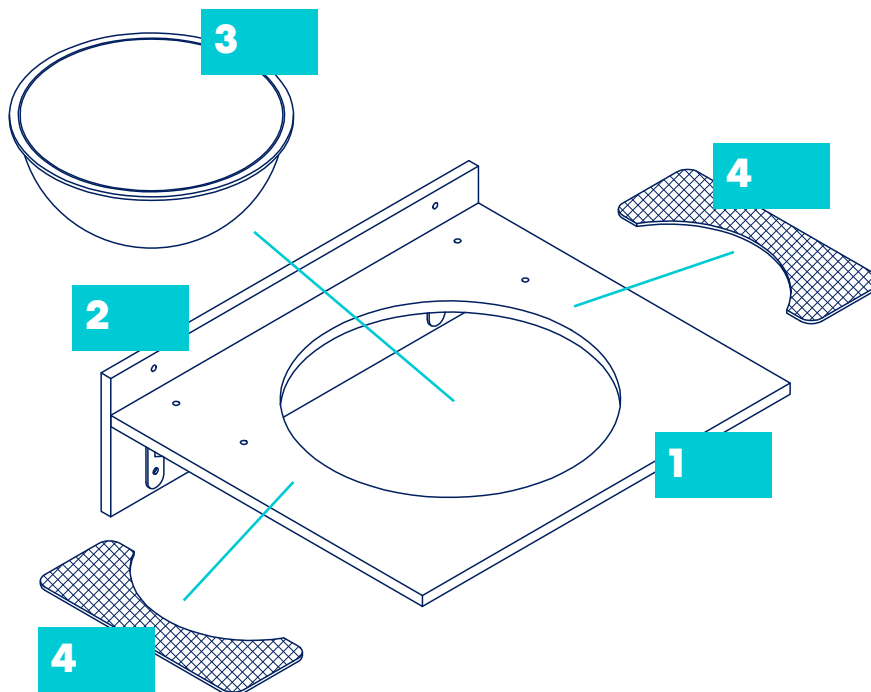

## Accessories

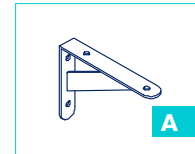

**2PCS**  
150 x 95mm  
Bracket

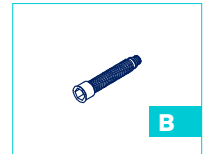

**2PCS+1PC**  
M5 x 38mm  
Screw



**6PCS+1PC**  
M5 x 60mm  
Screw



**6PCS+1PC**  
M8 x 40mm  
Drywall Anchor



**4PCS+1PC**  
M4 x 8mm  
Bolt

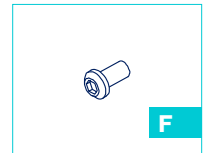

**4PCS+1PC**  
M4 x 14mm  
Bolt

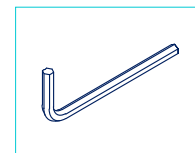

**1PC 3mm Wrench**



**YES**



**YES**

# Assembly Instructions

Please Read Through All Instructions Before Starting

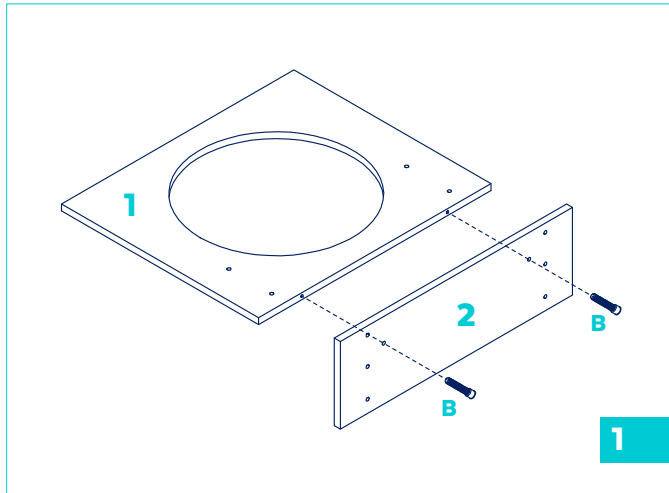

**Step 1.**

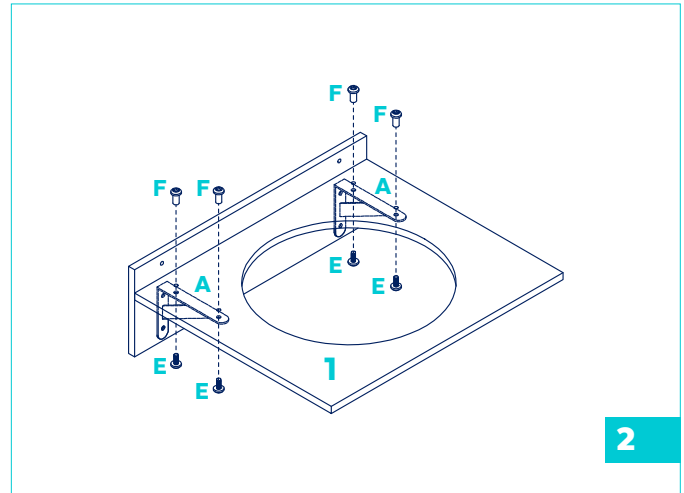

**Step 2.**

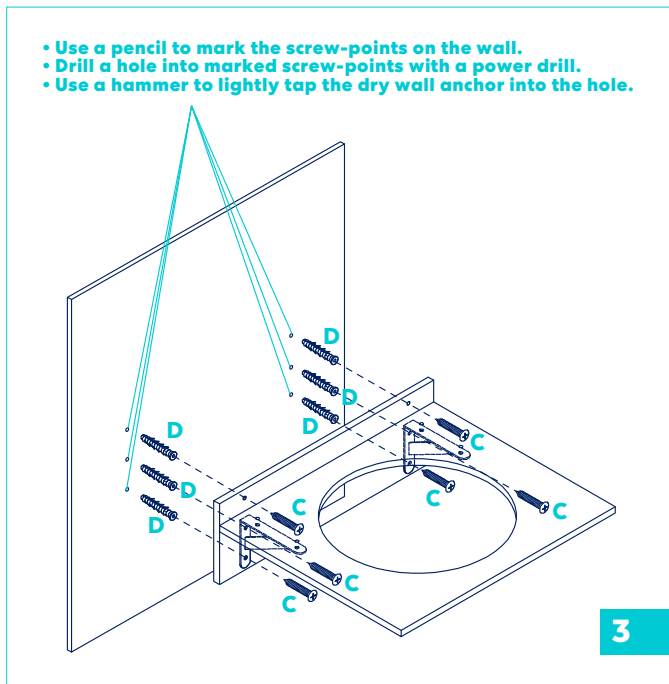

**Step 3.**

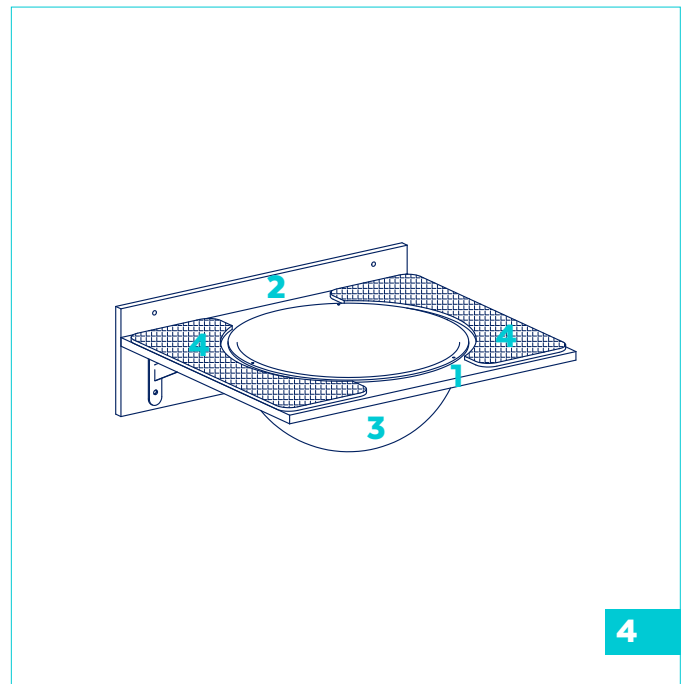

**Finished Assembly**

## Warning & Cautions

Please read and follow all warnings and instructions to avoid pet injury or property damages.

Keep all tools and instructions in a safe place for future reference.

Follow the instructions carefully and make sure you've completed each step.

Depending on your selected assembly location, a stud finder may be used. Standard home construction stud spacing is 16" or 24". However, the size of the wall shelf assembly may only allow for product to be secured to one stud. For wood studs, use the provided screws and for metal studs, use self-tapping screws (not provided, but can be purchased from a hardware store). A power driver with the correct bits/screws may also be needed.

This cat wall shelf is intended for cat use only, please keep children away.

Keep all small parts away from children / pets to avoid choking hazards.

Never climb, rock, shake, step or hang on the cat wall shelf.

Place your cat wall shelf indoors, away from direct sunlight or damp areas.

Check your cat wall shelf often for loose screws or parts that might need re-tightening.

If your cat wall shelf gets torn or damaged, please discard it.

The product photo may vary slightly from your fully assembled cat wall shelf as this product is continually being enhanced.

## Cleaning & Instructions

Spot clean stains and vacuum (using small handheld or attachment) when necessary.

## Questions?

Call our friendly customer service anytime.  
We're here 24/7 at 1.800.672.4399