



DOG TRAINING COLLAR  
**User Guide**

# CONTENTS

<b>STATEMENT</b>	01
<b>SAFETY INSTRUCTIONS</b>	01
<b>REINFORCE LEARNING BEHAVIOURS</b>	02
TIPS	02
<b>BEFORE USING THE DOG TRAINING COLLAR</b>	03
<b>WHEN USING THE DOG TRAINING COLLAR</b>	03
<b>PACKAGE CONTENTS</b>	04
<b>SPECIFICATIONS</b>	04
<b>MAINTENANCE</b>	04
<b>KEY DEFINITION</b>	05
<b>OPERATION AND FUNTIONS</b>	06
Charge the Remote Transmitter	06
To turn the transmitter on and off	06
Charge the Collar Receiver	06
To Turn the Receiver Collar on and off	06
Check the Receiver Power	07
<b>PAIRING AND TESTING</b>	07
How to Pairing/Test the Training System	07
How to Wear Receiver Collar Correctly	08
<b>REFERENCE SIZE FOR DIFFERENT DOGS</b>	09
FAQ	09/10
<b>WARRANTY</b>	11
<b>FCC Compliance</b>	12

## STATEMENT

Thank you for purchasing a PETDIARY product that has been tested to meet our stringent quality standards. This product is covered with PETDIARY product and labor warranty for 12 months from the date of its original purchase.

Please email us with your order ID and problem or issue, we will respond within 24 hours.

This warranty is void if the defect is caused by accidental damage, misuse, abuse, neglect, improper repair or alteration by unauthorized persons, or a failure to follow operating instructions.

This warranty does not apply to normal wear and tear or commercial use. In no event shall liability exceed the purchase price paid by the purchaser of the product. Under no circumstances shall there be liability for any loss – direct, indirect or incidental – or consequential damage arising out of, or in connection with the use of the product.

## SAFETY INSTRUCTION

Training collars are used to train the dogs and not for punishment. Use properly with care and the collar can be a safe and effective tool to train, building communication and strengthen your bond with your best friend. Obey all safety messages that follow this instruction to avoid possible injury.

# REINFORCE LEARNING BEHAVIOURS

If your dog knows the command but responds inconsistently or acts slower than your requirement, a training collar can sharpen his skill.

For example, you have taught your dog to come when called, but over time he responds slower. You can communicate with him via the remote trainer, so that he immediately responds to your call

1. Set the collar to initial stimulation level and test it.
2. Fit the collar on your dog's neck along with his regular collar.
3. Let him roam around the training area. Then give the command and simultaneously press the stimulation button.
4. The instant your dog moves toward you, stop stimulation and praise him.
5. If he stops before he reaches you or turns away repeat the command and continue the stimulation. Again, stop at the instant he runs to you and reward him by praising him or feeding him a treat. Repeat this for 3 or 4 times.

## Tips

1. If he doesn't get it for the first few times, don't give up and do not increase the stimulation. Try to work on this a couple of times per day.
2. During the training period never give the command if you are not able to enforce it.

Your dog has to make the mental connection between the static stimulation/vibration/beep to his behavior (may take a week or more for some dogs)

Altogether, both methods of stopping unwanted behavior and reinforcing learning behaviors can be applied to nearly every training scenario.

## BEFORE USING THE DOG TRAINING COLLAR

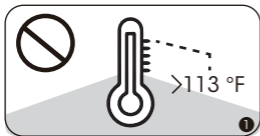

1. Do not expose to extreme heat or store at temperatures above 113 °F or 45 °C.
2. Please always keep the training collar out of reach of children.
3. Charge the remote transmitter and receiver at least 2 hours when receive the item. The collar cannot receive any signal while it is being charged.

## WHEN USING THE DOG TRAINING COLLAR



1. Avoid leaving the collar on the dog for more than 12 hours per day.
2. When possible, reposition the collar on the pet's neck every 1 to 2 hours.
3. Check the fit to prevent excessive pressure.
4. Take off the receiver when your dog is swimming.

## PACKAGE CONTENTS

1x Handheld Transmitter	1x Test Light
2x Receiver with Nylon Collar Strap	1x User Manual
2x USB Charging Cables	1x Lanyard
4x Silicone Caps	

## SPECIFICATIONS

Model	T730
Static Stimulation	0-16 Levels
Vibration	0-8 Levels
Tone	0-3 Levels
Stand-by Time on a Full Charge	Transmitter: 120 days Receiver: 90 days
Channels	2
Batteries Capacity	Transmitter: 250mA Receiver: 280mA
Remote Range	Up to 2,000 feet
Net Weight	Transmitter: 58g / Receiver: 79g

## MAINTENANCE

1. Please examine regularly to ensure tightness of the transmitter and eliminate any external damages.
2. Clean the screw caps with alcohol weekly.
3. Examine your dog's neck and carry out weekly cleanup.
4. The battery is rechargeable. In order to maintain battery life, please charge it once a month if it is not used.

# KEY DEFINITION

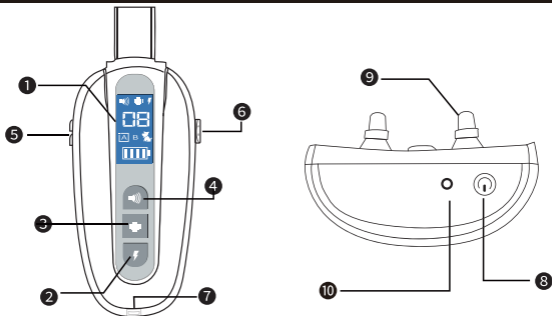

- 1 LCD Screen:**The LCD screen will display training modes, channels, intensity level and battery indicator.
- 2 Static Stimulation Button:** Pressing the “Static Stimulation” button, the receiver will emit static stimulation. If set level 0 , NO stimulation
- 3 Vibration Button:** Pressing the “Vibration” button, the receiver will vibrate. If set level 0, NO vibration
- 4 Beep Button:** Pressing the “Beep” button, the receiver will emit beep sound. If set level 0, NO beep
- 5 Intensity Up/down Buttons:** Select intensity level of beep,vibration and static Stimulation.
- 6 Channel Button:** Pressing this “A B” button will shift channel between the first and second collar receiver.
- 7 Charging port:** Insert charging cable into charging port to charge the Transmitter.
- 8 Power Button:**Turn on/off the receiver by press the “Power” button one time.
- 9 Touch Points**
- 10 Indicator Light**

# OPERATION AND FUNCTIONS

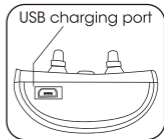
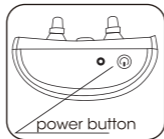
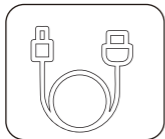

## Charge the Remote Transmitter

1. Connect the charger cable to the charging port.
2. Plug the charger into a standard outlet.
3. The battery icon will flash during charging and be solid when charging is completed.

## To turn the transmitter on and off

1. Press any button to activate the transmitter. The backlight is on.
2. The backlight will stay for about 5 seconds and will be off without interaction.
3. The transmitter goes into deep sleep mode after 50 seconds without interaction. Follow step 1 to activate transmitter.

## Charge the Receiver Collar

1. Open the rubber cover, connect the receiver to a charger into a standard socket.
2. The indicator light flashes red slowly during charging, while the red light keeps on when fully charged.

## To Turn the Receiver Collar on and off

1. Turn on: Press the power button once, the indicator light shows red and means that the receiver is turned on.
2. Turn off: Hold the power button for about 3 seconds, the indicator light is off and means that the receiver is turned off.
3. When the indicator light keeps on flashing in red, it means low battery.



# PAIRING AND TESTING

## How to Pair

1. Turn on the transmitter and the receiver.
2. Press A/B button on right side of transmitter to select one of the dog channels.
3. Press any function button to pair with receiver. The indicator will flash in green if pairing is successful.
4. If you need to pair one more receiver, simply choose another channel and pair by following step 2 and 3.

## Test the Training System

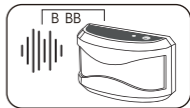
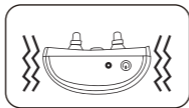
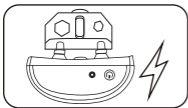

### 1. Static Stimulation Function Test

Please use test light to test static stimulation function. Press the static stimulation function button, the test light will shine. Press "+/-" button to adjust static shock levels from level 0-16.

### 2. Vibration Function Test

Press the vibration function button, the receiver will shake. Press "+/-" button to adjust vibration levels from level 0-8.

### 3. Tone Function Test

Press tone button, the receiver will make a long "beep" sound for 3 seconds. Press "+/-" button to adjust vibration levels from level 0-3.

1. Please remember the dog channel you choose and do not change to other channel, or the remote control will be invalid.
2. You need to pair remote transmitter and receiver before using it on the dog. Please follow the user guide for the first use.
3. The training system will fall into deep sleep mode after 50 seconds without interaction. Please reactivate the receiver by pressing any button on the remote and press any function button one more time to deliver signal to the receiver.

## How to Wear Receiver Collar Correctly

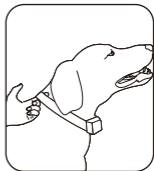
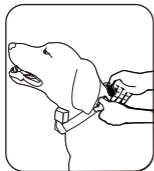

1. The correct wearing position helps training effective and healthy. The receiver shall be placed on bottom of the pet's neck, and the screw cap must contact the pet's skin directly.
2. The space between receiver collar and the pet's neck shall be maintained to a finger distance, not too loose or too tight.

## REFERENCE SIZE FOR DIFFERENT DOGS

Size	Neck(In)	Chest Measurement (In)	Back Length (In)	Type
Mini	7.8-8.6	9.8-11.8	7.5	Chihuahua, Yorkshire Terrier
Small	7.8-9.5	11.4-14.2	9	Chihuahua, Yorkshire Terrier, Poodle, Pomeranian
Medium	9.0-11.0	13.7-16.5	11	Maltese Dog, Shih Tzu
Large	9.6-12.2	16.2-18.5	12.2	Miniature Schnauzer, Pekingese
Large	11.8-13.4	18.1-20.8	13.8	Schnauzer, English Cocker Spaniel
Large	13.0-14.5	20.5-23.2	15.7	Beagle
Huge	17.0-18.9	30.0-33.0	23.6	Husky

### Reference weight for dogs

Large Dog (Body height above 24 inch, Weight above 88 lbs)

Medium Dog (Height 16-24 inch, Weight 24.2-66 lbs)

Small Dog (Height 10-16 inch, Weight 8.8-22 lbs)

Mini Dog (Height under 10 inch, Weight under 8.8 lbs)

### FAQ

#### Q: Is the Vibration/Stimulation safe for my pet?

A: It is safe to use vibration and stimulation while training your pet. Please test the functions begin from level 1 to observe your pet's reaction. For first time. Please follow our user guide to use this item better.

**Q: What age of dogs are suitable for this product?**

A: Your pet should be able to recognize basic commands such as "Sit" or "Stay". It fits all breeds and sizes aged above 6 months, weighing between 10–110 lb and with neck sizes of 5–20" .

**Q: My pet has been trained to obey my commands. Is it necessary to continue to wear the receiver collar?**

A: You may need to reinforce training with the receiver collar from time to time.

**Q: Is the Receiver Collar waterproof?**

A: It's water resistant and rainproof. Please be sure to keep the rubber cover put in the right position and remove the receiver from your dog when he/she is swimming.

**Q: How long can I continuously deliver Vibration/Stimulation signal to my pet?**

A: The stimulation will last for 5 seconds and vibration last for 10 seconds when you hold to press the button. After that, the Vibration and stimulation signal cannot be delivered until You release and press the button again. In this way, your pet could be protected.

**Q: How long should I process my training session for my pet?**

A: Training sessions should be positive and short. It is better to train for about 10-15 minutes each time.

**Q: How to find the best Vibration/Stimulation Level?**

A: It depends on your dog's temperament and threshold for Vibration/Stimulation. Always start at the lowest level and work your way up. You will get the appropriate level when the dog responds to the vibration or stimulation with a mild reaction, such as a tensing of the neck muscles. The vibration or stimulation Level may vary depending on the training situation. When highly distracted, your dog requires a higher level of vibration or stimulation.

# WARRANTY

This product is covered with PETDIARY product and labor warranty for 12 months from the date of its original purchase. You will be given a warranty extension to 12 months if the product is registered on our website ([www.petdiarycollar.net](http://www.petdiarycollar.net)).

Any defective part will be repaired or replaced at no charge if the appliance has not been tampered with and has been used according to these printed directions.

If any problems occur, please contact PETDIARY support team ([support@petdiarycollar.com](mailto:support@petdiarycollar.com)) immediately to launch a warranty claim. Specify model number and your Amazon order number. Our Consumer Service Representative will respond within 1 business day, advise you how to correct the problem yourself, or instruct you on how to return the defective unit back to us for repair or replacement.

We can only provide after sales service for products that are sold by PETDIARY or PETDIARY authorized retailers and distributors. If you have purchased your unit from a different place, please contact your seller for return and warranty issues.

## **FCC Compliance**

This device complies with part 15 of the FCC Rules. Operation is subject to the following two conditions:

(1) This device may not cause harmful interference, and (2) this device must accept any interference received, including interference that may cause undesired operation.

Note: This equipment has been tested and found to comply with the limits for a Class B digital device, pursuant to part 15 of the FCC Rules. These limits are designed to provide reasonable protection

against harmful interference in a residential installation. This equipment generates uses and can radiate radio frequency energy and, if not installed and used in accordance with the instructions, may cause harmful interference to radio communications. However, there is no guarantee that interference will not occur in a particular installation. If this equipment does cause harmful interference to radio or television reception, which can be determined by turning the equipment off and on, the user is encouraged to try to correct the interference by one or more of the following measures:

- Reorient or relocate the receiving antenna.
- Increase the separation between the equipment and receiver.
- Connect the equipment into an outlet on a circuit different from that to which the receiver is connected.
- Consult the dealer or an experienced radio/TV technician for help.
- Caution: Any changes or modifications to this unit not expressly approved by the party responsible for compliance could void the user's authority to operate the equipment.



**PETDIARY**

[www.petdiarycollar.net](http://www.petdiarycollar.net)

## T730

**Manufacturer:** Shenzhen Wellturn Technology Co., Ltd.

**Address:** A603-604, 6/F, Tower A, Donglian Building,  
Chuangye Rd, NO.23 Baoan District, Shenzhen, China.

**Email:** [support@petdiarycollar.com](mailto:support@petdiarycollar.com)

**Website:** [www.petdiarycollar.com](http://www.petdiarycollar.com)

Made in China

