

**frisco**<sup>®</sup>  
by **chewy**



# **Bird Flight Cage Instruction Manual**

Sku# 555286

**FOR BIRD USE ONLY.**

# Assembly Instructions

Please Read Through All Instructions Before Starting

## Read Before Assembly

- Although this cage can be assembled by one person, we recommend enlisting a friend for easier assembly.
- Save all packaging until assembly is completed.
- Recommend to assemble on a clean and even surface.

## Parts Included

Prior to assembly, please be sure to identify and sort all parts shown below.

- |                                  |                                   |                         |                     |
|----------------------------------|-----------------------------------|-------------------------|---------------------|
| 01. Side top-half panel x 2pcs   | 05. Front top-half panel x 1pc    | 09. Bottom panel x 1pc  | 13. Allen Key x 1pc |
| 02. Side bottom-half panel x 1pc | 06. Back top-half panel x 1pc     | 10. Pull-out tray x 1pc | 14. Wrench x 1pc    |
| 03. Side bottom-half panel x 1pc | 07. Front bottom-half panel x 1pc | 11. Storage shelf x 1pc | 15. Screws x 16pcs  |
| 04. Top panel x 1pc              | 08. Back bottom-half panel x 1pc  | 12. Wooden perch x 3pcs | 16. Wheel x 4pcs    |

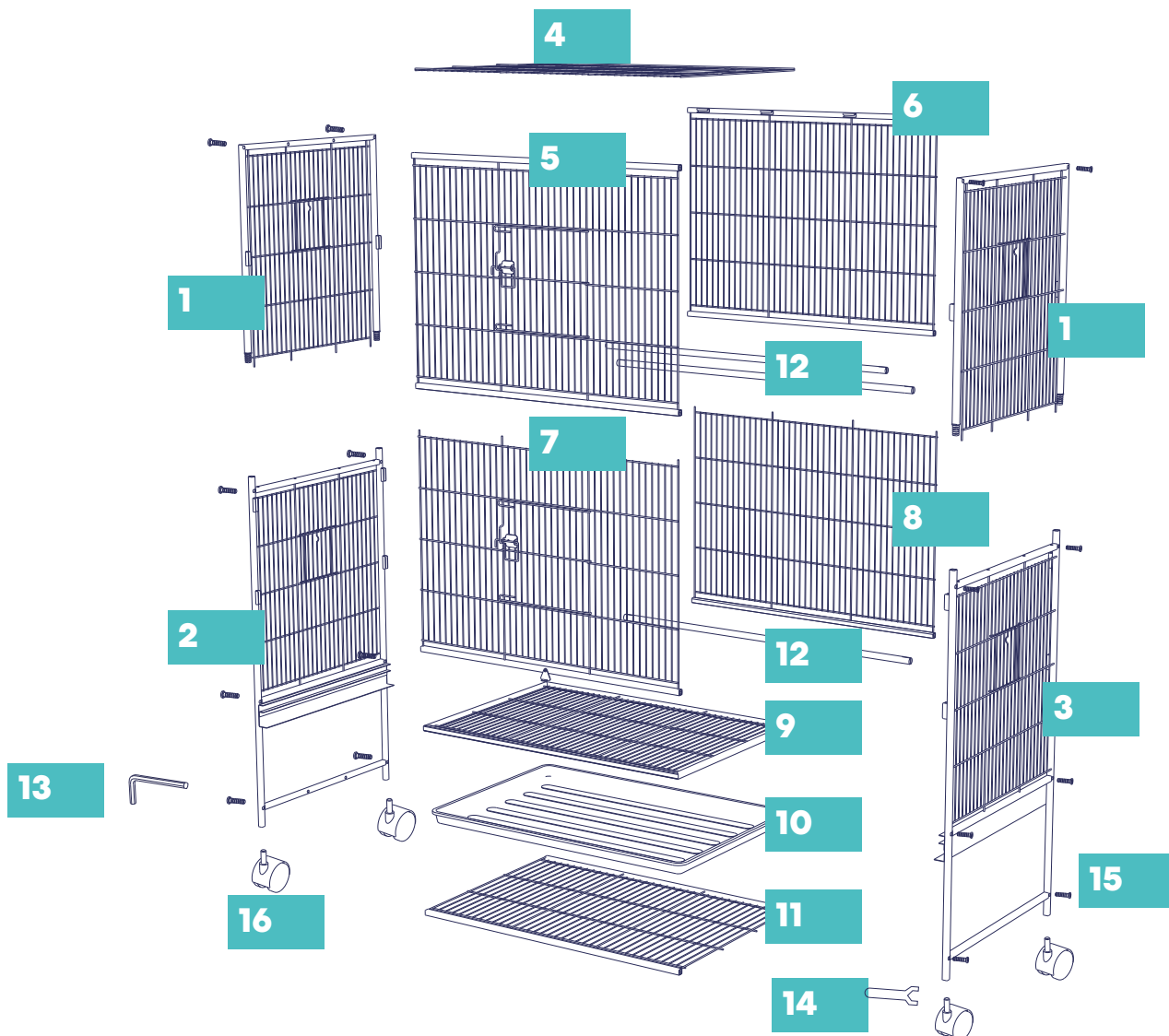

Call 1.800.672.4399 for questions

# Assembly Instructions

Please Read Through All Instructions Before Starting

## Step 1.

Assemble side top panel 1 and side bottom 2, side top 1 and side bottom 3 as shown.

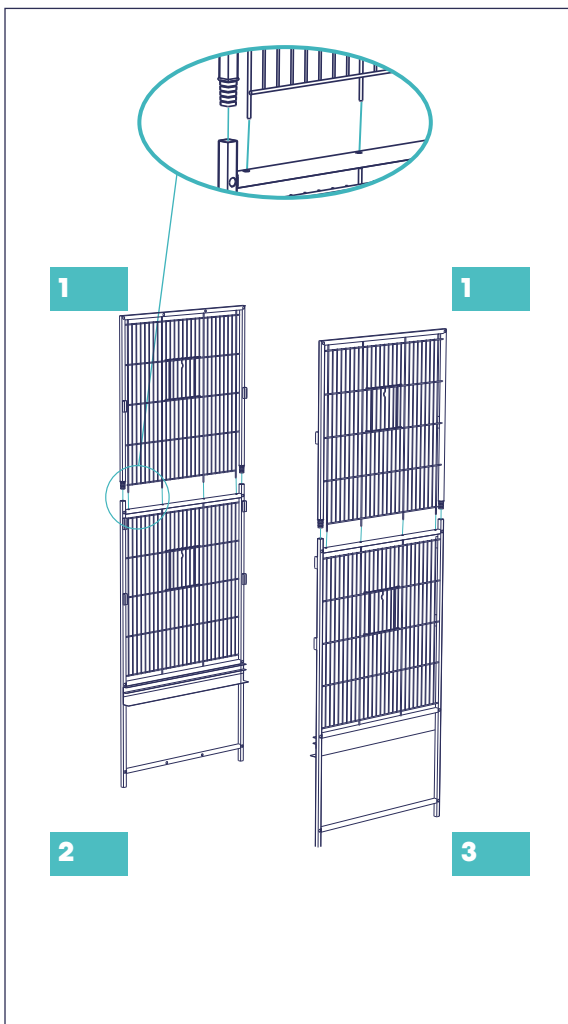

**Note:** Have an assistant holding side panels for best results.

## Step 2.

Use screw to connect panel 2 and panel 7, panel 8.  
Use screw to connect panel 3 and panel 7, panel 8.  
Use screw to connect panels 1 and panel 5, panel 6.  
Use screw to connect panels 1 and roof panel 4.  
Use screw to connect panel 2 and bottom panel 11, panel 3 and bottom panel 11.

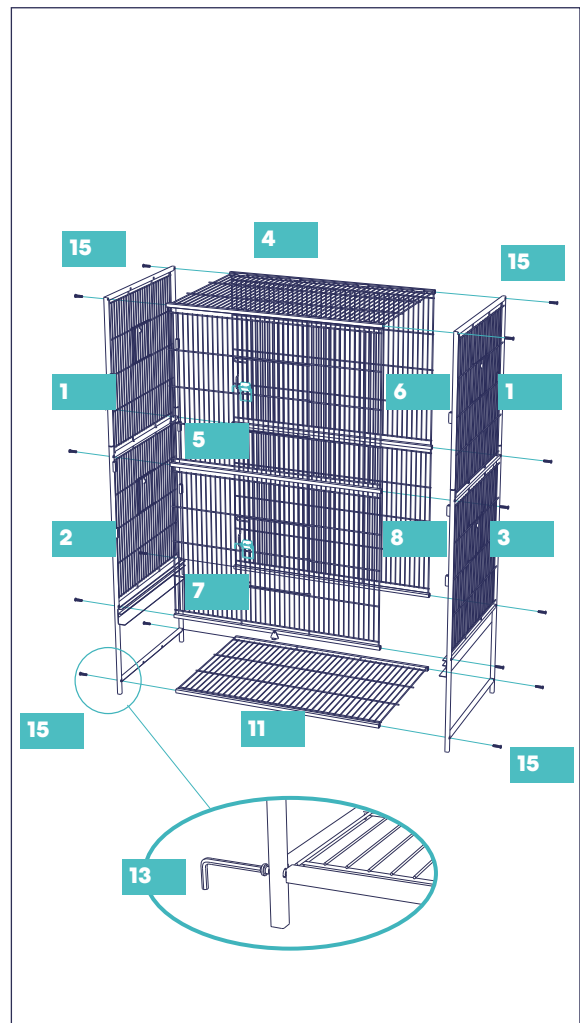

**Note:** Have an assistant holding side panels for best results. Please do not tighten any screws until all panels fit into position at this step.

# Assembly Instructions

Please Read Through All Instructions Before Starting

## Step 3.

Assemble caster wheels B on side bottom panels 2 & 3.

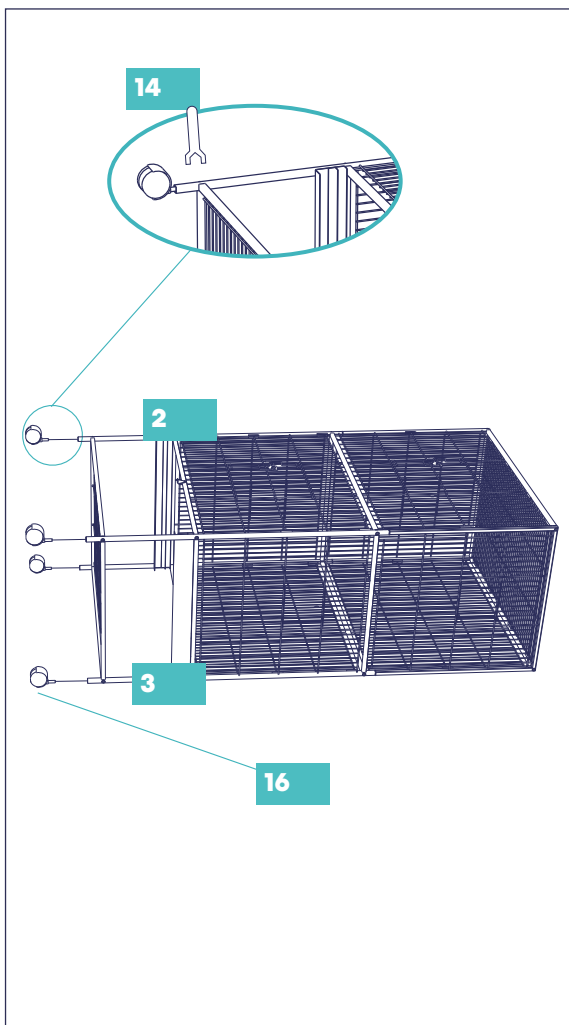

**Note:** For ease of assembly, lay the cage down.

## Step 4.

Slide the bottom panel 9 and plastic tray 10 in place as shown.

Install the windbell lock as shown .

Insert perches around the cage in appropriate places.

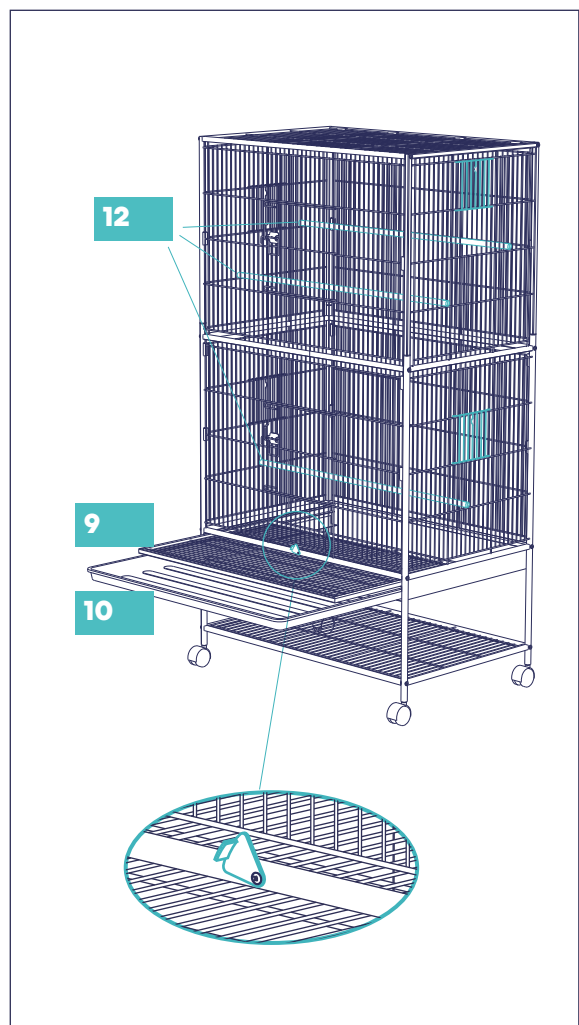

## Warning & Cautions

We care about the safety of your pet, so please READ AND FOLLOW ALL INSTRUCTIONS before using a new cage. Improper use may result in serious injury or even the death of your pet.

- FOR BIRD USE ONLY. NOT FOR USE BY CHILDREN.
- Be sure to choose the proper design for your bird based on vertical and horizontal bars, wire spacing and pet type.
- Give the bird cage a look over periodically and do not use if you see any excessive wear or damage.
- Do not sit on, climb or shake the product.
- While we are dedicated to providing the best for your pet, Chewy, Inc. is not responsible for any loss, damage, discomfort, injury, illness, death or costs of any kind as a result of or by use of this cage.
- Never place your bird cage in direct sunlight or store your house outside or in a car, because the metal can become very hot.
- Assemble according to the directions.
- Take some time to get your pet used to their cage. It will go a long ways to keeping them happy and comfy inside.

## Cleaning & Maintenance

Always select appropriate size and type of product for your specific pet. Be sure to observe your pet's behavior with a new item. Remove and replace the item if it becomes damaged.

Care instructions: Wipe with a damp cloth and mild, pet-safe cleaner. Allow to air dry. Do not expose to direct sunlight for extended periods of time.

## Questions

Questions? Call our friendly customer service anytime. We're here 24/7 at 1.800.672.4399