



Sweet Retreat Pet Bird Carrier Instruction Manual

Sku# 574822

FOR PET USE ONLY

Assembly Instructions

Please Read Through All Instructions Before Starting

Prior to assembling your new bird carrier, we recommend following these instructions step by step.
Make sure all parts are ready before you start assembly.
Identify and locate each of the components listed below.

Parts Included

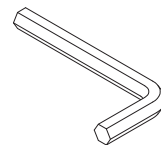
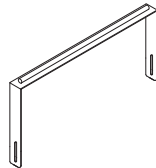
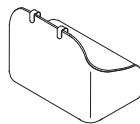
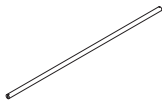
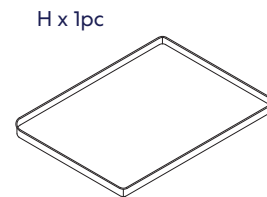
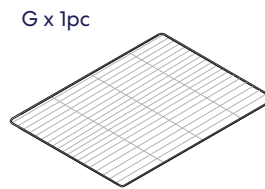
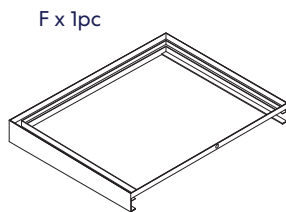
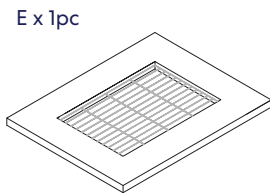
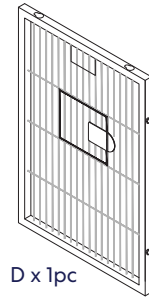
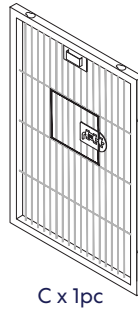
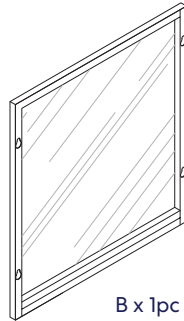
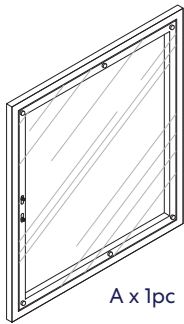

Assembly Instructions

Please Read Through All Instructions Before Starting

Step 1

Gather parts A, B, C, D, and align them accordingly.

Connect the front and side panels together by inserting the preinstalled screws into the holes and pushing down, as shown on Figure A.

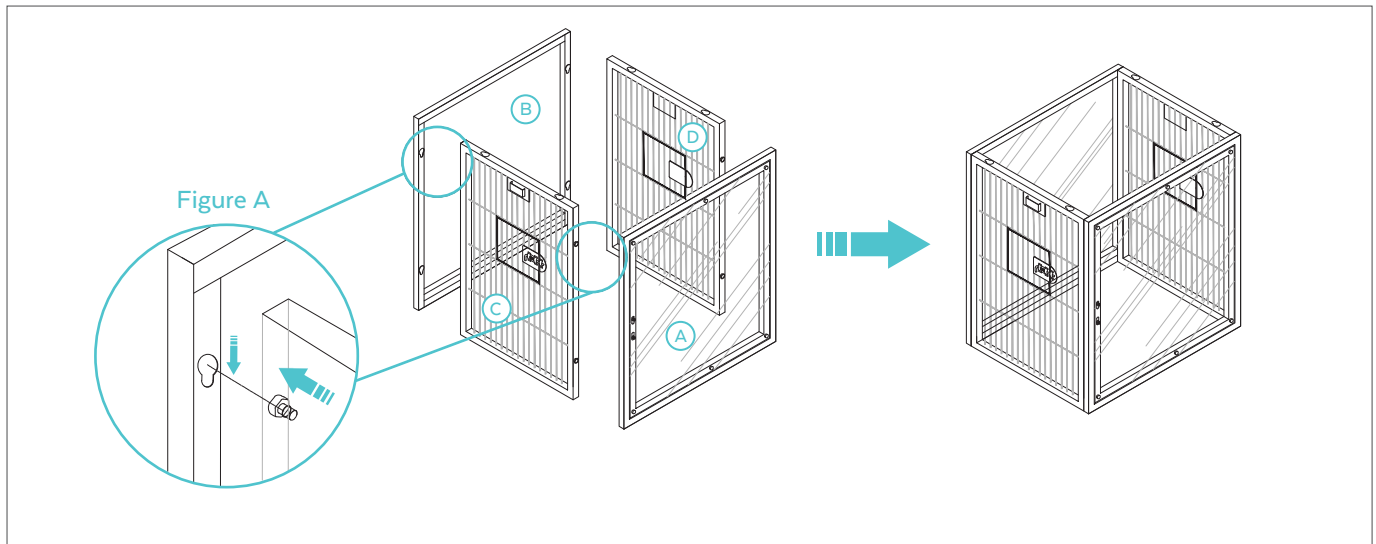

Step 2

Place the structure on top of part (F) and place the wire rack (G) inside the bottom of the cage, as shown below.

Attach part (F) by using the provided screws. Then, attach part (K).

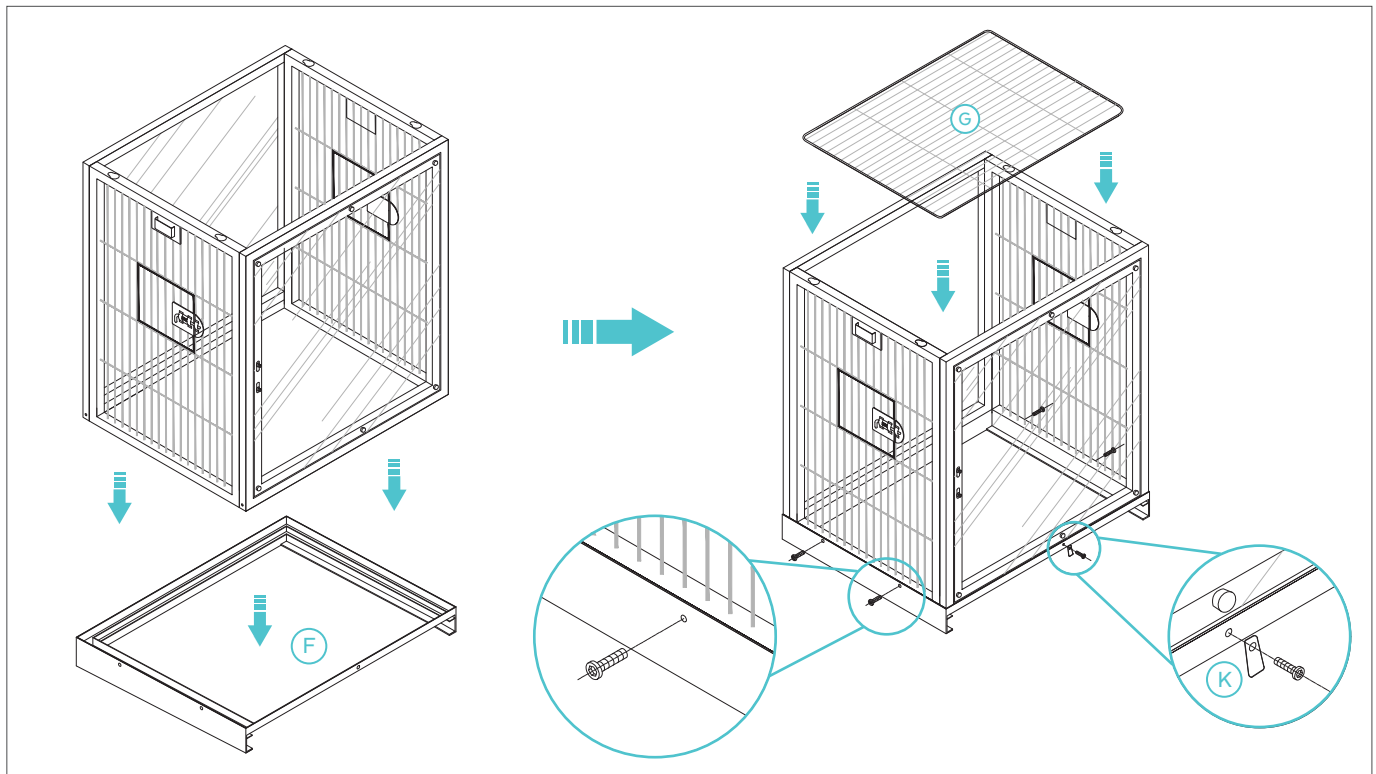

Call 1.800.672.4399 for questions

Assembly Instructions

Please Read Through All Instructions Before Starting

Step 3

Attach parts (I) & (J) as shown below, while making sure the notches lock into place on the sides of the cage.

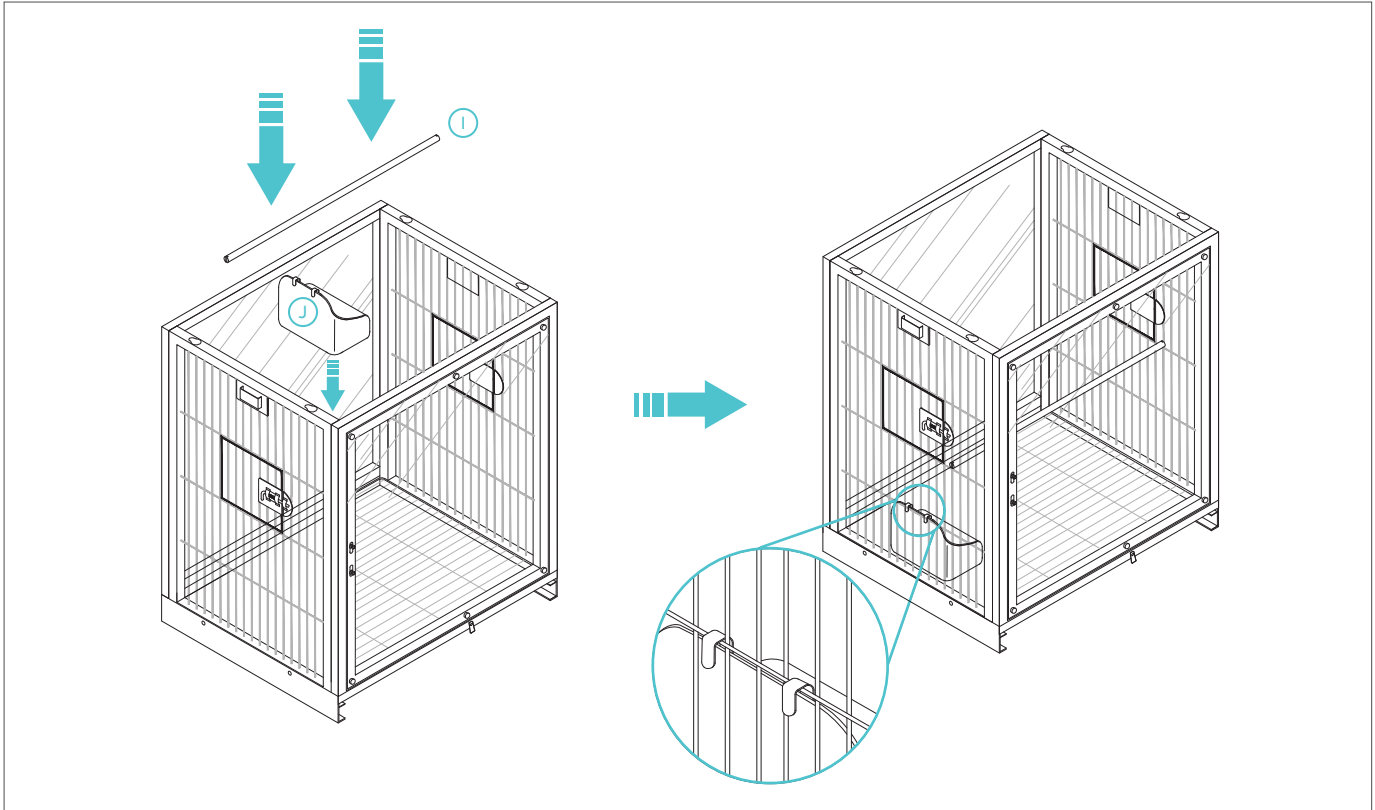

Step 4

Place the lid (E) on top of the cage and interlock with the 4 holes to secure into place.

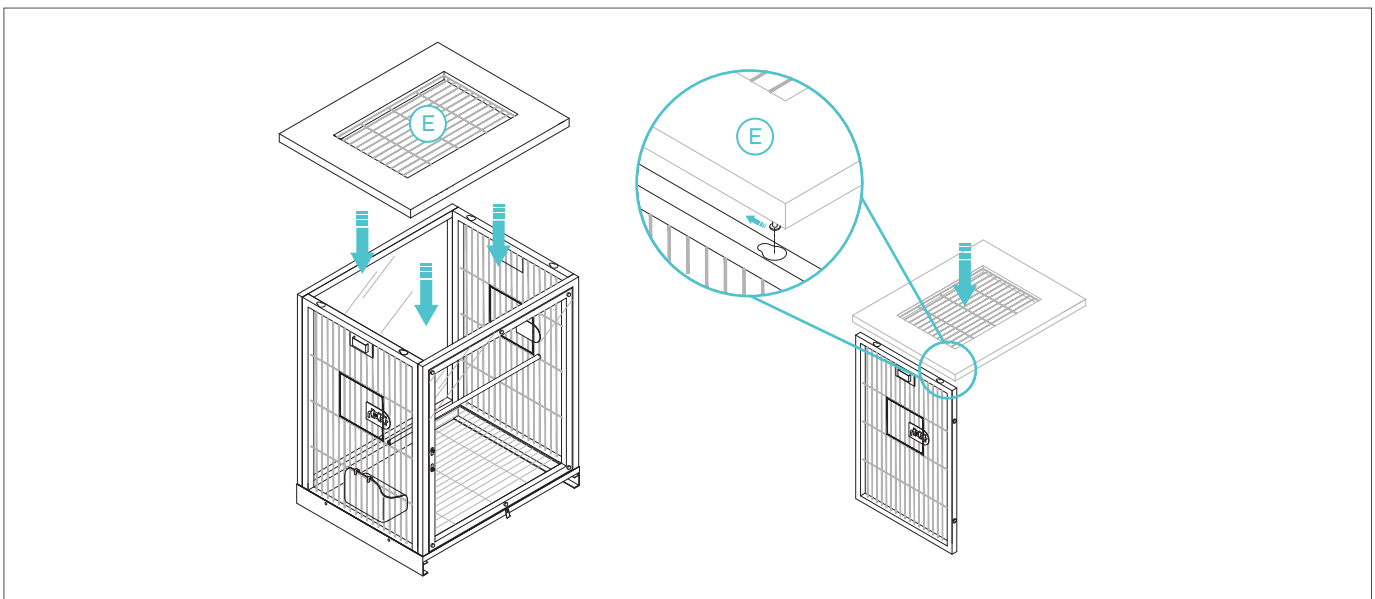

Call 1.800.672.4399 for questions

Assembly Instructions

Please Read Through All Instructions Before Starting

Step 5

Position the handle (L) by pushing it down through the metal pieces on both sides. Then, attach the handle (L) to the cage by fastening the screws into the holes on both sides.

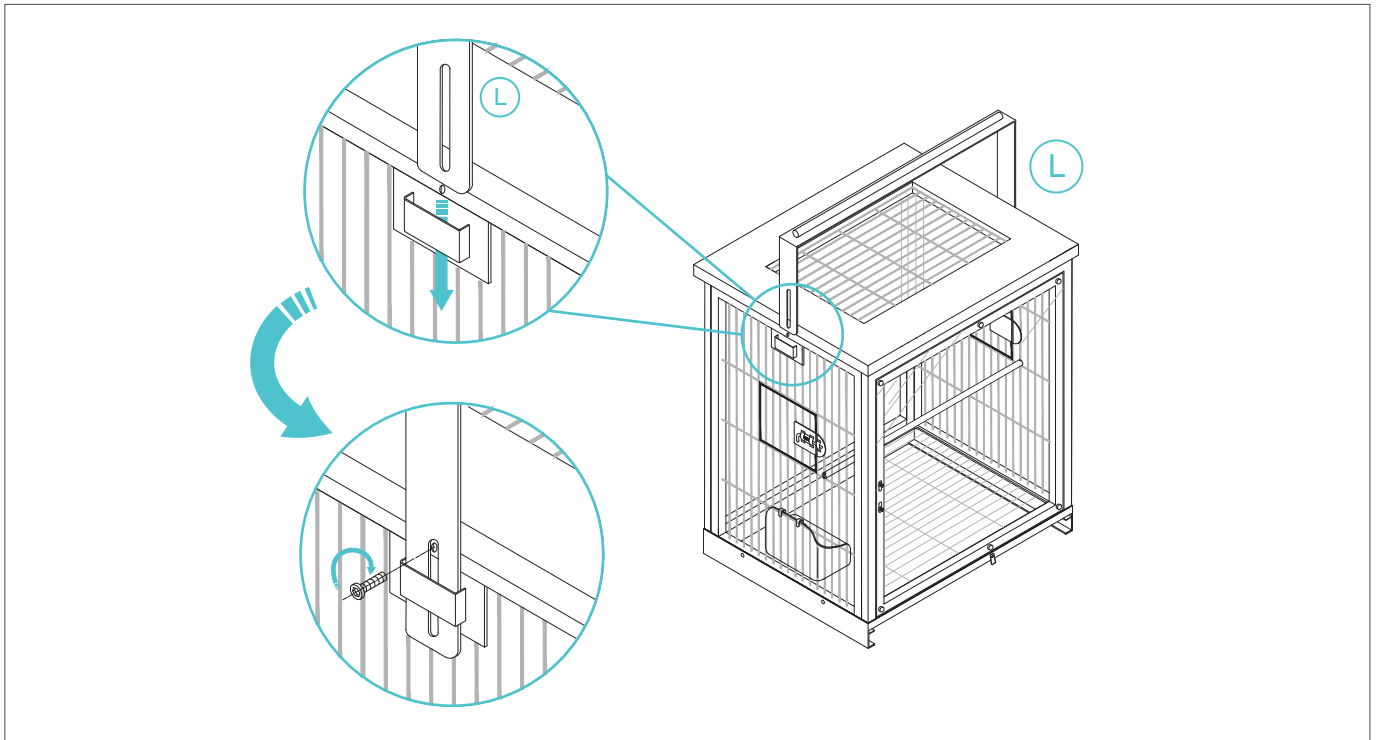

Step 6

Turn part (K) to the side to insert or remove the tray (H). Slide the tray (H) under the cage to complete assembly.

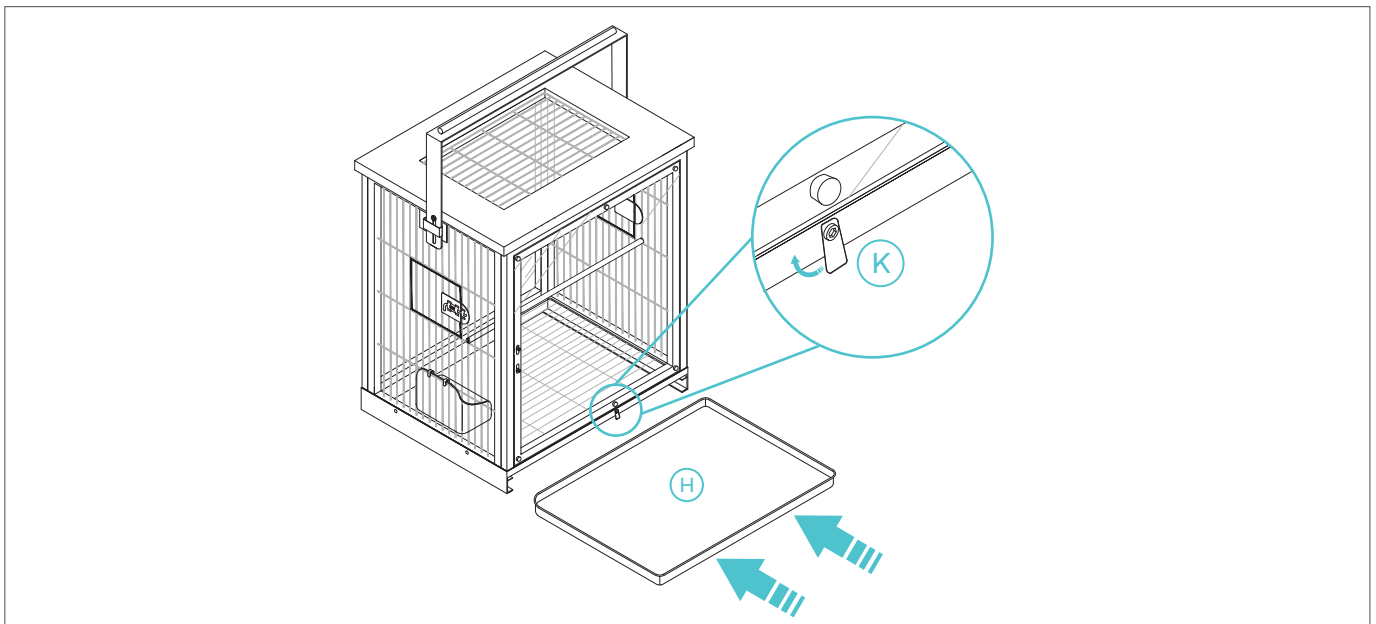

Call 1.800.672.4399 for questions

Assembly Instructions

Please Read Through All Instructions Before Starting

Assembly Complete

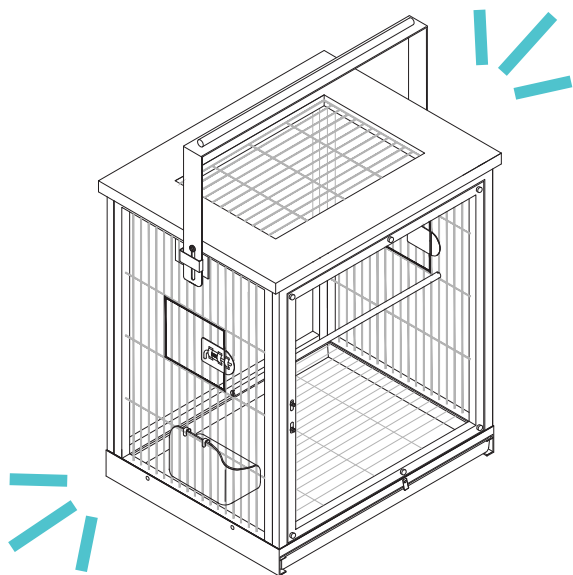

Warnings & Cautions

- For pet bird use only. NOT FOR USE BY CHILDREN.
- Be sure to choose the correct sizing for your bird based on wire spacing, size and bird breed.
- Inspect the product periodically and do not use if it becomes worn or damaged.
- Wipe clean with a damp soft cloth and mild soap. Dry thoroughly. Do not use abrasive cleaners as it may damage the wire coating.
- Assemble according to the directions and do not leave your pet bird in the carrier for an extended period of time without supervision.
- Gradually transition your bird to accept the new habitat.

Questions

Questions? Call our friendly customer service anytime.
We're here 24/7 at 1.800.672.4399