

INSTRUCTION MANUAL OF 360° VIEW KNOCK-DOWN GLASS TERRARIUM

RKF SERIES

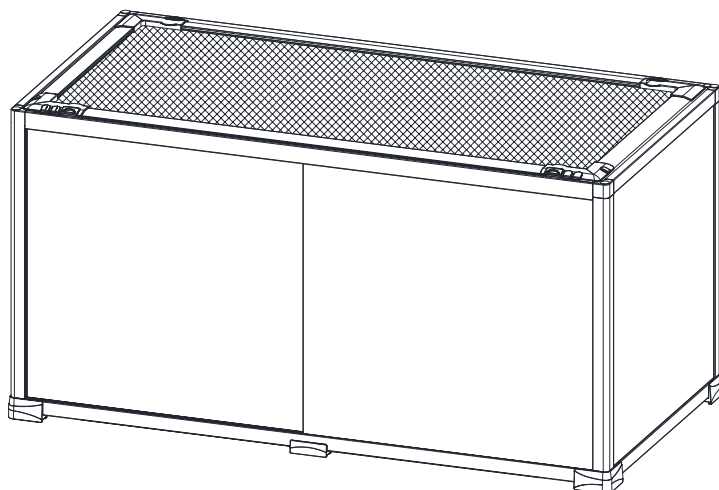

Thank you for choosing our company's products. To use this product properly and ensure its service life, please read this manual carefully before using.

PRODUCT OVERVIEW

Simple and practical knock-down glass terrarium is easy to assemble and disassemble rapidly, convenient for transportation. It is stackable with stackers and so save space. Besides, it can enlarge the size and space by using splicing accessories. It is suitable for gecko, snake, tortoise, hamster and other reptiles.

PRODUCT LIST

- | | | |
|------------------------|-----------------------------|------------------------|
| 1. Top mesh cover: 1pc | 9. Front block glass: 1pc | 17. Suction Cup: 2 pcs |
| 2. Top frame: 1pc | 10. Side glass: 2pcs | |
| 3. Base tray: 1pc | 11. Corner supporting: 4pcs | |
| 4. Metal tube: 4pcs | 12. Middle supporting: 2pcs | |
| 5. Front support: 2pcs | 13. Rubber cap: 4pcs | |
| 6. Back support: 2pcs | 14. Screw: 8pcs | |
| 7. Back glass: 1pc | 15. Screwdriver: 1pc | |
| 8. Front glass: 2pcs | 16. Metal lock: 1pc | |

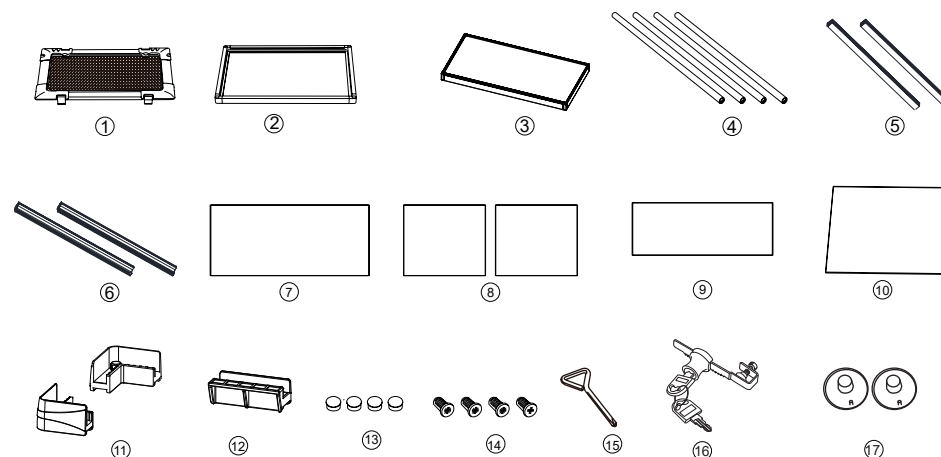

PRODUCT FEATURES

1. Adopt new patent design to be top grade small animal terrarium and reptile terrarium.
2. Practical and convenient terrarium can be disassembled, assembled and delivered easily.
3. Top ventilation mesh cover and equipped with multiple cable holes.
4. It can be used in multiple scenes with relevant accessories to stack and splice between multiple terrariums.
5. Multiple supporting at the bottom makes the terrarium safe, stable and bearing evenly.

INSTALLATION METHOD

1. Install the corner supporting to the four corners of the bottom frame and lock it with screws, then stick the middle supporting with backing.

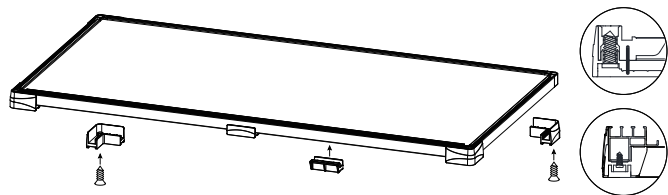

2. Screw the threaded metal tube onto the bottom base and lock as shown below.

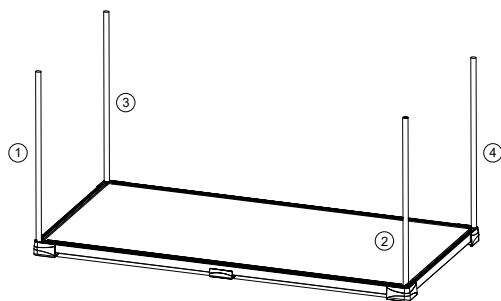

3. Install the support onto the four metal tubes.

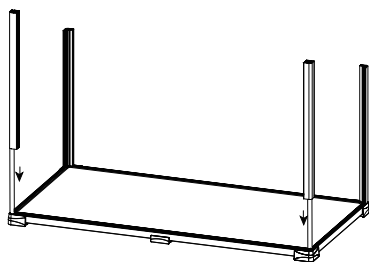

4. Install front block glass, front glass, back glass and side glass.

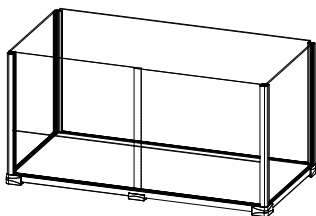

5. Tighten the top frame to the metal tubes with 4 screws.

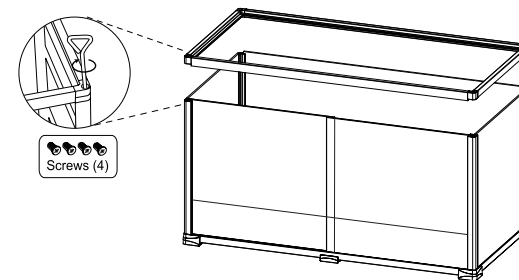

6. Install the top mesh panel with 4 rubber caps on top to cover the screws.

